

**SIGGRAPH '82**



# Program

---

JULY 26-30, 1982 BOSTON

**acm**

# Table of Contents

## ■ SIGGRAPH '82

Introduction	2
SIGGRAPH: The Organization	3
Committee/ Staff	4
Conference at a Glance	8
Special Events	10

## ■ COURSES

Course Information	15
Courses at a Glance	16
Course Schedule	18

## ■ TECHNICAL PROGRAM

Program Information	37
Program Schedule	37

## ■ VENDOR FORUM

Vendor Forum Schedule	50
-----------------------	----

## ■ EXHIBITION

Exhibitor Listing	56
Product Index	133

## ■ FLOOR PLANS

Hynes Auditorium	158
Sheraton - Boston	162
Park Plaza	166
Marriott Long Wharf	168
Copley Plaza	170



# Table of Contents

## ■ GENERAL INFORMATION

Audio/Visual Facilities	173
Child Care	174
Dress	174
First Aid	174
Hotels	175
Housing Assistance	176
Information Center	176
Luggage Check Area	176
Merchandise Sales	176
Message Center	177
Press Briefing	177
Press Room	177
Registration	177
Sight-seeing	178
Telephones	178
Transportation	180

## ■ SIGGRAPH '83

'83 Call for Participation	182
----------------------------	-----

**SIGGRAPH '82**

## Introduction

Welcome to SIGGRAPH '82. The SIGGRAPH '82 Committee has tried to provide you with the biggest and best SIGGRAPH conference yet. I would like to thank each of the Committee members for all their work to make this conference a success and each of their employers for their support of SIGGRAPH '82. Please take a few minutes to read each of the names and affiliations on the following pages.

Subsequent sections of this Program describe the SIGGRAPH '82 Special Events, Courses, Technical Programs, Vendor Forum, and Exhibition in detail. If you have any questions, please feel free to contact any Committee member for assistance.

I hope you enjoy SIGGRAPH '82 and your stay in Boston.

**Elaine L. Sonderegger**  
General Chairman

## SIGGRAPH: The Organization

SIGGRAPH is the Special Interest Group on Computer Graphics of the Association for Computing Machinery (ACM). The 9000 members share an interest in the theory, design, implementation, and application of computer-generated graphics and interactive techniques to facilitate man/machine communication and understanding. There are local SIGGRAPH chapters in Boston, Los Angeles, Philadelphia, Princeton, and Washington, D.C. Annual membership dues include a subscription to "Computer Graphics," the group's newsletter, and are \$10.00 for ACM members and associate members, \$5.00 for ACM student members, \$25.00 for non-ACM members, and \$30.00 for subscriptions. Requests for membership applications should be addressed to:

Association for Computing Machinery  
11 West 42nd Street  
New York, New York 10036  
212 869-7440.

The present SIGGRAPH officers are:

**Thomas DeFanti**, Chairman

**Norman I. Badler**, Vice Chairman

**Maxine D. Brown**, Secretary

**Sara A. Bly**, Treasurer

**James E. George**, Past-Chairman

**Pat Cole**, Director

**Robert A. Ellis**, Director

**Stephen R. Levine**, Director

**Bary W. Pollack**, Editor-in-Chief

## **Committee/Staff**

### **GENERAL CHAIRMAN**

Elaine L. Sonderegger

### **TECHNICAL PROGRAM**

R. Daniel Bergeron

University of New Hampshire

Carl Machover

Machover Associates Corp.

### **COURSES**

Robert H. Ewald

Los Alamos National Laboratory

### **EXHIBITS**

Richard N. Spann

Adage, Inc.

### **TREASURER**

Paul J. Murphy

Lexidata Corporation

### **GRAPHIC DESIGN AND PRINTING**

James C. Ver Hague

Rochester Institute of Technology

### **PR AND ADVERTISING**

M. Clare Moulton

Adage, Inc.

### **LOCAL ARRANGEMENTS**

Alyce Branum

### **VISUAL PRESENTATIONS**

Thomas DeFanti

University of Illinois at Chicago Circle

### **ART SHOW**

Copper Giloith

Real Time Design, Inc.

### **FILM AND VIDEO SHOWS**

Lou Katz

University of California at Berkeley

### **PRELIMINARY PROGRAM**

Chris Herot

Computer Corporation of America

### **FINAL PROGRAM**

James Barood  
Xerox Webster Research Center

### **VENDOR FORUM**

Sherry Keowen  
Vector General

### **USER GROUPS**

John E. French, Jr.  
Exxon Production Research Co.

### **T-SHIRTS**

Susan Hartwig-Hood  
Megatek Corporation

### **STUDENTS**

Paul Painter  
Agency Record Control, Inc.

### **RECORDING SECRETARY**

Marilynn Bever  
Wang Laboratories, Inc.

### **TECHNICAL PROGRAM COMMITTEE**

John Beatty  
University of Waterloo

Ingrid Carlbon  
Schlumberger-Doll Research

James H. Clark  
Stanford University

Donald P. Greenberg  
Cornell University

Lansing Hatfield  
Lawrence Livermore National Laboratory

Bob Hopgood  
Rutherford Appleton Laboratory

James C. Michener  
Intermetrics, Inc.

Bary Pollack  
Vulcan Systems



## **Committee/Staff**

Richard Riesenfeld  
University of Utah

Peter Tanner  
National Research Council of Canada

James J. Thomas  
Battelle Pacific Northwest Laboratory

Turner Whitted  
Bell Laboratories

### **COURSES COMMITTEE**

Maxine Brown  
ISSCO

Michael Dearing  
University of Wisconsin-Madison

Robert Earley  
Los Alamos National Laboratory

Raymond Elliott  
Los Alamos National Laboratory

Bertram Herzog  
Herzog Associates, Inc.

LeVonne Hoerr  
Los Alamos National Laboratory

Virginia Romero  
Los Alamos National Laboratory

James J. Thomas  
Battelle Pacific Northwest Laboratory

### **ART SHOW COMMITTEE**

Louise Etra  
General Electronic Systems, Inc.

Darcy Gerbarg  
New York University

Aaron Marcus  
Lawrence Berkeley Laboratory

## **FILM AND VIDEO COMMITTEE**

Larry Cuba  
Independent Artist

Ken Knowlton  
SRI International

Rodney Stock  
Lucasfilm, Ltd.

Gene Youngblood  
California Institute of the Arts

## **EXHIBITS MANAGEMENT**

Henry T. Cronan  
Robert T. Kenworthy, Inc.

## **CONVENTION SERVICES MANAGEMENT**

Cynthia Stark  
Smith, Bucklin & Associates, Inc.

Joy H. Lee  
Smith, Bucklin & Associates, Inc.

## **PR AND ADVERTISING MANAGEMENT**

Lynn Schultz  
Smith, Bucklin & Associates, Inc.

## **VISUAL PRESENTATIONS MANAGEMENT**

Jane Veeder  
Electronic Visualization Center

Philip Morton  
Electronic Visualization Center

## **AUDIO/VISUAL CONSULTANT**

Jack Coffman  
Coffman, Coffman, Coffman, Inc.

## **ADMINISTRATIVE SUPPORT**

Summagraphics Corporation



## Conference at a Glance

- 24 concurrent one- or two-day courses. Monday and Tuesday.
- State-of-the-art technical sessions. Wednesday through Friday.
- Exhibition of graphics hardware and software by industry vendors. Tuesday through Thursday.

	8AM	9	10	11	12
<b>MONDAY</b>		Courses			
					Lunch
<b>TUESDAY</b>		Courses			
					Lunch
			Exhibition		
<b>WEDNESDAY</b>		Opening Session Technical Program			
					Lunch
			Exhibition		
<b>THURSDAY</b>		Technical Program			
					Lunch
			Exhibition		
<b>FRIDAY</b>		Technical Program			
					Lunch

- In-depth product presentations by vendors. Wednesday through Thursday.
- Major shows of reviewed films. Tuesday and Wednesday evenings.
- Art show of computer-generated works. Monday through Thursday.

	1PM	2	3	4	5	6	7	8
	Courses							
							Reception	
	Courses							
							Film Show	
	Technical Program							
							Film Show	
	Technical Program							
							Reception	
	Technical Program							

## Special Events

### ■ ART SHOW

The SIGGRAPH '82 Art Show is located in the Liberty Suite of the Sheraton-Boston Hotel. This year's exhibition highlights the recent achievements of artists working with computers. Selections include photo enlargements, prints, sculpture, drawings, film, video, and installations. A catalog of the Art Show is available at the exhibition and at the Merchandise Sales desk.

The Art Show is open Monday, July 26, from 10 a.m. to 10 p.m. and Tuesday through Thursday, July 27-29, from 8 a.m. to 8 p.m. Admission is free.

### ■ ATTENDEE SCREENINGS

The Audio/Visual staff will project attendee films and videotapes in the Hynes Auditorium during lunch hour on Wednesday, Thursday, and Friday. The shortest works have priority, so bring your shortest and best to the Audio-Visual staff in the Hynes Auditorium after the morning Technical Sessions.

### ■ BIRDS-OF-A-FEATHER

The Beacon E and Beacon G rooms of the Sheraton-Boston Hotel are available for "birds of a feather" meetings Wednesday, Thursday, and Friday. A sign-up board is provided in the conference registration area at Hynes Auditorium.

### ■ EXHIBITION OPENING CEREMONY

A short ceremony will mark the opening of the seventh annual SIGGRAPH exhibition on Tuesday, July 27 at 10:00 a.m. The ceremony will take place at the first level entrance to the exhibit hall in Hynes Auditorium. Come join the crowd and see it happen - everyone is invited.

### ■ FILM AND VIDEOTAPE SHOWS

Films and videotapes selected by the Film and Video Committee are being shown on

Tuesday and Wednesday evenings. Both showings are at 8:00 p.m. in the Hynes Auditorium, and will utilize the latest in high-intensity video projection, plus 16mm and 35mm film projection.

Tuesday's showing, "Oldies but Goodies," consists of computer graphics from the recent and distant past, and includes material of historical interest, as well as recent material previously seen at SIGGRAPH conferences.

Wednesday's showing, "Latest and Greatest," consists of material produced in the past year. Examples of computer graphics from motion pictures, commercials, computer art and technically-oriented visuals will be shown.

#### ■ **SIGGRAPH EXECUTIVE COMMITTEE MEETING**

The SIGGRAPH Executive Committee meets Thursday from 2:45 p.m. to 6:00 p.m. in the Board Room of the Sheraton-Boston Hotel. All attendees are invited to observe and participate in this meeting of the SIGGRAPH organization.

#### ■ **SOCIAL ACTIVITIES**

A course reception is scheduled on Monday evening, July 26, beginning at 7:30 p.m. at the Sheraton-Boston Hotel. One complimentary ticket is included in the course registration fee. Additional tickets may be purchased at the conference registration area for \$35 each. The course registration fee also includes a luncheon for each course day registered.

A technical program reception will be held on Thursday evening, July 29, beginning at 7:00 p.m. at the Museum of Science. One complimentary ticket is included in the technical program registration fee. Additional tickets may be purchased at the conference registration area for \$40 each.



## Special Events

### ■ USER GROUP MEETINGS

#### **THURSDAY (July 22)**

##### **SDRC GRAPHICS SOFTWARE USER GROUP**

##### **(GENERAL ELECTRIC CAE INTERNATIONAL)**

9:00 a.m. - 5:00 p.m.

Lafite Room, Hotel Meridien

Michelle Ritz, (513) 576-3800

#### **FRIDAY (July 23)**

##### **SDRC GRAPHICS SOFTWARE USER GROUP**

##### **(GENERAL ELECTRIC CAE INTERNATIONAL)**

9:00 a.m. - 5:00 p.m.

Lafite Room, Hotel Meridien

Michelle Ritz, (513) 576-3800

#### **MONDAY (July 26)**

##### **APPLICON USER GROUP**

5:30 p.m. - 1:00 a.m.

Beacon B, Sheraton-Boston

Beverly A. DiChiara, (617) 272-7070

##### **EVANS & SUTHERLAND USER GROUP**

1:00 p.m. - 4:00 p.m.

Beacon C, Sheraton-Boston

Ted Naanes, (801) 582-5847

#### **TUESDAY (July 27)**

##### **AGE (ADAGE GRAPHICS EXCHANGE)**

9:00 a.m. - 5:00 p.m.

Adage, Inc., One Fortune Drive,  
Billerica, MA

Jerry Ornstein, (617) 667-7070

##### **APPLICON USER GROUP**

8:00 a.m. - 12:00 p.m.

Beacon B, Sheraton-Boston

Beverly DiChiara, (617) 272-7070

**VEGUS (VECTOR GENERAL USER GROUP)**

6:00 p.m. - 9:00 p.m.

Embassy Suite, Colonnade Hotel

Sherry Keowen, (213) 346-3410

**WEDNESDAY (July 28)**

**AED USER GROUP (ADVANCED ELECTRONICS DESIGN, INC.)**

9:00 a.m. - 11:00 a.m.

Republic Ballroom, Sheraton-Boston

Robin Ratajczak, (408) 733-3555

**TERAK USER GROUP**

1:00 p.m. - 3:00 p.m.

Commonwealth Room, Sheraton-Boston

Jerry Grady, (602) 998-4800

**UGCS (GRAPHIC COMPATABILITY SYSTEM USER GROUP)**

6:00 p.m. - 9:00 p.m.

Republic Ballroom, Sheraton-Boston

Joseph H. Bristow, (303) 635-5753

**VIM APPLICATIONS AND GRAPHICS PRODUCTS COMMITTEE (CONTROL DATA CORPORATION)**

3:00 p.m. - 5:00 p.m.

Fairfax B, Sheraton-Boston

Peggy Brehm, (602) 231-1502

**THURSDAY (July 29)**

**IKONAS USER GROUP**

9:00 a.m. - 12:00 p.m.

Embassy Suite, Colonnade Hotel

Mary C. Whitton, (801) 848-8701

**MOVIE BYU (BRIGHAM YOUNG UNIVERSITY)**

5:00 p.m. - 7:00 p.m.

Republic Ballroom, Sheraton-Boston

Hank Christiansen, (801) 378-6325

## Courses

## Course Information

The courses are held at several different locations on Monday, July 26, and Tuesday, July 27. The location of each course is given in the program. Shuttle buses will run between the conference hotels and the course locations.

Courses start at 9:00 a.m. on Monday, July 26, and at 8:30 a.m. on Tuesday, July 27. The courses end at 4:30 p.m. on Tuesday to allow a visit to the Exhibition.

Refreshments are served during morning and afternoon breaks in areas adjacent to the course locations.

Luncheons are served each course day in areas near the course locations. Luncheon ticket(s) are included in your registration packet.

Registration to one or more courses admits you to the Exhibition, Vendor Forum, Film and Videotape Shows, and Art Show free of charge.

One set of notes is included in your course registration. Additional sets of course notes can be purchased at the conference registration area in Hynes Auditorium.



## Courses at a Glance

The courses are divided into two categories: tutorials and seminars. A **tutorial (T)** is an introductory level course where a great deal of emphasis is given to the teaching of fundamental principles. A **seminar (S)** is a special topic course, often presented at a more advanced level.

Please refer to the key for course site locations.

COURSES	MON. JULY 26	TUES. JULY 27	SITE
<b>GENERAL COURSES</b>			
1. Introduction to Computer Graphics (T)			1
2. Low-Cost Graphics (T)			4
3. Computer Graphics Hardware (T)			1
4. The Application of Computer Graphics to Engineering, Scientific, & Design Problems (T)			6
5. Introduction to Raster Graphics (T)			1
6. Psychology for User-Computer Interfaces (T)			1
7. How to Design User-Computer Interfaces (T)			1
8. Device-Independent Graphics Software (T)			1
<b>ANIMATION/VISUAL SYNTHESIS</b>			
9. Two-Dimensional Computer Animation (T)			★
10. Advanced Image Synthesis (S)			6
11. Introduction to TV, Film, Video, Printing (S)			1
12. Three-Dimensional Computer Animation (S)			★
13. State-of-the-Art in Image Synthesis (S)			6

## KEY

- ★ Hynes Auditorium
- ① Sheraton-Boston
- ④ Colonnade
- ⑥ Copley Plaza
- ⑦ Boston Park Plaza
- ⑩ Meridien
- ⑪ Marriott Long Wharf

COURSES	MON. JULY 26	TUES. JULY 27	SITE
<b>BUSINESS GRAPHICS</b>			
14. Graphic Design and Information Graphics (S)			⑩
15. Presentation/Publication Quality Graphics (T)			⑦
16. Graphical and Data Bases (T)			⑦
17. Distributed Graphics and Communications (T)			⑦
18. Business Graphics for Managers (S)			⑦
19. Introduction to the SIGGRAPH '82 Exhibition (S)			①
20. Computer Graphics in Office Automation and Electronic Publication (T)			⑦
21. Demographics: Mapping, Marketing, and Computer Graphics (T)			⑦
<b>CAD/CAM</b>			
22. Introduction to CAD (S)			⑪
23. Solid Modelling (S)			⑪
24. Freeform Surfaces (S)			⑪

## Courses

### MONDAY TOPICS

#### ■ **INTRODUCTION TO COMPUTER GRAPHICS (1)**

Sheraton - Grand Ballroom

**CHAIRMAN: Marceli Wein**

National Research Council of Canada

#### **SPEAKERS:**

**Ron Baecker**, Human Computing Resources

**Peter Tanner**, National Research Council of Canada

**Marceli Wein**, National Research Council of Canada

**Alain Fournier**, University of Toronto

#### **TOPICS: Part I of a two-day course**

Introduction & Tutorial Outline/ Baecker

Basic Software/ Tanner

Basic Hardware I/ Wein

Basic Hardware II/ Wein

Raster Hardware/ Tanner

Advanced Software I/ Fournier

#### ■ **LOW-COST GRAPHICS (2)**

Colonnade - Huntington

**CHAIRMAN: Richard L. Phillips**

University of Michigan

#### **SPEAKERS:**

**Richard L. Phillips**, University of Michigan

**H. L. Loats, Jr.**, ECO Systems International, Inc.

**James George**, Los Alamos National Laboratory and Mesa Graphics

**Thomas DeFanti**, University of Illinois at Chicago Circle

#### **TOPICS: Part I of a two-day course**

Computer Graphics Overview/ Phillips

Applications of the Apple II and

Apple III/ Loats

Low-Cost Hardcopy/ George

ZGRASS Graphics on the UV1/ DeFanti

■ **COMPUTER GRAPHICS HARDWARE (3)**

Sheraton - Constitution

**CHAIRMAN: John Staudhammer**

University of Florida

**SPEAKERS:**

**John Staudhammer**, University of Florida

**John Tartar**, University of Alberta

**TOPICS: Part I of a two-day course**

Light, Vision, Colorimetry and CRT

Devices/ Staudhammer

Architecture, Video Buffering, Image

Storage/ Tartar

Raster Systems/ Staudhammer

Input/ Output Devices/ Tartar

■ **THE APPLICATION OF COMPUTER GRAPHICS TO ENGINEERING, SCIENTIFIC, AND DESIGN PROBLEMS (4)**

Copley - Oval

**CO-CHAIRMEN:**

**Robert Ellis**, Boeing Computer Services

**David Kasik**, Boeing Computer Services

**SPEAKERS:**

**Robert Ellis**, Boeing Computer Services

**David Kasik**, Boeing Computer Services

**Del Coates**, Del Coates Associates

**Richard J. Littlefield**, Battelle Pacific

Northwest Laboratory

**TOPICS: Part I of a two-day course**

Introduction/ Ellis, Kasik

Overview of Computer Graphics/ Ellis

Computer Graphics and Engineering

(Analysis, Information Presentation, and

General Support)/ Ellis

Computer Graphics and Engineering

(CAD/CAM)/ Kasik

Computer Graphics and Industrial Design/

Coates

## Courses

### ■ **INTRODUCTION TO RASTER GRAPHICS (5)**

Sheraton - Independence

**CHAIRMAN: Donald Greenberg**

Cornell University

#### **SPEAKERS:**

**Donald Greenberg**, Cornell University

**Ted Crane**, Cornell University

**Roy A. Hall**, Cornell University

**Gary W. Meyer**, Cornell University

**John C. Dill**, Cornell University

#### **TOPICS:**

Introduction/ Greenberg

Raster Concepts/ Crane, Hall

Frame Buffer Architecture/ Crane, Hall

Raster Performance Issues/ Meyer

Low Level Graphics/ Dill

Raster Algorithms/ Greenberg

Color and Color Spaces/ Greenberg

Illumination Models and Reflections/  
Greenberg

Anti-aliasing/ Hall, Meyer

Applications/ Dill

### ■ **PSYCHOLOGY FOR USER-COMPUTER INTERFACES (6)**

Sheraton - Republic

**CHAIRMAN: Jack Grimes**

ITT

#### **SPEAKERS:**

**Jack Grimes**, ITT

**H. Rudy Ramsey**, ITT

#### **TOPICS:**

Introduction/ Grimes

Brief History of Human Factors/ Ramsey

Requirements Analysis, Part I/ Grimes

Requirements Analysis, Part II/ Ramsey

Functional Design/ Ramsey

Dialogue Design, Part I/ Grimes

Dialogue Design, Part II/ Ramsey

Workstation Design/ Grimes

Questions and Answers/ Grimes, Ramsey



■ **TWO-DIMENSIONAL COMPUTER ANIMATION (9)**

Hynes - Room 200

**CHAIRMAN: Marc Levoy**

Cornell University and Hanna-Barbera Productions

**SPEAKERS:**

**Marc Levoy**, Cornell University and Hanna-Barbera Productions

**Alvy R. Smith**, Lucasfilm Ltd.

**Chris Odgers**, Cornell University and Hanna-Barbera Productions

**Edwin Catmull**, Lucasfilm Ltd.

**Duane Palyka**, New York Institute of Technology

**Bruce Wallace**, Cornell University and Hanna-Barbera Productions

**Rodney Stock**, Lucasfilm Ltd.

**TOPICS:**

General Introduction/ Levoy

Painting Programs/ Smith

Color Palette Generation/ Smith

Introduction to Video/ Odgers

Video Scanning Hardware/ Odgers

Scan and Paint Systems/ Levoy

Automatic Inbetweening/ Catmull

Artist/User Considerations/ Palyka

Image Transformation and Merging/ Wallace

Image Transformation Hardware/ Stock

Video Recording Hardware/ Odgers

Film Recording Hardware/ Catmull

Panel Discussion/ Staff

■ **ADVANCED IMAGE SYNTHESIS (10)**

Copley - Ballroom

**CHAIRMAN: J. Turner Whitted**

Bell Laboratories

**SPEAKERS:**

**J. Turner Whitted**, Bell Laboratories

**Henry Fuchs**, University of North Carolina

**Frank Crow**, Ohio State University

**Nelson Max**, Lawrence Livermore National Laboratory

## Courses

### TOPICS:

Overview/ Whitted  
Rendering Part I/ Fuchs  
Rendering Part II/ Whitted  
Anti-aliasing/ Crow  
Image Synthesis on Supercomputers/ Max

### ■ INTRODUCTION TO TV, FILM, VIDEO, PRINTING (11)

Sheraton - Commonwealth

#### CHAIRMAN: Stephen R. Levine

Electronic Graphics Associates

#### SPEAKERS:

**Stephen R. Levine**, Electronic Graphics Associates

**Faber Birren**, Author, Color Consultant, and Lecturer

**Robert Kushner**, K Graphics

**John Blunden**, Lawrence Livermore National Laboratory

**Bruce E. Brown**, Software Development Computer Assisted Engineering

### TOPICS:

Human Vision/ Levine  
A Videotape, "Graphic Harmony"/ Polaroid Corporation  
Color and Human Response/ Birren  
Ink on Paper—The Printing Process/ Kushner  
The Technology of Film/ Blunden  
The Technology of Video/ Brown  
Special Visual Effects/ Demonstration/ Levine

### ■ GRAPHIC DESIGN AND INFORMATION GRAPHICS (14)

Meridien - Salon Margaux

#### CHAIRMAN: Aaron Marcus

Lawrence Berkeley Laboratory

#### SPEAKER:

**Aaron Marcus**, Lawrence Berkeley Laboratory

**TOPICS: Part I of a two-day course**

Introduction/ Marcus

Elementary Principles/ Marcus

Proportion and Composition/ Marcus

Letterforms and Symbols/ Marcus

■ **PRESENTATION/PUBLICATION  
QUALITY GRAPHICS (15)**

Park Plaza - Plaza Room

**CHAIRMAN: Joel Orr**

Orr Associates, Inc.

**SPEAKERS:**

**Joel Orr**, Orr Associates, Inc.

**Anders Vinberg**, ISSCO

**Steven King**, Scitex America Corporation

**Diane Julian**, Xerox Corporation

**Larry Martin**, Dicomed

**TOPICS:**

Integrating Visual Information with Textual  
Information/ Orr

Layout Intelligence/ Vinberg

Producing Publication-Quality Color Graphics  
from your Data Base/ King

Electronic Publishing/ Julian

Film Systems/ Martin

■ **DISTRIBUTED GRAPHICS AND  
COMMUNICATIONS (17)**

Park Plaza - Imperial Room

**CHAIRMAN: Griffith Hamlin**

Los Alamos National Laboratory

**SPEAKERS:**

**Griffith Hamlin**, Los Alamos National  
Laboratory

**Andries van Dam**, Brown University

**Robert M. Dunn**, R. M. Dunn Associates

**David Nelson**, Apollo Computer Inc.

**David Cheriton**, Stanford University

**William Pford**, Bell Laboratories



## Courses

### TOPICS:

Overview/ Hamlin  
Dynamic Distribution of Programs for Satellite Graphics Systems/ van Dam  
Partitioning Graphics Functions/ Dunn  
Communications for Local Networks and the Architecture of the Apollo Domain Network/ Nelson  
High Level Graphics Protocols in the Stanford Network Graphics Project/ Cheriton  
Distributed Graphics for the Bell System/ Pferd  
Summary/ Hamlin

### ■ **DEMOGRAPHICS: MAPPING, MARKETING, AND COMPUTER GRAPHICS (21)**

Park Plaza - Georgian

**CHAIRMAN: Robert T. Aangeenbrug**  
University of Kansas

### SPEAKERS:

**Robert T. Aangeenbrug**, University of Kansas

**George F. McCleary**, University of Kansas

**Waldo R. Tobler**, University of California-Santa Barbara

### TOPICS:

Introduction and Review of Computer Mapping/ Aangeenbrug  
Benefits and Justification/ Aangeenbrug  
Case Study/ Staff  
The Practice of Mapping and Cartography - Map Design/ McCleary  
Case Study/ Staff  
The Practice of Mapping and Cartography - Hardware/Software/ Tobler  
Geometry and Mapping/ Tobler  
Case Study/ Staff  
Geographic Information Systems/ Aangeenbrug  
Problem Areas, Review and Questions/ Aangeenbrug, McCleary, Tobler

■ **INTRODUCTION TO COMPUTER-AIDED DESIGN (22)**

Marriott - Ballroom, Salon E

**CHAIRMAN: Bertram Herzog**

Herzog Associates, Inc.

**SPEAKERS:**

**Bertram Herzog**, Herzog Associates, Inc.

**Robert Heilman**, Ramtek, Inc.

**David Weisberg**, Auto-trol Corporation

**S. H. Chasen**, Lockheed Georgia Company

**Patrick Hanratty**, MCS

**R. Lee Whitney**, CADAM, Inc.

**Stephen Weiner**, Computervision Corporation

**Howard W. Fisher**, Intergraph Corporation

**Charles F. Raber**, Gerber Systems

Technology, Inc.

**Jerry W. Adams**, McAuto Corporation

**R. M. McElhaney**, GRAFTEK

**Charlotte Hudgin**, A. M. Bruning

**John Trefz**, Sigma Design Incorporated

**Brian Woolsey**, Phoenix Automation, Inc.

**J. Farkas**, Bodine Corporation

**Howard Shrobe**, MIT

**Michael H. Liewald**, Boeing Commercial

Airplane Company

**Richard M. Mueller**, Control Data

Corporation

**Herbert B. Voelcker**, University of Rochester

**Richard F. Riesenfeld**, University of Utah

**R. M. Dunn**, R. M. Dunn Associates, Inc.

**TOPICS: Part I of a two-day course**

Introduction/ Herzog

The Functional Elements of a CAD System/  
Heilman

Developments in Display Technology for  
CAD/ Weisberg

How to Justify a CAD System/ Chasen

Vendor Talks I

MCS/ Hanratty, CADAM/ Whitney

Computervision/ Young, Auto-trol/ Weisberg

Vendor Talks II

Intergraph/ Fisher

Panel Discussion/ Staff

## Courses

- **SOLID MODELLING (23)**  
Marriott - Ballroom, Salon H

### **CO-CHAIRMEN:**

**Herbert Voelcker**, University of Rochester

**Aristides A. G. Requicha**, University of Rochester

### **SPEAKERS:**

**Aristides Requicha**, University of Rochester

**Herbert Voelcker**, University of Rochester

**Robert Tilove**, General Motors Research Laboratories

**Malcolm Sabin**, CAD Centre, UK

**George Allen**, McDonnell Douglas Automation

**Michael Wesley**, IBM T. J. Watson Research Center

### **TOPICS:**

Fundamentals I: Representations and Systems/ Requicha

Fundamentals II: Algorithms and Applications/ Voelcker

Representations and Algorithms for Unsculptured Objects/ Tilove, Sabin

User Interfaces/ Allen

New Construction Techniques and Applications for Solid Models/ Wesley

Discussion/ Staff

## **TUESDAY TOPICS**

### ■ **INTRODUCTION TO COMPUTER GRAPHICS (1)**

Sheraton - Grand Ballroom

**CHAIRMAN: Marcell Wein**

National Research Council of Canada

#### **SPEAKERS:**

**Ron Baecker**, Human Computing Resources

**Peter Tanner**, National Research Council of Canada

**Marcell Wein**, National Research Council of Canada

**Alain Fournier**, University of Toronto

#### **TOPICS: Part II of a two-day course**

Advanced Software II/ Fournier

Graphics Input and Interaction Techniques I/ Baecker

Graphics Input and Interaction Techniques II/ Baecker

Software Packages and Graphic Standards/ Wein

Dynamics/ Tanner

Color and Color Perception/ Fournier

SIGGRAPH '82 Preview/ Tanner

### ■ **LOW-COST GRAPHICS (2)**

Colonnade - Huntington

**CHAIRMAN: Richard L. Phillips**

University of Michigan

#### **SPEAKERS:**

**Richard L. Phillips**, University of Michigan

**H. L. Loats, Jr.**, ECO Systems International, Inc.

**James George**, Los Alamos National Laboratory and Mesa Graphics

**Thomas DeFanti**, University of Illinois at Chicago Circle

#### **TOPICS: Part II of a two-day course**

Graphical Input/ Phillips

Interactive Graphics/ Phillips

Low-Cost Workstations/ Phillips

Graphics on the IBM Personal Computer

## Courses

### ■ **COMPUTER GRAPHICS HARDWARE (3)**

Sheraton - Constitution

**CHAIRMAN:** John Staudhammer

University of Florida

**SPEAKERS:**

**John Staudhammer**, University of Florida

**John Tartar**, University of Alberta

**TOPICS: Part II of a two-day course**

Graphics Systems I/ Tartar

Graphics Systems II/ Tartar

High Resolution Displays/ Staudhammer

Recording and Photography/ Staudhammer

### ■ **THE APPLICATION OF COMPUTER GRAPHICS TO ENGINEERING, SCIENTIFIC, AND DESIGN PROBLEMS (4)**

Copley - Oval

**CO-CHAIRMEN:**

**Robert Ellis**, Boeing Computer Services

**David Kasik**, Boeing Computer Services

**SPEAKERS:**

**Robert Ellis**, Boeing Computer Services

**David Kasik**, Boeing Computer Services

**Del Coates**, Del Coates Associates

**Richard J. Littlefield**, Battelle Pacific

Northwest Laboratory

**TOPICS: Part II of a two-day course**

Computer Graphics in Scientific Research/  
Littlefield

Guide to SIGGRAPH '82 Conference and  
Exhibition/ Ellis, Kasik

Tour Exhibition

### ■ **HOW TO DESIGN USER-COMPUTER INTERFACES (7)**

Sheraton - Republic

**CHAIRMAN:** James Foley

The George Washington University

**SPEAKERS:**

**James Foley**, The George Washington University

**TOPICS:**

Introduction, Design Methodology/ Foley  
Guidelines for Designers/ Foley  
Software Implementation Tools/ Foley

■ **DEVICE-INDEPENDENT GRAPHICS SOFTWARE (8)**

Sheraton - Independence

**CHAIRMAN: Theodore N. Reed**

Los Alamos National Laboratory

**SPEAKERS:**

**Theodore N. Reed**, Los Alamos National Laboratory

**James R. Warner**, Precision Visuals, Incorporated

**Peter R. Bono**, Athena Systems, Incorporated

**TOPICS:**

Introduction to Morning Session/ Reed  
Principles of Device-Independent Graphics Software/ Warner  
Architecture of Device-Independent Graphics Systems/ Reed  
Introduction to Afternoon Session/ Reed  
Taxonomy of Graphics Software with Extensive Examples of Typical Output/ Bono  
Evaluation Criteria for Software Selection/ Bono  
Evaluation Criteria Applied to Commercially Available Software Packages/ Bono  
Evaluation Criteria Applied to Public Domain Software Packages/ Reed  
Methodology and Recommended Approach/ Bono

## Courses

### ■ **THREE-DIMENSIONAL COMPUTER ANIMATION (12)**

Hynes - Room 200

**CHAIRMAN: Bill Kovacs**

Robert Abel and Associates

**SPEAKERS:**

**Bill Kovacs**, Robert Abel and Associates

**Norman Badler**, The University of Pennsylvania

**David Zeltzer**, Ohio State University

**Lance Williams**, New York Institute of Technology

**Craig Reynolds**, Information International, Inc.

**TOPICS:**

Introduction/ Kovacs

Model Driven Animation/ Badler

3-D Movement Simulation/ Zeltzer

Interactive Motion Design/ Kovacs

3-D Animation at New York Institute of Technology/ Williams

Animation Scripting at Information International, Inc./ Reynolds

### ■ **STATE-OF-THE-ART IN IMAGE SYNTHESIS (13)**

Copley - Ballroom

**CHAIRMAN: Edwin Catmull**

Lucasfilm Ltd.

**SPEAKERS:**

**Edwin Catmull**, Lucasfilm Ltd.

**James Blinn**, Jet Propulsion Laboratory

**Robert Cook**, Lucasfilm Ltd.

**Loren Carpenter**, Lucasfilm Ltd.



**TOPICS:**

Introduction/ Catmull  
3-D Transformation of Raster Image—  
Standards for Image Quality/ Catmull  
Advanced Simulation for Science and Space  
Computer Animation/ Blinn  
Shading Model in Realistic Image Synthesis/  
Cook  
Stochastic Modelling in a Case Study and  
Image Synthesis/ Carpenter  
Film

■ **GRAPHIC DESIGN AND INFORMATION  
GRAPHICS (14)**

Meridien - Salon Margaux

**CHAIRMAN: Aaron Marcus**

Lawrence Berkeley Laboratory

**SPEAKER:**

**Aaron Marcus**, Lawrence Berkeley  
Laboratory

**TOPICS: Part II of a two-day course**

Color/ Marcus  
Charts and Graphs/ Marcus  
Maps/ Marcus  
Diagrams/ Marcus

■ **GRAPHICAL DATA BASES (16)**

Park Plaza - Imperial Room

**CHAIRMAN: Doug Neal**

Decision Resources

**SPEAKERS:**

**Douglas B. Neal**, Decision Resources  
**Terence Kuch**, Decision Resources



## Courses

### TOPICS:

Integration of Computer Graphics and Information Management/ Neal, Kuch  
Historically, Separate Development of Computer Graphics and Data Bases/ Neal, Kuch  
Graphics Presentation of Information to Top Management/ Neal, Kuch  
Graphics-Assisted Interrogation of Information by Analysts/ Neal, Kuch  
Information Resource Management and Graphics/ Neal, Kuch  
Expeditious Retrieval of Information/ Neal, Kuch  
Benefits of Graphics-Data Base Linkage/ Neal, Kuch  
Trade-offs and Information Strategies/ Neal, Kuch  
Case Studies/ Neal, Kuch  
Recently Introduced DBMS-Graphic Linkage Systems/ Neal, Kuch

### ■ **BUSINESS GRAPHICS FOR MANAGERS (18)**

Park Plaza - Georgian

### **CHAIRMAN: James E. George**

Los Alamos National Laboratory and Mesa Graphics

### **SPEAKERS:**

**James E. George**, Los Alamos National Laboratory and Mesa Graphics

**Alan Paller**, AUI Data Graphics

**Norma Frye**, Digital Equipment Corporation

**Jack Gottlieb**, Business and Professional Software

**Bary Pollack**, Vulcan Systems

### **TOPICS:**

Organization and Introduction to Business Graphics/ George  
Justifying Computer Graphics/ Paller  
Artists and Computer Graphics: How to Manage Both!/ Frye  
Business Graphics on Personal Computers/ Gottlieb, George  
Local Networks and Computer Graphics/ Pollack  
Business Graphics Technology Update/ Paller

■ **INTRODUCTION TO THE SIGGRAPH  
'82 EXHIBITION (19)**

Sheraton - Commonwealth

**CHAIRMAN: Stephen R. Levine**

Electronic Graphics Associates

**SPEAKERS:**

**Stephen R. Levine**, Electronic Graphics Associates

**Bruce E. Brown**, Software Development  
Computer Assisted Engineering

**TOPICS:**

Introduction/ Levine

Application Stories/ Levine

Introduction and Overview of Graphics

Hardware/ Brown

Introduction and Survey of Software

Packages/ Brown

Software, Systems and Standards/ Brown

High Performance Graphics Hardware/ Levine

■ **COMPUTER GRAPHICS IN OFFICE  
AUTOMATION AND ELECTRONIC  
PUBLICATION (20)**

Park Plaza - Plaza Room

**CHAIRMAN: Michael P. Barnett**

Brooklyn College

**SPEAKERS:**

**Michael P. Barnett**, Brooklyn College

**Robert Thunelius**, Resource Dynamic, Inc.

**Robert S. Varga**, Xybion Corp.

**Roger S. Tobie**, ICC GraphCom System, Inc.

**TOPICS:**

Workshop Overview/ Barnett

Computer Graphics as an Office Design

Tool/ Thunelius

Graphic Displays in an Integrated Office/

Varga

Interactive System to Typeset Pictures and

Text/ Tobie

## Courses

### ■ INTRODUCTION TO COMPUTER-AIDED DESIGN (22)

Marriott - Ballroom, Salon E

#### **CHAIRMAN: Bertram Herzog**

Herzog Associates, Inc.

#### **SPEAKERS:**

**Bertram Herzog**, Herzog Associates, Inc.

**Robert Heilman**, Ramtek, Inc.

**David Weisberg**, Auto-trol Corporation

**S. H. Chasen**, Lockheed Georgia Company

**Patrick Hanratty**, MCS

**R. Lee Whitney**, CADAM, Inc.

**Stephen Weiner**, Computervision Corporation

**Howard W. Fisher**, Intergraph Corporation

**Charles F. Raber**, Gerber Systems  
Technology, Inc.

**Jerry W. Adams**, McAuto Corporation

**R. M. McElhaney**, GRAFTEK

**Charlotte Hudgin**, A. M. Bruning

**John Trefz**, Sigma Design Incorporated

**Brian Woolsey**, Phoenix Automation, Inc.

**J. Farkas**, Bodine Corporation

**Howard Shrobe**, MIT

**Michael H. Liewald**, Boeing Commercial  
Airplane Company

**Richard M. Mueller**, Control Data  
Corporation

**Herbert B. Voelcker**, University of Rochester

**Richard F. Riesenfeld**, University of Utah

**R. M. Dunn**, R. M. Dunn Associates, Inc.

#### **TOPICS: Part II of a two-day course**

Vendor Talks III

Gerber/ Raber, McAuto/Adams,  
GRAFTEK/ McElhaney

Vendor Talks IV

Bruning/ Hudgin, Sigma Design/ Trefz  
Phoenix/ Woolsey, Bodine/ Farkas

VLSI: How to Make a Big Chip in a Week/  
Shrobe

Interconnections and IGES/ Liewald

Integrated CAD/CAM Approach/ Mueller

Developments in Solid Modelling/ Voelcker

Developments in Sculptured Surface Repre-  
sentations/ Riesenfeld

A Look Into the Future/ Dunn

Panel Discussion/ Staff

■ **FREEFORM SURFACES (24)**

Marriott - Ballroom, Salon H

**CHAIRMAN:** Richard F. Riesenfeld,  
University of Utah

**SPEAKERS:**

**Richard F. Riesenfeld**, University of Utah

**William J. Gordon**, Drexel University

**Elaine Cohen**, University of Utah

**Jeffrey M. Lane**, Calma/ GE

**A. Robin Forrest**, University of East Anglia,  
UK

**TOPICS:**

Introduction/ Riesenfeld

Introduction to Computer-Aided Geometric  
Design/ Riesenfeld

Using Projectors To Construct Surfaces/  
Gordon

Subdivision Methods for Curves and  
Surfaces/ Cohen

Display Techniques for Curves and Surfaces/  
Lane

User Aspects for Freeform Surface Design/  
Forrest

Comments/ Riesenfeld

# Technical Program



The SIGGRAPH '82 technical program is held on Wednesday, July 28, through Friday, July 30.

The technical program is composed of 37 presentations in eleven paper sessions plus eleven panels including the Presidents' Forum. Each time slot in the program is allocated to two concurrent sessions — a panel and a paper session.

All eleven paper sessions are held in the Hynes Auditorium and all eleven panel sessions are held in the Sheraton-Boston Grand Ballroom.

Refreshments are served during morning and afternoon breaks in areas adjacent to the sessions.

Each technical program attendee receives one copy of the SIGGRAPH '82 proceedings plus a supplement containing papers selected for publication in the ACM Transactions on Graphics. Each technical program attendee also is admitted to the Exhibition, Vendor Forum, Film and Videotape Shows, and Art Show free of charge.

## **WEDNESDAY TOPICS**

9:00-10:00

### **OPENING SESSION**

Hynes Auditorium

### **SIGGRAPH '82 WELCOME**

Elaine Sonderegger

### **SIGGRAPH REPORT**

Thomas DeFanti

### **COURSES SUMMARY**

Robert H. Ewald

### **TECHNICAL PROGRAM PREVIEW**

R. Daniel Bergeron, Carl Machover

### **SIGGRAPH AWARDS PROGRAM**

Pat Cole



## Technical Program

10:15-12:00

### **IMAGE GENERATION**

Hynes Auditorium

#### **CHAIRMAN:**

**James H. Clark**, Stanford University

Clamping: A Method of Anti-Aliasing Textured Surfaces by Bandwidth Limiting in Object Space

Alan Norton, IBM Thomas J. Watson Research Center, Alyn P. Rockwood and Philip T. Skolmoski, Evans and Sutherland Computer Corporation

A More Flexible Image Generation Environment

F.C. Crow, Ohio State University

Anti-Aliasing Through the Use of Coordinate Transformations

Kenneth Turkowski, CADLINC, Inc.

Light Reflection Functions for Simulation of Clouds and Dusty Surfaces

James F. Blinn, Jet Propulsion Laboratory

10:15-12:00

### **PANEL:**

#### **The Impact of Graphic Standards**

Sheraton-Boston Grand Ballroom

#### **CHAIRMAN:**

**David Straayer**, Tektronix, Inc.

This panel will discuss the recent progress towards ANSI standards for functional graphics and CAD data transfer. Primary emphasis will be placed on the impact of these standards upon the user.

#### **PANELISTS:**

**Tom Wright**, ISSCO Graphics

**David Shuey**, McAuto Corporation

**Bruce Cohen**, Intel Corporation

**Bradford M. Smith**, National Bureau of Standards

**Theodore N. Reed**, Los Alamos National Laboratory

1:30-3:00

**EUROGRAPHICS SESSION:  
Graphic Standards**

Hynes Auditorium

**CHAIRMAN:**

**Robert Hopgood**, Rutherford Appleton  
Laboratory

The Detailed Semantics of Graphics Input  
Devices

David S. H. Rosenthal, Edinburgh University

James C. Michener, Intermetrics, Inc.

Gunther Pfaff, Technische Hogeschool  
Darmstadt

Rens Kessener, Technische Hogeschool  
Eindhoven

and Malcolm Sabin, FEG, Limited

A Metafile for Efficient Sequential and  
Random Display of Graphics

Theodore N. Reed, Los Alamos National  
Laboratory

Graphics Standardization

Paul ten Hagen, Mathematisch Centrum,  
Amsterdam

Graphic Standards for Three-Dimensional  
Modelling

Malcom Sabin, FEG, Limited

1:30-3:00

**PANEL:  
Professional Workstations**

Sheraton-Boston Grand Ballroom

**CHAIRMAN:**

**Andries van Dam**, Brown University

The panel will examine the evolution of the professional workstation from a time-shared terminal to a powerful graphics-based personal computer connected to a resource-sharing local network. The panelists will speculate on the future evolution of both the hardware/software architecture and end-user environment.

## Technical Program

### PANELISTS:

**James H. Clark**, Stanford University

**Robert M. Dunn**, R.M. Dunn Associates

**Harvey Kriloff**, Boeing Computer Services

**David Nelson**, Apollo Computer, Inc.

3:15-4:45

### MODELLING

Hynes Auditorium

### CHAIRMAN:

**Donald Greenberg**, Cornell University

An Inversion Algorithm for Geometric Models  
**Martti Mantyla**, Helsinki University of  
Technology

Generation and Display of Geometric Fractals in  
3-D

**Alan Norton**, IBM Thomas J. Watson Research  
Center

A New Triangulation Method for Planar  
Contours

**S. Ganapathy and T. G. Dennehy**, University of  
Michigan

Creating Volume Models from Edge-Vertex  
Graphs

**Patrick M. Hanrahan**, University of Wisconsin

3:15-4:45

### PRESIDENTS' FORUM

Sheraton-Boston Grand Ballroom

### CHAIRMAN:

**Carl Machover**, Machover Associates

Presidents of four leading computer graphics  
companies, representing hardware, software  
and systems products, will discuss problems  
and opportunities which confront the rapidly  
growing computer industry.

### PANELISTS:

**Donald Feddersen**, Applicon Corporation

**Ralph T. Linsalata**, Lexidata Corporation

**Peter Preuss**, ISSCO Graphics

**Richard N. Spann**, Adage, Inc.

## **THURSDAY TOPICS**

9:00-10:30

### **USER INTERFACE**

Hynes Auditorium

#### **CHAIRMAN:**

**James J. Thomas**, Battelle Pacific  
Northwest Laboratory

Flair-User Interface Dialog Design Tool  
Peter C.S. Wong and Eric R. Reid, TRW  
Defense Systems Group

A User Interface Management System  
David Kasik, Boeing Computer Services

The Device Model of Interaction  
Ed Anson, Northeastern University

Star Graphics: An Object-Oriented Implementation  
Daniel E. Lipkie, Steven R. Evans,  
John K. Newlin, and Robert L. Weissman,  
Xerox Corporation

9:00-10:30

#### **PANEL:**

### **The Graphics CAD/CAM Industry: Financial Perspectives**

Sheraton-Boston Grand Ballroom

#### **CHAIRMAN:**

**Richard N. Spann**, Adage, Inc.

Companies supplying graphics CAD/CAM components and systems form an important high technology business segment. Panelists representing four financial perspectives will discuss market entry, financing, segment performance and shareholder expectations. Development of the graphics CAD/CAM industry in the 80's will be a unifying theme.

#### **PANELISTS:**

**Frederick R. Adler**, Adler & Co.

**Thomas P. Kurlak**, Merrill Lynch

**Joseph C. McNay**, Essex Investment  
Management Co.

**Margaret A. Reichenbach**, L. F. Rothschild,  
Unterberg, Towbin

## Technical Program

10:45-12:00

### **HARDWARE ARCHITECTURE**

Hynes Auditorium

#### **CHAIRMAN:**

**Turner Whitted**, Bell Laboratories

The Geometry Engine: A VLSI Geometry System for Graphics

James H. Clark, Stanford University

A Contour Display Generation Algorithm for VLSI Implementation

Michael J. Zyda, Washington University

A Rectangular Area Filling Display System Architecture

Daniel S. Whelan, California Institute of Technology

10:45-12:00

### **PANEL:**

#### **Approaches to Solid Modelling**

Sheraton-Boston Grand Ballroom

#### **CHAIRMAN:**

**Leon Malin**, MAGI

Solid modelling systems in current use are based on approaches that are fundamentally different. The panelists will discuss the advantages and disadvantages of the different approaches, especially from the user's point of view.

#### **PANELISTS:**

**Frank Bliss**, Ford Motor Company

**William Carmody**, IBM Corporation

**Robert Johnson**, Consultant

**Martin Schloessel**, Applicon, Inc.

**John Swarbrick**, General Electric Company

1:30-2:30

**VISIBLE SURFACE ALGORITHMS**

Hynes Auditorium

**CHAIRMAN:**

**Kellogg Booth**, University of Waterloo

Path Specification and Path Coherence,  
Kim L. Shelley and Donald Greenberg,  
Cornell University

Special Purpose Automatic Programming for  
Hidden Surface Elimination  
Chris Goad, Stanford University

1:30-2:30

**PANEL:**

**Voice Recognition as an Input Technique**

Sheraton-Boston Grand Ballroom

**CHAIRMAN:**

**Richard Rabin**, Verbex Div., Exxon

Voice input offers a major potential for improving the productivity of users of computer graphics systems. Panelists will discuss applications in CAD/CAM and other interactive graphics systems. Experiences in developing, installing and operating such systems will be described.

**PANELISTS:**

**Matthew Peterson**, Computervision

**Sue Schedler**, G.E./Calma

**Mark Robillard**, Sanders Associates

**Alan R. Strass**, General Electric Company



## Technical Program

### 2:45-3:45 **DATA BASE APPLICATIONS**

Hynes Auditorium

#### **CHAIRMAN:**

**Bary Pollack**, Vulcan Systems

Context-Sensitive, Graphic Presentation of Information

Mark Friedell, Jane Barnett and David Kramlich, Computer Corporation of America

Graphical Tools for Interactive Image Interpretation

David M. McKeown, Jr. and Jerry L. Denlinger, Carnegie-Mellon University

MAPQUERY: Data Base Query Language for Retrieval of Geometric Data and its Graphical Representation

Andre Frank, Swiss Federal Institute of Technology

### 2:45-3:45 **PANEL: The Challenge of CAD/CAM Education**

Sheraton-Boston Grand Ballroom

#### **CHAIRMAN:**

**Michel A. Melkanoff**, UCLA

Since few universities have experience teaching CAD/CAM, they have difficulty meeting industry needs for graduates trained in the use or implementation of CAD/CAM systems. This panel attempts to outline the problems in developing more extensive CAD/CAM emphasis in education and the role the university can or should play in addressing industry needs in this area.

#### **PANELISTS:**

**Donald Greenberg**, Cornell University

**Victor Langer**, Milwaukee Area Technical College

**Frank Puhl**, CADAM, Inc.

**Mark S. Shepard**, RPI

**Herbert Voelcker**, University of Rochester

4:00-5:00

**APPLICATIONS**

Hynes Auditorium

**CHAIRMAN:**

**Ingrid Carlbom**, Schlumberger-Doll Research

3D Galatea: Entry of Three-Dimensional Moving Points from Multiple Perspective Views  
Steven A. MacKay, Richard E. Sayre, and Michael J. Potel, University of Chicago

A Morphological Study of the Form of Nature  
Yoichiro Kawaguchi, Nippon Electronics College

An Interactive Graphics Environment for Architectural Energy Simulation  
Jon H. Pittman and Donald P. Greenberg, Cornell University

4:00-5:00

**PANEL:**

**Graphic Input Interaction Techniques**

Sheraton-Boston Grand Ballroom

**CHAIRMAN:**

**James J. Thomas**, Battelle Pacific Northwest Laboratory

The techniques for communicating with graphics systems including interaction and effective presentation techniques are becoming active research subjects. The SIGGRAPH sponsored workshop on graphic input interaction techniques (June 1982) will be summarized and reviewed.

**PANELISTS:**

To be selected after the Graphic Input Interaction Techniques Workshop.

# Technical Program

## FRIDAY TOPICS

9:00-10:30

### **CURVED SURFACE DISPLAY**

Hynes Auditorium

#### **CHAIRMAN:**

**Richard Riesenfeld**, University of Utah

Ray Tracing Parametric Patches  
James T. Kajiya, California Institute of  
Technology

An Algorithm and Data Structure for 3D Object  
Synthesis Using Surface Patch Intersections  
Wayne E. Carlson, The Ohio State University

Scanline Rendering of Parametric Surfaces  
Dino Schweitzer and Elizabeth S. Cobb,  
University of Utah

A Generalization of Algebraic Surface Drawing  
James F. Blinn, Jet Propulsion Laboratory

9:00-10:30

#### **PANEL:**

### **Business Graphics: What is it?**

Sheraton-Boston Grand Ballroom

#### **CHAIRMAN:**

**David Luther**, Lexidata Corporation

What really is business graphics? Is it narrowly  
confined to making slides or does it encompass  
the full range of information transfer? The  
panel will present the views of hardware and  
software vendors and users.

#### **PANELISTS:**

**Irwin Jarett**, Irwin Jarett, CPA, Ltd.

**Howard Johnson**, Digital Equipment  
Corporation

**Jack Russell**, General Motors Corporation

**John Thompson**, Precision Visuals, Inc.

10:45-12:00

**PAINT AND ANIMATION**

Hynes Auditorium

**CHAIRMAN:**

**Peter Tanner**, National Research Council of Canada

The Message is the Medium: Multiprocess Structuring of an Interactive Paint Program  
Richard J. Beach, John C. Beatty, Kellogg S. Booth, and Darlene A. Plebon, University of Waterloo, Eugene L. Fiume, University of Toronto

Computer Animation with Scripts and Actors  
Craig W. Reynolds, Information International Inc.

Color Image Quantization for Frame Buffer Display  
Paul S. Heckbert, New York Institute of Technology

10:45-12:00

**PANEL:**

**The Role of Videotex**

Sheraton-Boston Grand Ballroom

**CHAIRMAN:**

**Frank Tompa**, University of Waterloo

Interactive Videotex systems may soon emerge as a principal information, entertainment, and communications medium relying heavily on computer graphics. The purpose of this session is to introduce Videotex literature and research to mainstream graphics audiences. Topics include a brief outline of Videotex developments, current architecture, business experiences, alternatives to Videotex and future expectations for Videotex.

**PANELISTS:**

**Brian Botten**, Extel Computing, Ltd.

**David Godfrey**, University of Victoria

**John Norton**, Norpak, Ltd.

**Lois Schneider**, CBS

**Andries van Dam**, Brown University

## Technical Program

1:30-2:45

### **RASTER SYSTEMS**

Hynes Auditorium

#### **CHAIRMAN:**

**James C. Michener**, Intermetrics, Inc.

A Language for Bitmap Manipulation

Leo J. Guibas, Xerox PARC, and Jorge Stolfi,  
Stanford University

A Device Independent Graphics Imaging

Model for Use with Raster Devices

John Warnock and Douglas K. Wyatt,  
Xerox PARC

A Conceptual Model of Raster Graphics  
Systems

James Acquah, James Foley, John Sibert, and  
Patricia Wenner, The George Washington  
University

1:30-2:45

### **PANEL:**

#### **Health & Safety Issues in Computer Graphics**

Sheraton-Boston Grand Ballroom

#### **CHAIRMAN:**

**Wordie Parr**, NIOSH

The increasing use of computer graphics as a production tool requires increased investigation into the possible health and safety effects of prolonged use of CRT devices and other related equipment. This panel will address some of the recent results that have been obtained in this area and will attempt to identify areas that require more study.

#### **PANELISTS:**

**William H. Cushman**, Eastman Kodak Co.

**David Sliney**, US Army Environmental  
Hygiene Agency

**W. M. Zuk**, Health and Welfare Canada

**R. C. Peterson**, Bell Laboratories



## Vendor Forum



## Vendor Forum

### WEDNESDAY TOPICS

#### ■ **BUSINESS GRAPHICS** Beacon A, Sheraton-Boston

- |             |  |
|-------------|--|
| 9:00-9:30   | <b>John Thompson</b><br>Precision Visuals, Inc.      |
| 9:30-10:00  | <b>John Theys</b><br>Data-Type, Inc.                 |
| 10:30-11:30 | <b>Ian Hirschsohn</b><br>Superset, Inc.              |
| 1:30-2:00   | <b>Dick Godfrey</b><br>IBM                           |
| 2:00-2:30   | <b>Mickael Jern</b><br>European Software Contractors |
| 2:30-3:00   | <b>Randall Wise</b><br>Graphic Communications, Inc.  |
| 3:00-4:00   | <b>Go Sugiura</b><br>Amdek Corporation               |

#### ■ **HARDWARE TRENDS** Beacon D, Sheraton-Boston

- |             |   |
|-------------|---|
| 9:00-9:30   | <b>Dave Nims</b><br>MacDonald Dettwiler & Associates      |
| 9:30-10:00  | <b>Jim Callan</b><br>Evans & Sutherland                   |
| 10:00-10:30 | <b>Don Wedding</b><br>Photonics Technology, Inc.          |
| 10:30-11:00 | <b>John Lugsdin</b><br>Orcatech, Inc.                     |
| 11:00-12:00 | <b>Michael Kaplan</b><br>Grinnell Systems Corporation     |
| 1:30-2:00   | <b>James L. Lawrence</b><br>Analog Technology Corporation |

- 2:00-2:30 **George G. Elsaesser**  
Precision/Echo
- 2:30-3:00 **Jerrold Gundersen**  
General Electric Co.
- 3:00-3:30 **Dick Immekus**  
Digital Engineering, Inc.
- 3:30-4:30 **George Dahlke**  
Log Etronics Inc.

■ **FUTURE APPLICATIONS**  
**Beacon F, Sheraton-Boston**

- 9:30-10:00 **Michael H. Rehmus**  
Datacopy Corporation
- 10:00-10:30 **John E. Trombly**  
Octek, Inc.
- 10:30-11:00 **Zsuza Molnar, Frank Dietrich**  
Data Max
- 11:00-11:30 **Charles Nordby**  
Gould - DeAnza Imaging & Graphics
- 11:30-12:00 **John Moreland**  
Megatek Corporation
- 1:00-1:30 **Gil Russell**  
Advanced Electronics Design, Inc.
- 1:30-2:00 **Michael H. Rehmus**  
Datacopy Corporation
- 2:00-3:00 **Jim Dunn, Rick Pendergrass**  
LogEtronics Inc.
- 3:00-3:30 **Dan Fern**  
Photonics Technology, Inc.
- 3:30-4:30 **Andy Rubel**  
Rubel Software

## Vendor Forum

### ■ **CAD/CAM** Beacon H, Sheraton-Boston

- |             |  |
|-------------|--|
| 10:00-10:30 | <b>Phil Marshall</b><br>Imlac Corporation                    |
| 10:30-11:00 | <b>Ernie Blood</b><br>Polhemus Navigation Sciences, Inc.     |
| 11:00-11:30 | <b>Geoffrey Scott</b><br>Precision Visuals, Inc.             |
| 12:30-1:00  | <b>Stanley Klein</b><br>Technology & Business Communications |
| 1:00-1:30   | <b>Lee Ambrosini</b><br>Selanar Corporation                  |
| 1:30-2:00   | <b>Jerry Kennedy</b><br>Advanced Electronics Design, Inc.    |
| 2:00-2:30   | <b>Overview of CAD/CAM Industry</b><br>The Anderson Report   |
| 2:30-3:00   | <b>Craig Rasmussen</b><br>Evans & Sutherland                 |

### **THURSDAY TOPICS**

### ■ **BUSINESS GRAPHICS** Beacon A, Sheraton-Boston

- |             |  |
|-------------|--|
| 9:00-9:30   | <b>John Thompson</b><br>Precision Visuals, Inc.              |
| 9:30-10:00  | <b>John Theys</b><br>Data-Type, Inc.                         |
| 10:00-10:30 | <b>Mickael Jern</b><br>European Software Contractors         |
| 10:30-11:30 | <b>Ian Hirschsohn</b><br>Superset, Inc.                      |
| 12:30-1:00  | <b>Stanley Klein</b><br>Technology & Business Communications |

- 1:00-1:30     **Lee Ambrosini**  
Selanar Corporation
- 1:30-2:00     **Elliott Bouillion**  
Phoenix Computer Graphics
- 2:00-2:30     **Randall Wise**  
Graphic Communications, Inc.
- 2:30-3:00     **David Robinson**  
ISSCO Graphics
- 3:00-4:00     **John Farina**  
LogEtronics Inc..
- 4:00-4:30     **Dick Godfrey**  
IBM

■     **HARDWARE TRENDS**  
**Beacon D, Sheraton-Boston**

- 9:30-10:00     **Jim Callan**  
Evans & Sutherland
- 10:00-11:00     **Thomas Moxon**  
Grinnell Systems Corporation
- 11:00-11:30     **Charles Nordby**  
Gould - DeAnza Imaging & Graphics
- 1:30-2:00     **James L. Lawrence**  
Analog Technology Corporation
- 2:00-3:00     **Ned Thanhouser**  
Tektronix, Inc.
- 3:00-3:30     **Don Wedding**  
Photonics
- 3:30-4:00     **Jerrold P. Gundersen**  
General Electric Co.

## Vendor Forum

### ■ FUTURE APPLICATIONS Beacon F, Sheraton-Boston

- 9:30-10:00 **Michael H. Rehmus**  
Datacopy Corporation
- 10:00-10:30 **Dan Fern**  
Photonics Technology, Inc.
- 10:30-11:00 **Zsuzsa Molnar, Frank Dietrich**  
Data Max
- 11:00-11:30 **Gregory R. Hirshan**  
Optronics International, Inc.
- 1:30-2:00 **Michael H. Rehmus**  
Datacopy Corporation
- 2:00-2:30 **John E. Trombly**  
Octek Inc.
- 2:30-3:00 **Gil Russell**  
Advanced Electronics Design, Inc.

### ■ CAD/CAM Beacon H, Sheraton-Boston

- 9:30-10:00 **John Lugsdin**  
Orcatech Inc.
- 10:00-10:30 **Phil Marshall**  
Imlac Corporation
- 10:30-11:00 **Craig Rasmussen**  
Evans & Sutherland
- 11:00-12:00 **David Ver Hoeven**  
Tektronix, Inc.
- 1:00-2:00 **Andy Rubel**  
Rubel Software
- 2:00-2:30 **John Moreland**  
Megatek Corporation
- 2:30-3:00 **Jerry Kennedy**  
Advanced Electronics Design, Inc.

# Exhibition



## Exhibitor Listing

Booth 1108 **ADAGE, INC.**

**One Fortune Drive  
Billerica, MA 01821  
(617) 667-7070  
M. CLARE MOULTON  
Director of Marketing Communications**

**User Group Contact:  
JERRY ORNSTEIN  
Software Training Specialist**

Adage will be exhibiting two minicomputer-compatible Adage 4100 Graphics Workstations reacting with two- and three-dimensional data bases. Various Adage interactive console devices, such as lighted function switches, variable control dials, data tablets, joysticks and light pens, will be shown. An Adage local hard copy unit also will be featured. Demonstrations will include dynamic three-dimensional rotation with depth cueing, zoom, two and three-dimensional hardware windowing, circle arcs, and Z axis clippings. These interactive demonstrations will cover several application areas, including Computer Aided Design, Finite Element Modeling, and Computer Aided Engineering.

Booth 2437 **ADVANCED COLOR TECHNOLOGY, INC.**

**21 Alpha Road  
Chelmsford, MA 01824  
(617) 256-1222  
ROBERT G. MANNING  
Vice President-Sales**

The ACT 1 Color Copier makes low cost color copies of color images displayed on computer graphic terminals. The dot-addressable ACT 1 is about the size of an office typewriter and uses an ink-jet printing technology to produce multicolor images on paper in less than two minutes for an 8½" x11" print. Using the basic colors of cyan, magenta and yellow, the ACT 1 can produce up to 125 color shades while printing up to a width of 12½" on roll or fanfold paper. The ACT 1 allows up to 250 continuous copies per roll of paper.

**\*Serves as User Group Contact as well as  
Marketing or Technical Contact**

**Booth 1316 ADVANCED ELECTRONICS DESIGN,  
INC. (AED)**

**440 Potrero Avenue  
Sunnyvale, CA 94086  
(408) 733-3555  
JERRY KENNEDY  
Vice President-Operations/Marketing**

**User Group Contact:  
ROBIN RATAJCZAK  
Promotions Coordinator**

AED, manufacturers of DEC compatible disk controllers and intelligent color graphics terminals, will display their AED512 color system along with the new AED767 color terminal. The new 767 features anti-aliasing built into the firmware and has additional features such as 1K x 1K x 8 virtual address space with a 768 x 575 viewing window, ellipse and arc generators, stipple-filled rectangles, blue-lined cross reference grid, 16.8 million colors and much more. Also featured is the new AED Design Console, which is a packaged system that turns the AED512 or 767 into an integrated workstation minus applications software. Included is ergonomically designed furniture, CPU of your choice, a variety of disk storage options, integrated alphanumeric display, keyboard, joystick and data tablet.

**Booth 2416 ALTEK CORP.**

**2150 Industrial Parkway  
Silver Spring, MD 20904  
(301) 622-3906  
\*LOWELL NERENBERG  
Director of Sales & Marketing**

Altek began manufacturing digitizers in 1970. Their products are used widely in cartographic mapping applications — where accuracy and dependability are most critical. The Datatab<sup>®</sup> free curso digitizer is well known for its long term reliability and accuracy. Available in sizes from 12"x12" to 42"x60", Altek will exhibit a 36"x48" model with resolution of .001", accuracy of  $\pm .003$ ", and variable intensity backlighting.

## Exhibitor Listing

Altek will demonstrate its simple, low-cost digitizer controller alongside the SUPER-DISK® intelligent controller for graphic and photogrammetric digitizing applications.

### Booth 2718 **AMDEK CORP.**

2420 E. Oakton Street/Suite E  
Arlington Heights, IL 60005  
(312) 364-1180

**DAN RIMES**  
Sales Manager  
**TED McCracken**  
Technical Advisor

Products to be displayed: Video 300, 12" green screen monitor. Color-I, composite 13" color monitor. Color-II, RGB TTL input, resolution 560(H) x 260(V). Color-III, RGB TTL input, resolution 260(H) x 300(V). Color-IV, RGB Analog input, resolution 720(H) x 400(V). 3" Micro Disk, 500K bytes/per drive; 2 drives and power supply. X-Y Digital Plotter, 4-color pen select. 16 bit IBM-PC compatible computer.

### Booth 1736 **AMF LOGIC SCIENCES, INC.**

10535 Rockley Road/Suite 103  
Houston, TX 77099  
(713) 879-0536

**ROGER FULLER**  
Vice President

**User Group Contact:**  
**JOHN BARUGH**  
Vice President

AMF Logic Sciences is a manufacturer specializing in State-of-the-Art, cost effective systems configured for high speed seismic (vector and raster) plotting, or CAD/CAM applications.

### Booth 2412 **ANALOG TECHNOLOGY CORP.**

15859 E. Edna Place  
Irwindale, CA 91706

**(213) 960-4004**

**JAMES L. LAWRENCE, JR.**

**President**

ATC's Graphics 810 plug-in conversion boards make the highly reliable Texas Instruments 810 RO printer the fastest low-cost matrix impact graphics printer available and provide a variety of hardware and software fonts. Plug-in hard copy for a growing number of graphic terminals is also provided. The new Model 200 vector to raster converter board allows the TI 710 to accept plot vectors directly from the host computer, map them in a 1024 x 1024 memory and plot the resultant image on 14.75 x 11.5 paper.

**Booth 3005 THE ANDERSON REPORT**

**4505 E. Industrial Street 2-J**

**Simi Valley, CA 93063**

**(805) 581-1184**

**KEN ANDERSON**

**Publisher**

The Anderson Report is a monthly newsletter edited exclusively for the computer graphics industry. Each issue features current news of the industry, information about new products, orders and installations, people and places, and a calendar section. Every issue also includes a special Inside Report on a major computer graphics vendor. This report is a comprehensive analysis of the company, its products and market position. The Anderson Report also provides in-plant seminars and special consulting services for computer graphics users.

**Booth 2621 APOLLO COMPUTER INC.**

**19 Alpha Road**

**Chelmsford, MA 01824**

**(617) 256-6600**

**\*JOHN BOWNE, JR.**

**Product Marketing Manager**

## Exhibitor Listing

Apollo Computer designs, manufactures, sells and services the DOMAIN, a distributed computing environment based on a high-speed local area network of user dedicated, 32-bit computational nodes. Each computation node has transparent access to system resources via DOMAIN's network-wide virtual memory demand paging operating system. Computational nodes include a high resolution raster scan graphics display, up to 3.5 megabytes of main memory, plus disk, mag tape and line printer options.

### Booth 2732 **APPLE COMPUTER**

**20525 Mariani Avenue  
Cupertino, CA 95014  
(408) 996-1010  
JERRY BOWER**

Demonstrations will be with Apple II and Apple III computers, graphics tablet, business graphics, and other peripherals and related software.

### Booth 1104 **APPLICON/A SCHLUMBERGER CO.**

**32 Second Avenue  
Burlington, MA 01803  
(617) 272-7070  
DANIEL BOWMAN  
Trade Show Coordinator**

**User Group Contact:  
BEVERLY DiCHARA  
User Group Coordinator**

Applicon's new Series 4000 CAD/CAM systems will be displayed for the second time on a national trade show level at SIGGRAPH. Series 4000 systems address every phase of the product development cycle, from a designer's first sketches to final changes, to the preparation of programs for numerically controlled machine tools. Applicon will utilize the Series 4000 to demonstrate capabilities such as piping, space planning, PCB design, Hybrid design and solids modeling, just to name a few.



Booth 2828 **ASEA INDUSTRIAL SYSTEMS**

**120 Bishops Way  
Milwaukee, WI 53005  
(414) 784-2900  
ULF HANSSON  
Marketing Services**

**User Group Contact:  
HANS SIGVARDSSON  
Product Manager**

The Tesselator® is a color display controller from ASEA Industrial Systems that gives optimum readability. It offers a choice of 896 characters and 64 colors. Its patented character generator lets you define your own symbols, and only Tesselator® combines this feature with a symbol-oriented, multi-color display contour that is ideal for process control applications. Additional features include interfaces for two to four computers, an editing function that includes tabulating and window functions, and presentation capabilities for up to 16 trends with a resolution better than 0.5 percent.

Booth 3010 **ASSOCIATION FOR COMPUTING MACHINERY**

**11 W. 42nd Street  
New York, NY 10036  
(212) 869-7440  
LOU FIORA  
Conference Coordinator**

As *the* educational and scientific society of the information processing community, ACM attracts and serves the finest theoreticians and practitioners throughout the world, the leading edge of computer technology — gathering at conferences and chapter meetings, publishing and reading the most probing technical literature, sharing ideas and information, promoting the common good of computing professionals. It is a volunteer organization whose composition and activities have always reflected the changing nature and needs of people engaged in computing arts and sciences.



## Exhibitor Listing

### Booth 1522 **AYDIN CONTROLS**

**414 Commerce Drive  
Fort Washington, PA 19034  
(215) 542-7800  
\*CARL TAUS  
Product Support Engineer**

Aydin Controls will be exhibiting a full line of Color Graphics Display Systems. Products at the exhibit will include: the AYCON 16/ Series, an enhanced version of the Aydin model 5216 Display System, the multi-channel model 5215 Display Generator, the 5217CT character graphic display terminal, and the PATRIOT™, the high resolution in-line gun series monitors. Also featured at the show will be demonstrations of the latest in long-distance video drive capability through fiber optics by Artel Communications.

### Booth 1720 **AZTEK, INC.**

**23265 S. Pointe Drive  
Laguna Hills, CA 92653  
(714) 770-8406  
GINNY BURNAM  
Marketing  
PHIL LIPPINCOTT  
President**

Aztek has unbundled its software from its turn-key Graphic Systems and SLIDESYSTEMS™ offerings. The SLIDEGRAPHIC™ (interactive business and graphic arts program) and AZCORE™ (device independent graphic support library) software packages are now independently offered. Aztek will be at Booth 1720 to tell you about its interactive Model 1030 color SLIDESYSTEM™ and unveil options for new NTSC video, low cost 1024 x 1280 film recorders and WORD CHART™ software. WORD CHART™ allows any RS-232 compatible terminal to prepare high resolution slides (up to 4000 x 4000) using standard text entry techniques.

Booth 2110 **BENSON INC.**

**385 Ravendale Drive  
Mountain View, CA 94043  
(415) 965-9900  
AL SALOTTOLO  
Vice President-Marketing/Sales**

Benson will exhibit its expanding line of electrostatic plotters, pen plotters, supplies, controllers, vector to raster converters, and recently announced low cost laser plotter. Products to be demonstrated: the Laserwriter™ 100 is a tabletop plotter with resolution of 200 dots per inch. The high contrast dry toned plots are produced by the plotter using a holographic disk to generate raster scans. Interfaces are available for video copy and popular computer systems. A Q Series electrostatic plotter with transparent film feature for generating plots on polyester based transparent film, and the Model 5343 pen plotter utilizing the most sophisticated microprocessor in the marketplace will be highlighted.

Booth 2703 **BUSINESS COMPUTER SYSTEMS**

**221 Columbus Avenue  
Boston, MA 02116  
(617) 536-7780  
SUSAN RAPAPORT  
Promotion Director**

**User Group Contact:  
JIM DIFILIPPO  
National Sales Manager**

*Business Computer Systems* is a new computer publication devoted entirely to users of business computer systems in business applications. *Business Computer Systems'* controlled circulation is identified by make and model number in current use at their business location. Editorial coverage emphasizes peripherals, software and other related products for the expansion of business computer systems.

## Exhibitor Listing

### Booth 2723 **BUSINESS SCREEN MAGAZINE**

330 W. 42nd Street  
New York, NY 10036  
(212) 947-0020  
**DEAN EAKER**  
Publisher  
**TOM TOLNAY**  
Editor

*Business Screen* is a 40-plus year old trade communications magazine serving the business, broadcast and advertising community under the banner, *New Technologies For New Times*. Those technologies include *Computer Images & Graphics*, *Video*, *Mult-Image*, as well as the various formats of *Film*. In special issues devoted to *Computer Pictures*, the magazine pays special attention to the needs and interests of the SIGGRAPH membership.

### Booth 2921 **BYTE PUBLICATIONS, INC.**

70 Main Street  
Peterborough, NH 03458  
(603) 924-9281  
**BILL WATSON**  
Marketing Coordinator

Publishers of computer magazines: *Byte* edited for the high tech user, and *Popular Computing*, for the intelligent newcomer to computers. Byte Books carries a full line of computer related books.

### Booth 1814 **CADLINC INC.**

8600 W. Bryn Mawr  
Chicago, IL 60631  
(312) 693-6700  
**CLEM MEAS**  
Marketing Manager

User Group Contact:  
**TOM ALWICKER**  
Product Manager

CADLINC develops, manufactures and markets graphic computers and CAD/CAM related software. Headquarters are in Chicago, with Advanced Research and Development in Palo Alto, Calif., and product engineering in Troy, Mich. The company's products include a series of Graphic computers that form building blocks for sophisticated networked graphics systems. The series has been specifically designed for interactive graphic application environments such as text processing, CAD/CAM, process control and software design. Target markets include both OEM and end-user engineering workstations. Key system features are: 1024 x 800 bit-mapped graphics display, UNIX, C and FORTRAN software support, M68000 CPU, multibus, parallel bus and ETHERNET communications. Additionally, the company markets GNC (Graphics Numerical Control), a software package for Numerical Control and CAD/CAM applications.

Booth 1208 **CALCOMP**

**2411 W. LaPalma**  
**Anaheim, CA 92801**  
**(714) 821-2281**  
**M. SCHOENHERZ**  
**Trade Show Coordinator**

CalComp has the broadest array of computer graphics hardware available in the industry: turnkey systems, graphics displays, vector and raster plotters, and digitizers. Support is provided through technicians and systems analysts worldwide. CalComp will be introducing two new beltbed plotters as well as showing its recently announced Vistagraphic<sup>TM</sup> 4000 family of raster displays. Also being demonstrated will be the Model 953 controller which is capable of driving both vector and raster plotters, a 9000 and 2000 Series digitizer, a 26" and 22" raster plotter, a Vistagraphic 1300 stroke refresh display, and a Model 1012 table top drum plotter.

## Exhibitor Listing

### Booth 1128 **CELCO**

**70 Constantine Drive  
Mahwah, NJ 07430  
(201) 327-1123  
\*PAUL CONSTANTINE  
Vice President**

High resolution color film recording system manufactured by Celco sets new industry standards in the production of extremely high quality imagery. "THE CELCO MACHINE" with its high recording speed, 4000 x 4000 pixel resolution and variable format (16mm to 8" x 10") features is widely accepted in computer generated business graphics, animation and special effects, satellite imagery and scientific R&D precision color film recording applications.

### Booth 2225 **CHARLES RIVER DATA SYSTEMS, INC.**

**4 Tech Circle  
Natick, MA 01760  
(617) 655-1800  
DAN DeLEA  
Vice President-Marketing**

Charles River Data Systems will introduce a very-high-performance integrated color graphic workstation based upon its Universe 68 series microcomputer system and the Graphic Strategies, Inc. VERSAgraphics Module. The workstation features an MC68000 based microcomputer with 256K byte main memory, memory management unit, 20M byte Winchester disk, 1M byte 8" floppy disk, rev. 7 UNIX compatible real-time operating systems and 16-color, 512 x 512 or 1024 x 1024 element, raster scan display.

### Booth 2810 **CHROMATICS, INC.**

**2558 Mountain Industrial Blvd.  
Tucker, GA 30084  
(404) 493-7000  
KEN BROWN  
Director of Sales**



Chromatics is a manufacturer of computers specializing in color graphic applications. The CGC 7900 color graphic computer features a 16-bit MC68000 microprocessor, 19" CRT, dual flexible disk drives, 10 MB and 40 MB hard disks, Idris Multi-Tasking Operating System with C, PASCAL and FORTRAN Compilers and supports up to 8 MB of user RAM. It offers full color graphics capabilities in 1024 x 768 viewable dot resolution with up to 16 million colors from which to choose. Also on display is our standard CG series of stand-alone color graphic computers in 512 x 512 resolution with 8 foreground and 8 background colors and a wide range of memory and I/O options.

Booth 2518 **COLORGRAPHIC COMMUNICATIONS CORP.**

**2379 John Glenn Drive/Suite 105  
Atlanta, GA 30341  
(404) 455-3921  
EZRA MINTZ  
President**

**User Group Contact:  
WOODY PRITCHETT  
Senior Engineer**

Colorgraphic Communications manufactures color graphic CRT terminals. The MVI-7 has three selectable screen sizes (80 x 56, 140 x 32, 160 x 28), character graphics of 720 x 288, and 1280 user programmable symbols. The MVI-100 has two selectable screen sizes (80 x 192, 160 x 96), character graphics of 160 x 120 or 160 x 240. Both terminals have 13" high resolution display tubes, vertical and horizontal scroll, six monochrome emulators, four addressable cursors and screens, RS-232 and selectable baud rates of 110 to 19,200.



## Exhibitor Listing

### Booth 2332 **COMARC SYSTEMS**

150 Executive Park Blvd.  
San Francisco, CA 94134  
(415) 467-1300  
**PAT SCHULTZ**  
Director of Product Support

Comarc Systems offers a geographic information system: a mapping system which understands the data. This is a stand-alone system with complete hardware and software capability to support map encoding, color interactive graphics, plotting, integrated management of graphic and tabular data, map overlaying, data interpretation and modeling. The Comarc organization is capable of providing a complete range of services, including system maintenance, data encoding and applications consulting. Comarc customers include forest companies, cities, counties, states, developing countries, consulting firms and utilities.

### Booth 2324 **COMBINED LOGIC RESEARCH CORP.**

760 N. Cahuenga Blvd.  
Los Angeles, CA 90038  
(213) 463-5625  
**GEORGE GREENBERG**  
President

System design and integration relating to visual information systems specifically engineered to solve individual application requirements. End user systems integrate disk based operating systems (with application software developed in high level languages to insure ease of programmability and transportability) with either commercially available hardware architectures and/or Combined Logic Research custom hardware.

### Booth 3018 **COMPUTER AIDED DESIGN & DRAFTING SERVICES, INC.**

Waltham, MA 02154  
(617) 449-4578  
**RAYMOND PRESBREY**  
Executive Vice President

**User Group Contact:**  
**R. DAMON OLLERHEAD**  
**President**

Computer Aided Design & Drafting Services is a computer graphics service bureau that provides an opportunity to increase productivity while improving quality and profits. If getting to the market on time or if a contract is at stake, this company is an intelligent, economical solution in the area of computerized drafting.

**Booth 2722 COMPUTER-AIDED ENGINEERING  
& MACHINE DESIGN**

**1111 Chester Avenue**  
**Cleveland, OH 44114**  
**(216) 696-7000**  
**WILLIAM TUCKER**  
**Publishing Director**

These two technical journals editorially cover the complete field of computer-aided design, testing, manufacturing and factory control, and management. Through their advertising pages, they serve as marketing forums for those companies who supply hardware and/or software for data-base applications in design and manufacturing.

**Booth 1716 COMPUTER DECISIONS/  
HAYDEN PUBLISHING COMPANY, INC.**

**50 Essex Street**  
**Rochelle Park, NJ 07662**  
**(201) 843-0550**  
**DON HUBER**  
**Vice President & Publisher**

**User Group Contact:**  
**KELLEY CODNER**  
**Administrative Sales Supervisor**

*Computer Decisions* is a user publication that is application oriented and aims at the needs of MIS/DP and Company Management making decisions to expand their information resources to improve productivity.

## Exhibitor Listing

Booth 2325 **COMPUTER DESIGN  
AND APPLICATIONS, INC.**

377 Elliot Street  
Newton, MA 02164  
(617) 964-3770  
**LOIS VANDALINDA**  
Manager, Marketing Communications

Computer Design and Applications will be demonstrating image processing systems used for enhancing and evaluating images. Systems are built around the popular LSI-11 series computers and high performance array and display processing equipment. The systems have high resolution graphics, high performance processors, monitors, stand-alone image processors, and Core standard software.

Booth 2126 **COMPUTER DESIGN PUBLISHING  
COMPANY**

11 Goldsmith Street  
Littleton, MA 01460  
(617) 486-8944  
**GENE PRITCHARD**  
Director of Marketing

The magazine of computer based systems, primarily concerned with the design and application of computer based systems. *Computer Design* offers direct action postal mailers and list rental as part of their services. Current issues of the magazine will be available for distribution.

Booth 1518 **COMPUTER GRAPHICS WORLD**

1714 Stockton Street  
San Francisco, CA 94133  
(415) 398-7151  
**RANDALL L. STICKROD**  
Publisher

*Computer Graphics World* is the only monthly trade magazine devoted exclusively to computer graphics. Editorial content features extensive coverage of computer graphics

applications and comprehensive news coverage of new developments throughout the industry. Additional regular features include interviews with key newsmakers, hardware and software reviews and evaluations, and surveys of computer graphics users. Special issues focus on topics such as international developments, rapidly developing areas of application such as management information systems and CAD/CAM, and highlights from the major trade shows and conferences.

Booth 2326 **COMPUTER PICTURES CORP.**

**20 Broad Street  
Boston, MA 02109  
(617) 720-1700  
THOMAS P. McAULIFFE  
Executive Vice President**

**User Group Contact:  
JOHN T. KARCANES  
Vice President-Sales & Corp. Development**

Computer Pictures has introduced the first comprehensive "executive information system" utilizing graphic formats. The system is a turnkey hardware and software product that draws automatically from a corporate database, can perform almost unlimited computational and statistical functions, automatically graph all resulting summaries and store results as pictures for instant management review through a touch screen device employing random logic access. High speed output devices are also offered to provide 8½x11 color hard copies on plain paper, overhead transparencies, and 35mm slides.

Booth 2604 **COMPUTERWORLD**

**375 Cochituate Road/Box 880  
Framingham, MA 01701  
(617) 879-0700  
ROY J. EINREINHOFFER  
Vice President-Marketing**

## Exhibitor Listing

*Computerworld*, the newsweekly for the computer community, is read by more than 500,000 people each week. Featuring news, product release information, application stories and in-depth tutorials, *Computerworld* is able to present information for all levels of interest within the corporate environment.

### Booth 3019 **CONFERENCE BOOK SERVICE**

**80 S. Early Street**  
**Alexandria, VA 22304**  
**(703) 823-6966**  
**DODIE WILLIS**  
**Exhibit Coordinator**  
**MARK TROCCHI**  
**Scheduling Manager**

Browsing collection of technical books in the field of computer graphics.

### Booth 1620 **CONRAC DIV./CONRAC CORP.**

**600 N. Rimsdale**  
**Covina, CA 91722**  
**(213) 966-3511/Ext. 347**  
**BOB HOFER**  
**Advertising Manager**

**User Group Contact:**  
**WILLIAM EMS**  
**Western Regional Sales Manager**

Model 7211 high resolution color RGB display in 19" and 13" precision in-line (PIL) CRT. Major features include selectable scan frequencies (15 KHz to 36 KHz in the same unit); 40 MHz video bandwidth; 0.3mm shadow mask delta pitch; EIA RS 170 or RS 343 composite video formats; 1080H x 809V pixel resolution with 19" CRT, 921H x 739V pixel resolution with 13" CRT. Model 2400 high resolution monochrome display. 1280H x 960V pixel resolution with 19" CRT; 40 MHz bandwidth, selectable scan frequency option (15 KHz to 36 KHz in one unit). These, and other Conrac Models, will be operating from medium to ultra-high resolution graphic systems, displaying applications pro-



grams using color and monochrome, standard and long-persistence phosphors, non-glare screen treatment, and other features.

Booth 2721 **CRAY RESEARCH, INC.**

1440 Northland Drive  
Mendota Heights, MN 55120  
(612) 681-3229  
**W. DEREK ROBB**  
Manager, Applications Department

User Group Contact:  
**JOHN ALDAG**  
Senior Applications Analyst

Cray Research, manufacturers of the world's fastest supercomputers, and Digital Productions, Inc., digital image producers, will discuss and demonstrate the power of CRAY-IS and CRAY X-MP computers in state-of-the-art graphics.

Booth 2218 **CROMEMCO, INC.**

280 Bernardo Avenue  
Mountain View, CA 94043  
(415) 964-7400  
**DR. ALICE E. AHLGREN**  
Director of Communications

Cromemco manufactures a complete line of powerful microcomputer based graphics systems which can be used to display color or black-and-white images with up to 754 x 484 point resolution. The company also provides a number of sophisticated software packages for use with the graphics system, including Slidemaster, a powerful tool for creating graphics and text displays, and Fontmaster, which allows the user to interactively design his own fonts; and a software development package which is ideal for the development of graphics applications such as process control, business statistics and charts, medical imaging, and computer-aided instruction.



## Exhibitor Listing

### Booth 2824 **CUBIC SYSTEMS**

**2215 Spaulding Avenue**  
**Berkeley, CA 94703**  
**(415) 841-8072**  
**ED BERLIN**  
**Director of Engineering**

Cubic Systems, a company specializing in three-dimensional graphics, introduces the CS-3 color terminal. This versatile tool for design and analysis implements a full range of two-dimensional and three-dimensional functions, including hidden surface removal, smooth shading, and anti-aliasing. The multibus based system uses an 8086 and 8087, and becomes a stand-alone computer with optional floppy or hard disk. This model generates a 512 x 512 pixel image, displaying 4096 colors from a palette of 16 million. The CS-3 comes with two image planes, a 20" RGB monitor, and a 90-day warranty.

### Booth 2511 **DATACOPY CORP.**

**1070 E. Meadow Circle**  
**Palo Alto, CA 94303**  
**(415) 493-3420**  
**MICHAEL H. REHMUS**  
**Director of Marketing**  
**ALAN HOLMBERG**  
**Marketing Engineer**

Datcopy is demonstrating its line of CCD array digitizing cameras. The high resolution C322 offers 1720 x 2592 picture elements. The economical C312 provides 512 x 640 resolution. The C324 "multiple resolution" digitizing camera can be configured in any resolution to 1280 picture elements in X and Y dimensions and in any aspect ratio (1:1, 4:5, 3:4, 1:1.29). The cameras provide higher resolution than video, usually require less illumination, and do not have the blooming, burning, gain and offset problems of vidicon tubes. Applications include high resolution image recognition, storage or reproduction for teleconferencing, photocopying, facsimile, electronic mail, micrographics, OCR, CAD/CAM, and computer graphics.

Booth 1732 **DATAcube, INC.**

4 Dearborn Road  
Peabody, MA 01960  
(617) 535-6644  
**DANIEL P. HOSKIN**  
Sales Manager

Datacube boards digitize and display information in real time from standard video cameras for MULTIBUS and Q-BUS systems — without host computer intervention. These boards provide reliable, low cost vision for robotics, inspection, medical imaging, teleconferencing, animation, etc. Available for both monochrome and color monitors.

Booth 1535 **DATA DESIGN LOGIC SYSTEMS, INC.**

4800 Patrick Henry Drive  
Santa Clara, CA 95054  
(408) 988-7722  
**CONRAD B. VANCE**  
Sales Manager

User Group Contact:  
**JAMES E. NEWLAND**  
Vice President

Data Design Logic Systems manufactures a complete line of high quality intelligent digital pen plotters. The 4-pen drum plotters are available in 15", 26", 37" and 48" widths; flatbed sizes are "D" and "A1". The integral, intelligent controller, common among all units, requires no special host software. These sophisticated units can work as easily with microcomputers as with mainframes in any language with any operating system under any revision level.

Booth 1616 **DATAMATION**

666 Fifth Avenue  
New York, NY 10103  
(212) 489-2579  
**JOHN M. GLEASON**  
Sales Manager

## Exhibitor Listing

*Datamation*, serving the information processing professional for 25 years, will distribute complimentary copies of the current issue to SIGGRAPH attendees. Information on related products and services also will be available at the *Datamation* booth.

### Booth 2832 **DATAMAX/TDS**

2256-B Landmeier Road  
Elk Grove Village, IL 60007  
(312) 981-8205  
**RON CHAN**  
Technical Manager

Datamax will display the UV-1 Graphics System featuring ZGRASS, a non-programmer oriented language for generation of real time animated graphics.

### Booth 2738 **DATA-TYPE, INC.**

2615 Miller Avenue  
Mountain View, CA 94040  
(415) 949-1053  
**AVERY BLAKE**  
President

User Group Contact:  
**DORON GOLDE**  
Manager Product Supplies

The AutoGraph Graphics Display Terminals, both color and monochrome, are low cost Teletronix-compatible units for both large and small computer systems. Users of large system graphics packages like Tell-A-Graf, PLOT-10 etc. can expand the use of their systems with low cost "preview" terminals and fast, localized "scratch pad" printing. High and low resolution displays, various input and output options available.

Booth 1741 **DESIGN AIDS, INC.**

27822 El Lazo Road  
Laguna Niguel, CA 92677  
(714) 831-5611  
\*NANCY SAVINELLI  
Vice President-Marketing & Sales

DS1 is an Electronic Schematic Input System and Data Base Capture System for interfacing to PCBoard Routing Systems (REDAC, SCICARDS<sup>TM</sup>, AUTOMATE and ASI Prance, etc.). Interfaces available for interfacing to Wire Wrap and Simulation, DS1 is the only system which allows for data capture in a Non-Gridded Mode via digitizer. Vocal Output Unit talks to operator and data is captured on an IBM personal computer. Data is then transmitted to host computer for processing. Computer straightens out crooked lines and inputs real size symbols. Edits are performed in minutes due to Non-Gridded Mode.

Booth 3000 **DESIGN NEWS/A CAHNERS PUBLICATION**

221 Columbus Avenue  
Boston, MA 02116  
(617) 536-7780  
NICOLE BORDEN  
Marketing & Promotion Director

*Design News* is a publication serving design engineers in the OEM.

Booth 2010 **DICOMED CORP.**

9700 Newton Avenue, S.  
Minneapolis, MN 55431  
(612) 887-7100  
LAWRENCE M. MARTIN  
Director of Sales & Marketing

User Group Contact:  
JAMES C. CONNOLLY  
Manager of Customer Support

## Exhibitor Listing

**THE DICOMED D38+ DESIGN STATION:** Based on earlier Dicomed design stations which set new standards in the industry, the D38+ incorporates several advanced features. Increased memory, quicker drawing time, an automatic curve smoothing feature and a new patented figure type called Flexigon make it the most advanced system of its type available.

**THE DICOMED SOLUTION:** The MICROMEDIA Slide Composition System enables you to produce high quality Pie Charts, Bar Charts, Column Charts, Line Graphs and Text Slides, using any of 64 different colors. The System is composed of easy-to-use software, an overlay sheet to be placed on your Apple Graphics Tablet, a 16K byte memory expansion board to handle the additional requirements of the software, and a manual that clearly describes the operation of the System.

Booth 1638 **DIGITAL DESIGN/MORGAN-GRAMPIAN PUBLISHING COMPANY**

1050 Commonwealth Avenue  
Boston, MA 02215  
(617) 232-5470  
**JOHN MOON**  
Sales Representative

**User Group Contact:**  
**BOB HIRSHON**  
Managing Editor

Morgan-Grampian Publishing Company will distribute these three publications: *Circuits Manufacturing*, the magazine of processing, production, assembly, test and inspection; *Digital Design*, the magazine of systems electronics, serving engineers and engineering managers who design computer based systems and specify the appropriate computers and peripherals for them; *Electronics Test*, the first and only magazine devoted entirely to electronics test for designers, applications and systems maintenance engineers.



Booth 2408 **DIGITAL ENGINEERING, INC.**

630 Bercut Drive  
Sacramento, CA 95814  
(916) 447-7600  
**NADARA A. CRAUN**  
**Marketing Support Specialist**

Digital Engineering manufactures Retro-Graphics<sup>™</sup> and Color Retro-Graphics<sup>™</sup> terminal enhancements for some of the most popular terminals on the market today — the TeleVideo, Lear Siegler ADM Series, the DEC<sup>™</sup> VT100<sup>™</sup>, VT101<sup>™</sup>, VT131<sup>™</sup> and VT132<sup>™</sup>, ADDS Viewpoint, TI OPTI 900 Model 940 and Datamedia Colorscan. These upgraded alphanumeric terminals are capable of complicated graphics without affecting the alphanumeric capabilities of the terminals. These products are on exhibit at our booth.

Booth 1228 **DIGITAL EQUIPMENT CORP.**

200 Forrest Street  
Marlboro, MA 01752  
(617) 467-6900  
**GAIL JACOBS**  
**Marketing Communications Manager**

Featured in the Engineering Systems Section of Digital Equipment's booth will be engineering graphics optimized for VAX/VMS systems, the recently announced Professional 350 personal computer for engineers, and the 11C03 high speed asynchronous interface for RS-232 graphics devices.

Booth 1228 **DIGITAL EQUIPMENT CORP.**

5 Flagstone Drive  
Hudson, NH 03051  
(603) 884-6488  
**ANIL PORBUNDERWALA**  
**Marketing Product Manager**

Digital Equipment will feature its family of VSV/VS11 high performance raster scan graphics systems. These systems interface



## Exhibitor Listing

directly to Digital's own PDP-11 and VAX series computers. The VSV/VS11 offer superior technology, features and flexibility which makes them attractive in a wide range of applications from CAD/CAM and process control to imaging.

### Booth 2516 **DUBNER COMPUTER SYSTEMS**

158 Linwood Plaza  
Fort Lee, N.J. 07024  
(201) 592-6500 or (212) 594-5831  
**IVAN MALTZ**  
Project Manager

The Dubner CBG-2 produces broadcast quality color images and animation sequences. It incorporates a character generator, digital painting system, and three-dimensional curve generation features.

### Booth 2237 **EIGEN VIDEO**

Box 848  
Nevada City, CA 95959  
(916) 272-3461  
**JOHN L. ROMANKO**  
Sales Manager

Eigen manufactures color and monochrome video disc recorders in a variety of bandwidths. These recorders may be used for dynamic or static display of images in the field or frame modes. Eigen also manufactures a video frame grabber that has multibus DMA capabilities.

### Booth 2924 **EIKONIX CORP.**

23 Crosby Drive  
Bedford, MA 01730  
(617) 275-5070  
**ALAN S. BARRETT**  
Director of Marketing Industrial Products

User Group Contact:  
**LEW BROWN**  
Sales Engineer

Exhibiting the EC78/99, a high resolution digital camera with full color sensitivity. The camera generates up to 2048 x 2048 pixels with 1 to 12 bits of intensity level per color in under 50 seconds. Eikonix manufactures high resolution flatbed image digitizers, and integrates complete image processing systems using Eikonix Picture Processing Language (EPPL<sup>™</sup>), a user friendly image processing software package.

**Booth 1641 ELECTOR**

**5128 Calle Del Sol  
Santa Clara, CA 95050  
(408) 727-1506  
GUIDO GOVAERT  
Sales Manager**

**User Group Contact:  
JOHN THOMAS  
Service Manager**

Elector is the exclusive North American distributor for Barco color data displays and Videpro Hi-Beam projectors. We will be showing a full line of Barco color displays from OEM chassis to delta-gun delta-dot shadow mask and in-line delta-dot shadow mask monitors, with video bandwidth up to 50 MHz and horizontal scan rate up to 36 KHz. On the Videpro Hi-Beam projector we will be showing graphics capability with 80 characters, 26 lines of alphanumerics.

**Booth 2822 ENVISION**

**631 River Oaks Pkwy.  
San Jose, CA 95134  
(408) 946-9755  
CORLEY PHILLIPS  
Product Manager**

Envision is exhibiting an intelligent color graphics terminal and a high resolution color printer for OEM applications.

## Exhibitor Listing

Booth 2628 **EUROPEAN SOFTWARE CONTRACTORS  
ApS**

**385A Lyngbyvej  
DK-2820 Gentofte, Denmark  
+45 1 65 74 12  
\*JAN G. KNUDSEN  
President**

ESC markets the UNIRAS raster-device independent color graphics software package. In addition to basic plotting in full color or monochrome (RASPAK), UNIRAS contains several high-level application packages for mapping and contouring (GEOPAK), image processing (GIMAGE), seismic data display (SEISPAK) and business graphics (BIZPAK). Also advanced geostatistical programs (KRIGPAK) are available. (In North America: American Software Contractors, 48 Cummings Park, Woburn, MA 01801.)

Booth 1136 **EVANS & SUTHERLAND COMPUTER  
CORP.**

**580 Arapeen Drive  
Salt Lake City, UT 84108  
(801) 582-5847  
JAMES F. CALLAN  
General Sales Manager**

**User Group Contact:  
TED NAANES  
Marketing Services Manager**

Evans & Sutherland will present its full range of leading-edge computer graphics technology at SIGGRAPH '82. The spectrum of computer graphics tools ranges from PS 300, the most advanced distributed processing 3-D line drawing system on the market, to CT-5, the world's most sophisticated real-time raster system simulator. Also presented will be ROMULUS, a solid geometric modeling software package, and DIGISTAR, the world's only digital planetarium projection system.

**Booth 2823 FLORIDA COMPUTER GRAPHICS**

**1000 Sand Pond Road  
Lake Mary, FL 32746  
(305) 321-3000  
JO HUNNICUTT  
Manager, Marketing Communications**

Florida Computer Graphics will display its line of computer graphics systems. The Beacon<sup>™</sup> System offers true bit mapped graphics, 640 x 480 resolution, 32 of 256 colors, and up to 896 KB RAM. A bit slice processor and resident firmware allow high speed graphics generation. The Multiple Processor Architecture (MPA) allows the Beacon<sup>™</sup> System to accommodate graphics, word processing and data processing. The ergonomically designed display incorporates height, tilt and swivel adjustments, anti-glare screen, detached keyboard and smooth horizontal and vertical scroll. The System's CP/M compatible operating system provides for a wide choice of application packages. The Beacon<sup>™</sup> System accepts a wide range of programming languages, including Basic, Fortran and Assembler.

**Booth 2618 FORWARD TECHNOLOGY**

**2595 Martin Avenue  
Santa Clara, CA 95050  
(408) 988-2378  
\*PAUL RAY  
Director of Sales**

Manufacturer of Graphics Workstations and support systems: 'GATEWAY' Personal Graphics Workstation running UNIX with implementation of SIGGRAPH CORE Standards.

**Booth 2000 GENERAL ELECTRIC COMPANY/VIDEO DISPLAY EQUIPMENT OPERATION**

**Electronics Park 6-205  
Syracuse, NY 13211  
(315) 456-2152  
JERROLD P. GUNDERSEN  
Manager of Marketing**

## Exhibitor Listing

General Electric, Video Display Equipment Operation, will be demonstrating high line large screen television projectors at SIGGRAPH '82. GE will demonstrate large screen applications for teaching and simulation. In addition, these systems may be used for computer aided design or computer aided manufacturing.

### Booth 2308 **GENISCO COMPUTERS CORP.**

**3545 Cadillac Avenue  
Costa Mesa, CA 92626  
(714) 556-4916  
JOHN GALLAUDET  
National Sales Manager**

Genisco Computers will demonstrate its broad line of graphics and imaging computer products. Being presented is the G6100 Color Interactive Graphics Display Terminal series. These consoles incorporate a powerful bit-slice micro-processor into a raster display terminal with many standard features, including resolutions of 768 x 512 non-interlaced and 1392 x 1024 interlaced. The popular G1000 Interactive Graphics Terminal will also be demonstrated along with its many options and peripherals. The presentation is rounded out with the incredible SpaceGraph workstation. This is a true 3-dimensional projection display with local data base interactivity.

### Booth 1536 **GEOGRAPHIC SYSTEMS, INC.**

**100 Main Street  
Reading, MA 01867  
(617) 942-0051  
BARBARA HAWKINS  
Director of Marketing**

Geographic Systems (GSI) is exhibiting business mapping products and services, providing an analytical tool to support decisions regarding where to invest critical resources. GEOMAP<sup>™</sup> is a comprehensive business mapping software package for in-house use. Continuous demonstrations of GEOMAP<sup>™</sup> will show the ease of use and broad range of capabilities of the



software. The ability to map existing data by 5-digit ZIP Codes, 1980 Census tracts, ADI's, DMA's, SAMI's, SMSA's, BEA's, and International Boundaries will be demonstrated in addition to state and county mapping. This capability is made available through GSI GEOFILES™, cartographic boundary files totally integrated with GEOMAP™. GSI also provides custom mapping services.

Booth 1021 **GOULD INC./DEANZA IMAGING  
& GRAPHICS DIV.**

1170 Lundy Avenue  
San Jose, CA 95131  
(408) 263-7155  
PHIL CLEVELAND  
National Sales Manager

The IP8500, our most powerful image processor, has five new options: 1) An extended memory, quadrupling previous storage capacity to 20 individual 1024 x 1024 x 8-bit image tiles. 2) An expanded resolution with video output controllers offering 1024 x 1024 pixel imagery in monochrome or full color. 3) Additional software: the Library of Image Processing Software (LIPS), a general purpose package for image processing, including a "command processor" and "help" instruction program. 4) A fast histogram facility, increasing histogram computation 50 times. 5) An IP8400 model with all standard and extended features operating on 12 memory tiles at a substantial savings.

Booth 3015 **GOVERNMENT DATA SYSTEMS  
MAGAZINE**

475 Park Avenue S.  
New York, NY 10016  
(212) 683-8430  
GEORGE JOEL FINE  
Publisher

*Government Data Systems* is edited for federal, state and local information managers and public administrators involved in systems-based solutions to government problems. It is the one



## Exhibitor Listing

magazine that brings together important new studies of government oriented systems applications and operations as well as current reports on management programs, training techniques and public policy.

### Booth 2422 **GRAPHIC COMMUNICATIONS, INC.**

**200 Fifth Avenue  
Waltham, MA 02254  
(617) 890-8778  
DAVID P. TARRANT  
Vice President-Marketing**

GRAPHWRITER<sup>™</sup> is a complete stand-alone desk top computer graphics system which costs no more than a quality word processor. It produces the highest quality hard copy computer graphic output and is easy to use, requiring no special operator training or computer personnel. The key to the GRAPHWRITER<sup>™</sup> system is a catalog of over 40 business graphic formats, including pie, bar and line charts, Gantt charts, organization charts and more. Each format has an unique input form which allows an author to specify his graphic requirement without leaving his office or having to go near the computer itself.

### Booth 2724 **GRAPHIC CONTROLS CORP.**

**189 Van Rensselaer Street  
Buffalo, NY 14240  
(716) 847-7500  
MICHAEL LIPUMA  
Telemarketing Manager**

The Coated Products Div. of Graphic Controls offers a single source of fast image papers and related chemicals for use in Electrostatic Printer/Plotters, including Versatec, Benson Varian, CalComp/Gould, Houston Instrument. Thermal papers for use in printer terminals and calculators, including Texas Instrument, Hewlett-Packard, Computer Devices, NCR, 3M, Apple, etc. and Electrostatic/Thermal papers for facsimile devices including Xerox, Qwip, 3M, Panafax, NEC, Southern Pacific and Teleauto-

graph. (Toll-free telephone: 800-828-7978 or 800-462-7332 in New York.)

Booth 2717 **GRAPHIC SOFTWARE SYSTEMS, INC.**

**25117 S.W. Parkway/Box 673**

**Wilsonville, OR 97070**

**(503) 682-1606**

**DAVID SHARON**

**Vice President-Marketing**

**JOHN GORDON**

**Vice President-Sales**

Manufacturer of mini-microcomputer graphic software products which include GSS-CORE Graphics Subroutine Library, a full implementation of the 1979 SIGGRAPH 2-D Level 1 Core Standard, and GSS-PLOT Plotting Utility for creating presentation and report quality graphs.

Booth 2227 **GRAPHIC STRATEGIES, INC.**

**3500 Granada Avenue/Suite 187**

**Santa Clara, CA 95051**

**(408) 554-6377**

**STEPHEN R. JOHNSON**

**Vice President-Marketing**

Graphic Strategies will exhibit its new VERSA-graphic Module, a very high performance, color-graphic interface to Motorola's advanced 16/32 bit MC68000 microcomputer. It also will demonstrate its EASYcolor 4000 series industrial display system and a line of computer graphic peripherals, including its recently announced intelligent trackball. The VERSAgraphic Module produces 16-color, 512 x 512 or 1024 x 1024 element, raster scan display. Other advanced features include high-speed vector, circle and arc generation; line and area texture; high quality fonts; arbitrary cursor shapes with selectable grid-lock and 2-D transformations; flicker-free refresh, and zoom. Its support software includes a high level graphic language interpreter; keyboard, digital tablet and trackball interfaces; and a powerful graphic editor that allows an unskilled operator to create, edit, store and recall skeleton and finished images.

## Exhibitor Listing

Booth 2719 **GRAPHICA COMPANY, LTD.**

505 Kaitori, Tama City  
Tokyo, Japan 206  
0423-73-6111  
**DR. KANSEI IWATA**  
President

Graphica, a computer graphics pioneer from Japan, will introduce two new products at SIG-GRAPH '82. The M-508 has a hardware smooth line generator and resolution of 512 x 512 x 24. The MB-8000 has an addressable display of 8K x 8K with viewable resolution of 1024 x 1024 and writing speed of 17,000 1/2 screen vectors per second. All Graphica equipment interfaces to most common mini-computers.

Booth 2226 **GRINNELL SYSTEMS CORP.**

2159 Bering Drive  
San Jose, CA 95131  
(408) 263-9920  
**ROBERT S. ANDERSON**  
Director of Marketing

User Group Contact:  
**JIM HIXSON**  
Marketing Manager

Grinnell Systems will display the GRIDS stand-alone Image Processing Computer System, and other products for computer graphics, image buffering and image processing.

Booth 1341 **GTCO CORP.**

1055 First Street  
Rockville, MD 20850  
(301) 279-9550  
**GEORGE HELSER**  
OEM Sales Manager

**User Group Contact:**  
**D.E. CARRUTH**  
**President**

GTCO offers graphic digitizers with tablets that are opaque, translucent or rear-projected. Sizes range from 6"x6" to 42"x60". Three sizes that emulate the Bit Pad<sup>™</sup> (a registered trademark of Summagraphics Corp.) are available with 30 day delivery. New products will be introduced at SIGGRAPH '82.

Booth 2836 **GTI CORP.**

**10060 Willow Creek Road**  
**San Diego, CA 92131**  
**(714) 578-3111**  
**STANLEY BURG**  
**Vice President-Marketing**

**User Group Contact:**  
**JIM HOLLY**

GTI announces a breakthrough in high performance graphics technology — a polygon based real time display with capabilities rivaling a multi-million dollar flight simulator. Based on a multiple bit-slice architecture, the GTI Advanced Graphics System implements a proprietary scan-line hidden surface algorithm, allowing realistic pictures of complex 3-D objects to be displayed on a standard RGB monitor. The real-time display (30 frames per second, interlaced) allows the user to interact with the displayed database. Other features include: 16-bit homogeneous coordinate representation; full perspective transformations using concatenated 4 x 4 matrices; X, Y, and Z plane clippings; display of over 512 edge intersects per scan line; 640 x 640 pixel display with over 16 million colors; automatic intensity shading of polygons based on a "moveable" light source; and software routines to support a hierarchical graphic data structure.

## Exhibitor Listing

### Booth 1408 **HEWLETT-PACKARD**

3000 Hanover Street  
Palo Alto, CA 94303  
(415) 857-7246  
**JO ANNE CORTESI**  
Marketing Engineer

Hewlett-Packard will demonstrate its broad range of graphics capabilities used to increase productivity among technical and commercial users. Both Hewlett-Packard hardware and software solutions will be on display, including business graphics, graphics workstations, graphics tools, and CAE solutions.

### Booth 2118 **HITACHI AMERICA, LTD.**

449 Alaska Avenue  
Torrance, CA 90503  
(213) 533-0888  
**JACK MacDONALD**  
Sales Manager

Hitachi America, Machine Tools Div., markets several types of digitizers and graphic tablets manufactured by Hitachi Seiko, Ltd. in Japan. Our new tiger tablets (11" x 11") are ideal for OEM applications. Other models, up to 36" x 48" digitizers, are ideal for CAD/CAM, mapping systems and universities. Prime benefits are gleaned by our resolution, accuracy, stability, versatility and competitive pricing.

### Booth 1129 **HOUSTON INSTRUMENT/BAUSCH & LOMB INSTRUMENTS & SYSTEMS DIV.**

8500 Cameron Road  
Austin, TX 78753  
(512) 835-0900  
**RANDY ARNOLD**  
Eastern Regional Sales Manager

User Group Contact:  
**GABRIELLE RYAN**  
Product Manager



Computer peripherals including the HIPLOT DMP Series of flatbed, digital plotters, COM-PLOT incremental drum plotters and the 7000 Series of digitizers. New products include: CPS-20 multi-pen drum plotter offering eight different pens selectable under program control. Continuous feed HIPLOT DMP plotters with a paper advance allowing unattended plotting regardless of plot size. HIPLOT Regis plotters designed to communicate exclusively with Digital Equipment Corp. graphics language Regis.

**Booth 1116 IBM CORP.**

**1133 Westchester Avenue**  
**White Plains, NY 10604**  
**(914) 463-8557**  
**CAL BALSDON**  
**Business Shows**  
**KEN JACKSON**  
**Graphics Marketing Representative**

IBM will provide concurrent demonstration of its business and presentation graphics producers currently available.

**Booth 2431 ID SYSTEMS CORP.**

**4093 Leap Road**  
**Hilliard, OH 43026**  
**(614) 876-1595**  
**MIKE CHANEY**  
**Sales Manager**

ID Systems will be featuring its array of high performance, low cost color and monochrome graphic terminals, the ID-100V family. These terminals are based upon the popular VT100™ terminal and provide the user with a full featured color alphanumeric terminal plus a high performance color graphics terminal for business, scientific and engineering graphic applications. The ID-100V family of graphic terminals is available with different levels of resolution and as retrofits to your existing VT100™. Hardcopy output capabilities for these terminals include color camera systems and color printers/plotters.



## Exhibitor Listing

### Booth 2401 **IEEE COMPUTER SOCIETY**

10662 Los Vaqueros Circle  
Los Alamitos, CA 90720  
(714) 821-8380  
**DAWN PECK**  
Advertising Director

The IEEE Computer Society will display books, magazines and other technical journals, and will offer information on conferences, seminars and other membership benefits.

### Booth 2417 **IKEGAMI ELECTRONICS (U.S.A.), INC.**

37 Brook Avenue  
Maywood, NJ 07607  
(201) 368-9171 or (213) 534-0050  
**\*Y. SATO**  
Chief Engineer

Ikegami Electronics manufactures a complete line of raster scan CRT display units for the computer industry. HDM SERIES: Ultra fine resolution analog display units (color). CD SERIES: High performance analog (CDA) and digital (CDB) models. UD SERIES: Quality color display units for office graphics at economical cost. BDM SERIES: Low cost monochrome units for data entry and on-line applications.

### Booth 2217 **IKONAS GRAPHICS SYSTEMS**

531 Pylon Drive  
Raleigh, NC 27606  
(919) 848-8701  
**\*MARY C. WHITTON**  
Vice President-Marketing

Ikonas RDS-3000 Raster Display System for high performance graphics and image processing applications. Fast programmable bit-slice graphics generator providing real-time 2D and 3D transformation, vector, and surface generation. Multi-format display capability including 512 x 1280 pixel resolution. Expandable image memory from 2 bits (4 colors) to 24 bits

(16 million colors) with 512 x 512 to 2048 x 2048 storage. Auxiliary 68000 microprocessor for workstations and stand-alone capability.

Booth 2739 **IMAGE DYNAMICS INC.**

**150 Riser Road  
Teterboro, NJ 07608  
(201) 288-7670  
RON ARONOWITZ  
Engineering Group**

**User Group Contact:  
CHING-YUAN TUNG  
Engineering Group**

Our new IRIS-1 is a high performance real-time 3D to 2D, smooth shaded, full color, visible surface graphics hardware system. For each frame update (30/sec.) 3D transformation and perspective work, along with hidden surface solution, is performed on the objects in the scene, at a resolution of 640 x 480 pixels. Image complexities of between 10,000 and 15,000 edges can be solved for in real-time, including fog, shiny surfaces, and intersections. The system will also operate out of real-time for images of unlimited edge complexity. An image with 1/4 million edges can be solved for in one second.

Booth 2929 **IMAGING TECHNOLOGY, INC.**

**61 N. Broadway  
Salem, NH 03079  
(603) 893-6415  
ROBERT WANG  
Director**

Imaging Technology manufactures high performance image processing and computer graphic sub-systems for the OEM vision market. All modules accept and display either computer generated graphic commands or video image input from a standard camera. Optional high-speed ALU processor facilitates real-time image summation, subtraction, animation and con-

## Exhibitor Listing

volution. The resolutions of the imaging modules vary from 256 x 256 x 4 for the low end, and up to 4K x 4K addressable memory space with 32 bits per pixel. Screen manipulations include pixel pan, scroll, zoom, write mask and pixel area write protect function. The modules are plug compatible with Intel Multi-bus or Dec Q-bus based mini-computers.

### Booth 2210 **IMLAC CORP.**

**150 A Street  
Needham, MA 02194  
(617) 449-4600  
JOHN A. DESJARDINS  
Director of Sales**

Imlac manufactures the Series II Model 8000 refresh stroke vector computer terminal. The Series II, an 8086-based smart terminal, provides the user with up to 192K bytes of memory for the storage of graphics data. Graphics input/output services include a Light Pen, a Data Tablet and an Interface to the Versatec line of dot Matrix Printer Plotters. Host communication is via an RS-232 line, with speeds up to 19.2K baud. The host load is minimized with terminal control program. The Series II is supported on many host computers and by several CAD/CAM software packages.

### Booth 2338 **INDUSTRIAL DATA TERMINALS**

**173 Heatherdown Drive  
Westerville, OH 43081  
(614) 882-3282  
FRANK MAGALSKI  
Vice President-Marketing**

**User Group Contact:  
TERRY BOWEN  
Marketing Support Specialist**

Industrial Data Terminals manufactures the first and only color graphics terminal with bubble memory. The IDT-2200 with bubble memory storage in the terminal, establishes a new standard in color graphics capability and reliability. Non-volatile bubble memory allows you to retain permanent displays in the terminal, and ensures data integrity even in the harshest environment. The IDT-2200 uses a subpicture architecture which permits rapid display and change of total pictures and/or segments with a single command.

Booth 3009 **INFOGRAPHICS, INC.**

**Lido Peninsula, 201 Shipyard Way  
Newport Beach, CA 92663  
(714) 675-4385  
DR. STEPHEN SLINGSBY  
President**

InfoGraphics will display its new turnkey business color graphics system. This new system will provide a total graphics capability for corporations as well as a data base capability for the chief executive officer and other policy decision makers in a company.

Booth 1740 **INTEGRATED TERMINALS/  
DIVISION OF TELPAR, INC.**

**4132 Billy Mitchell Road/Box 1184  
Addison, TX 75001  
(214) 233-6631  
GLEN E. ALCORN  
Products Marketing Director**

Integrated Terminals will exhibit its line of Color Graphic Terminals which utilizes a 12" high resolution in-line gun color CRT to display 24 80-character lines. Eight colors are selectable on a foreground/background combination. In addition to the standard 96 ASCII character set, there are 128 user defined symbols available. The terminal interfaces via RS-232 or current loop at up to 9600 baud to a host computer. Editing features include line insert/delete,

## Exhibitor Listing

character insert/delete, erase page, scroll/page mode, and block transmit/receive. Display attributes include double high/double wide characters, blink, underline, and blank. All editing and attributes are implemented using control/escape sequences from the host computer.

### Booth 2103 **INTELLIGENT SYSTEMS CORP.**

**225 Technology Park/Atlanta  
Norcross, GA 30092  
(404) 449-5961  
TULLY JOHNSTONE  
Marketing Operations Manager**

Founded in 1973, Intelligent Systems is the world's leading producer of low-cost color graphics desk top computers, terminals and software, including: (1) Intelligent Graphic Systems™ (IGS™), the most powerful color graphics language available on microcomputers; IGS can be purchased in terminals, desk tops or graphics stations. (2) Color graphics desk tops with up to 128K RAM, CP/M™ or FCS OS. (3) 8-color intelligent graphics terminals, plus emulators for VT100, 3270, 4014, ANSI. (4) 8-color monitors. (5) I/O: keyboard, digitizer, light pen, ink-jet printers (paper, foils), plotters (paper, foils), color cameras (35mm slides, Polaroids, film transparencies).

### Booth 1142 **INTERACTIVE MACHINES, INC.**

**2500 B Townsgate Road  
Westlake Village, CA 91361  
(213) 707-1880  
GEORGE SEMERAU  
President**

**User Group Contact:  
JOE EDWARDS  
Chief Executive Officer**

Manufacturer of high performance graphics workstations, 4096 x 4096 calligraphic monitors, both 21" black and white, and 19" shadow mask color. High speed graphics processor, using



multiple bi-polar bit slice microprocessors, with 3D rotate, scale, displace, perspective, clip, and user defined transformations. Local 68000 with 20 meg Winchester 512K RAM, running Unix with C and Fortran '77. Extensive graphics utility software. Interfaces include DMC-11 (VAX), Mil-STD-1553, IBM 3274, RS-232.

**Booth 2728 INTERNATIONAL IMAGING SYSTEMS**

**1500 Buckeye Drive  
Milpitas, CA 95035  
(408) 262-4444  
M. MICHAEL STROZZA  
Director of Sales**

International Imaging Systems (I<sup>2</sup>S) is engaged in the field of image analysis and enhancement, with primary applications in earth resource studies, aircraft reconnaissance, medical, non-destructive testing, radio astronomy, graphic arts and process control. I<sup>2</sup>S offers a wide range of digital image processing displays and systems, including CPU interfaces and applications programs. I<sup>2</sup>S is featuring the System 500 which is a turnkey image processing system with a library of more than 125 applications programs for various image processing functions. The company is unique in being able to offer both hardware and an applications software library that is manufactured and supported by a single vendor.

**Booth 1022 ISSCO GRAPHICS**

**4186 Sorrento Valley Blvd.  
San Diego, CA 92121  
(714) 452-0170  
ELLEN GORE  
National Marketing Coordinator**

**User Group Contact:  
MAXINE BROWN  
Manager, Marketing Communications**

DISSPLA<sup>™</sup> and TELL-A-GRAF<sup>™</sup> are today's leading graphic software packages for the creation of publication and presentation quality



## Exhibitor Listing

charts. TELL-A-GRAF™ is an English-language application program that produces general purpose line, bar and pie graphs and text pages. DISSPLA™ is a library of high-level graphic subroutines that produce general purpose charts and graphs, 3-D surfaces, maps and contours. ISSCO products feature ease-of-use, flexibility, field-proven performance, comprehensive maintenance and support, and machine and device independence. Both systems have broad application in business, science and engineering industries.

Booth 2521 **JAPAN RADIO CO., LTD.**

120 E. 56th Street/Suite 320  
New York, NY 10028  
(212) 355-1180  
(81) 422-44-9111 (Tokyo)  
TAD HAYASHI  
U.S. Representative

User Group Contact:  
S. SAIMI  
General Manager, Tokyo

Japan Radio is exhibiting their NWX-235 20" Color Graphic Display with a host computer (PDP-11 or Prime). This Display Terminal is capable of presenting characters, graphics and images with high brilliance and high resolution in multi-layer, multi-color, split and echo modes on the CRT screen. It features powerful interactive capabilities such as picking, rubber-band and dragging, window-viewport conversion, clipping and 2-dimensional transformations (zooming/scaling, scrolling, rotation). This model can operate as a dedicated processing workstation for CAD/CAM systems using general purpose computers or minicomputers.

Booth 2321 **JOYCE LOEBL/DIVISION OF VICKERS INSTRUMENTS, INC.**

300 Commercial Street/Box 99  
Malden, MA 02148  
(617) 324-0350

**JOHN MORRISSEY**  
**Manager, Marketing & Sales**

Joyce LoebI Div. will exhibit its line of image digitizers, image analysis equipment and microdensitometers. The Magiscan 2 signal processor will be introduced, an OEM high speed array processor used in image manipulation and processing of raster data.

Booth 2625 **JUPITER SYSTEMS, INC.**

**2126 Sixth Street**  
**Berkeley, CA 94710**  
**(415) 644-1024**  
**PETE HARRIS**  
**Vice President**

**User Group Contact:**  
**JON PEDDIE**  
**President**

Jupiter Systems offers a family of color graphics raster terminals with high resolutions, 256 simultaneously displayable colors and detachable keyboards. A 768 x 575 pixel terminal, "Jupiter 7", priced comparably to 512 x 512 terminals, will be exhibited. "Jupiter 12", a new terminal with 1280 x 1024 pixel resolution, will be introduced. All Jupiter terminals include firmware for anti-aliasing of deJagged vectors. Detachable keyboard has 32 user definable keys, a hexadecimal keypad and twin joysticks for independent pan, scroll and zoom. Much commonly available applications software operates on Jupiter terminals.

Booth 2418 **KMW SYSTEMS**

**8307 Highway 71 W.**  
**Austin, TX 78735**  
**(512) 288-1453**  
**FRED KLINGENSMITH**  
**Vice President-Marketing**

KMW will feature its new VP-30 Vector Processor for Electrostatic Plotters as well as our Protocol Converters for Pen Plotters and CRTs.

## Exhibitor Listing

### Booth 1129 **J.M. LANCASTER, INC.**

125 Irving Street  
Framingham, MA 01701  
(617) 875-8893  
**JOHN LANCASTER**  
**President**

Exhibiting with Houston Instrument/Bausch & Lomb Instruments & Systems Div.

### Booth 2421 **LANG SYSTEMS, INC.**

1392 Borregas Avenue  
Sunnyvale, CA 94086  
(408) 734-3332

VIDEOSLIDE 35 offers a quick and low-cost way to generate 35mm slides of images generated on color raster terminals or with personal computers systems such as IBM 5150 and Apple II and III. The product accepts Video input format, including RGB RS-170, NTSC, TTL RGB and others. VIDEOSLIDE 35 is connected to video output or in parallel with the monitor used by the operator. Controls for the table top unit consist of an on-off switch, three thumb-wheel switches for color balance and an exposure time control. Additional software is not required for operation. VIDEOSLIDE 35 accepts conventional 35mm film and developing may be performed by any commercial photographic processor.

### Booth 1122 **LEXIDATA CORP.**

755 Middlesex Turnpike  
Billerica, MA 01865  
(617) 663-8550  
**\*JOYCE M. ANDERSON**  
**Marketing Communications Specialist**

Lexidata manufactures families of medium to high resolution raster display systems used in interactive computer graphics and imaging. The company's display systems operate as intelligent peripheral devices attached to host minicomputers which drastically reduce the host

computer time and memory overhead required to perform picture display and image manipulation functions. Lexidata will exhibit its System 3400 display processors; the System 8000 family of distributed graphics products; and the System 2000 family of intelligent, high performance, low cost graphics display terminals.

Booth 1416 **LOGETRONICS INC.**  
7001 Loisdale Road  
Springfield, VA 22150  
(703) 971-1400  
**LYN CAMERON**  
Manager, Market Planning

**User Group Contact:**  
**RAY LUCA**  
Director of Corporate Marketing

The newly-formed Computer Imaging<sup>1</sup> Group of LogEtronic includes four subsidiaries exhibiting at SIGGRAPH '82. LogE/Interpretation Systems Inc. specializes in systems for remote sensing applications, particularly for geophysical exploration and military intelligence operations. LogE/Spatial Data Systems manufactures products for the non-destructive testing, biomedical research and medical radiography fields. LogE/Dunn Instruments Inc. produces cathode ray tube cameras for computer-generated images, specializing in medical radiography, remote sensing and business graphics applications. LogE/CompuSlide Inc. markets computerized systems for graphic presentation and analysis of business data.

Booth 2708 **LUNDY ELECTRONICS & SYSTEMS, INC.**

One Robert Lane  
Glen Head, NY 11545  
(516) 671-9000  
**RAY MALONEY**  
Computer Graphic Marketing Manager

**User Group Contact:**  
**KAMIL BAJIN**  
Product Support Manager

## Exhibitor Listing

Lundy Electronics & Systems will be exhibiting the UltraGraf™ Interactive Graphics Design Workstation and the T5684 Color Raster and T5470 Super Resolution Monochrome Raster Graphics Terminals. The UltraGraf™ consists of a vector refresh graphics display containing its own microprocessor and dynamic refresh memory. It offers a 4K x 4K screen resolution and 32K x 32K x 32K virtual map. The T5684 offers 16 colors from a palette of 4096, 768 (X) by 512 (Y) pixel display, 64K bytes of memory, scrolling text store, and a wide variety of drawing styles. The T5471 has a 1536 (X) by 1024 (Y) pixel display and offers the same features as the T5684 except for color.

Booth 2818 **MacDONALD DETTWILER  
AND ASSOCIATES, LTD.**

3751 Shell Road  
Richmond, British Columbia, Canada V6X 2Z9  
(604) 278-3411  
**DAN MURRAY**  
Marketing Representative

**User Group Contact:**  
**DAVE NIMS**  
Program Manager

MacDonald Dettwiler and Associates (MDA) manufactures a line of high speed, precision digital film recorders for both black and white and color applications. On display will be the Color FIRE 240, using Electoprism technology to produce color images on 240mm (9½") roll film. Also displayed will be samples of imagery produced by the unit.

Booth 1528 **MATRA DATAVISION, INC.**

99 S. Bedford Street  
Corporate Place I  
Burlington, MA 01803  
(617) 229-2630  
**LUCIEN E. COENEN**  
National Sales Manager



**User Group Contact:**  
**ROBERT H. KREVEY**  
**Vice President-Technical Operations**

Matra Datavision sells, supports and enhances the EUCLID solid geometry modeling and CAD/CAM software system. This advanced system for mechanical design, manufacturing, and architectural/construction engineering has been in production use in Europe for over two years and is installed in over 50 sites. It is now offered in North America to provide a new generation of CAD/CAM capability, based on the use of true 3-dimensional modeling.

**Booth 2426    MATRIX INSTRUMENTS INC.**

**2525 Maricopa Street**  
**Torrance, CA 90503**  
**(213) 320-8334**  
**ART SHUFELT**  
**Vice President-Color Graphics**

Quick Color Recorder (QCR): The new Matrix QCR incorporates a digital computer software approach to computer color graphic film re-recording. MODEL 3000: The Matrix Model 3000 Color Graphic Recorder is a compact, desk top, rack mountable, mobile hard copy device that records information in brilliant, high-resolution, full color from the output of any color raster scan computer terminal. MODEL 4007: The Matrix Color Graphic Recorder Model 4007 is a stand-alone peripheral hard copy device that records information from any color raster scan terminal in brilliant high resolution, full color onto a wide variety of film media.

**Booth 2124    MATROX ELECTRONICS SYSTEMS**

**5800 Andover Avenue**  
**T.M.R., Montreal, Quebec, Canada H4T 1H4**  
**(514) 735-1182**  
**ED DWYER**  
**Sales Manager**



## Exhibitor Listing

### User Group Contact:

**JOSEPH DABBY**

**Applications Engineering Manager**

Matrox manufactures microcomputer and computer graphics boards and systems. Video products are available for Multibus, LSI Q-BUS, STD-BUS, UNIBUS, S-100, and EXORCISOR. At SIGGRAPH '82, Matrox will be displaying its new color video board set, RGB-ALPHA and RGB-GRAPH, and VAF-512, which provide 512 x 512 x 4 graphics, alphanumeric overlay, and video digitizing. The GT-600 graphics upgrade card for DEC VT-100 terminals will also be featured.

Booth 2322 **MATSUSHITA COMMUNICATIONS INDUSTRIAL CO., LTD.**  
**(Panasonic, Secaucus, NJ)**

**Tshashima-higashi, Kohuku-ku**

**Yokohama, Japan 223**

**(201) 348-5304**

**FRANK YAMANAKA**

**Marketing Manager**

### User Group Contact:

**STEVE YUHAS**

Matsushita Communications Industrial will exhibit a new type of LOGIC ANALYZER model VP-3620A, which has a microprocessor development function. Unique in this instrument is its error detecting and logic circuits, and the analyzing of the state and timing sequences. This greatly facilitates the microprocessor development function. A new intelligent X-Y PLOTTER will also be exhibited, model VP-6801A. It features a high speed, six color, continuous recording plotter with a versatile interface. The unit's design is certainly innovative, featuring a plotting speed of 200mm/sec; a resolution of 0.1mm; a plotting area of 230mm by 180mm and the availability of six felt pens.

Booth 1303 **MCI/QUANTEL**

**2483 E. Bayshore Road/Suite 100**  
**Palo Alto, CA 94303**  
**(415) 856-6226**  
**N. BUD SCHNEIDER**  
**Marketing**  
**GEORGE A. GRASSO**  
**President**

MCI/Quantel manufactures and markets a wide range of digital video products for broadcast use and for scientific/industrial applications. Broadcast products on exhibition include: the Paint Box, a digital graphics/paint/character generation/animation system; and the DLS 6000 series digital library system for storage and replay video still pictures. Scientific/industrial products include the Intellect 100 image processing system and the Intellect 100 PDS program development system. Intellect 100 is capable of picture capture, enhancement, analysis, annotation, storage and retrieval. It combines the immediacy of a continuously optimized image with the power of computer analysis and manipulation.

Booth 1643 **MEASUREMENT SYSTEMS INC.**

**121 Water Street**  
**Norwalk, CT 06854**  
**(203) 838-5561**  
**DONALD W. FISHER**  
**Sales Engineer**

Measurement Systems manufactures a line of positioning and tracking controls. They include joysticks, trackballs and force operated controls which are available with analogue, pulse or coded digital output, either parallel or serial RS-232.

## Exhibitor Listing

### Booth 1008 **MEGATEK CORP.**

3985 Sorrento Valley Blvd.  
San Diego, CA 92121  
(714) 455-5590  
**SUSAN HARTWIG-HOOD**  
Manager, Marketing Communications

**User Group Contact:**  
**GARY WASHAM**  
Director, Product Marketing

Megatek produces a complete line of high-speed stroke-refresh and raster color graphic systems. Units on display: WHIZZARD® 7210, 21", full refresh display with 4096<sup>2</sup> resolution. WHIZZARD® 6245, 19", monochromatic display, 1024<sup>2</sup> resolution. WHIZZARD® 7250, 19", 16 color display, 512<sup>2</sup> resolution. WHIZZARD® 7255, 19", 16 color display, 1024<sup>2</sup> resolution. WHIZZARD® 7600, color raster system with local intelligent interface and 3-D surface processor. WAND™ software supports all Megatek systems. TEMPLATE™, device independent, high-level software.

### Booth 2024 **METHEUS CORP.**

Box 1049  
Hillsboro, OR 97123  
(503) 640-8000  
**SAM BOSCH**  
Director of Marketing & Sales

**User Group Contact:**  
**GARY ROMANS**  
Marketing Manager, Graphics Systems

The 400™ Display Controller offers a price/performance breakthrough for color raster graphics by providing drawing speeds of 1 million pixels/second. A patented memory architecture allows the use of 64K RAMs to achieve the drawing speed, while allowing single board construction for reliability. Other features include 16 million pixel/second rectangle fill, PIXBLT™ hardware instruction for pixel block moves, 4 or 8 bit planes with a

16.7 million color palette, on-board signature analyzer and self-test microcode, and the AXIA<sup>™</sup> Graphics Package, a CORE compatible, FORTRAN graphics utility library.

Booth 2703 **MINI-MICRO SYSTEMS**

**221 Columbus Avenue  
Boston, MA 02116  
(617) 536-7780  
RICHARD DALRYMPLE  
Director of Marketing**

**User Group Contact:  
SUSAN RAPPAPORT  
Promotion Director**

Mini-Micro Systems is edited for both OEM systems personnel who design and/or apply mini-microcomputer related equipment in their systems and sophisticated end users configuring their own mini or micro systems. Coverage includes applications for minicomputers, microcomputers, memory systems, peripheral equipment, data communications, distributed data processing and other mini-based systems.

Booth 2017 **MODGRAPH, INC.**

**1393 Main Street  
Waltham, MA 02154  
(617) 890-5764  
HENRY R. KUNICKI, JR.  
Marketing Manager**

G-100 Graphics Terminal. 768 x 585 resolution with independent alphanumerics overlay, 15" screen, P-39 green phosphor, ANSI x 3.64 compliance, and PLOT-10 compatibility. V-100 Color Graphics Camera provides high resolution color film output from most RGB display systems. Film formats include 35mm, Polaroid 4 x 5, SX-70, and 8 x 10. GVD-02 Graphics Generator is a family of low cost modular graphics boards with resolution from 256 x 256 to 512 x 512 for monochrome or grey scale or color display. Optional look up tables, light pen, frame grabber, and digitizers.

## Exhibitor Listing

Booth 3006 **MONITERM CORP.**

7180 Shady Oak Road  
Eden Prairie, MN 55344  
(612) 941-8383  
**WARD C. JOHNSON**  
President

High resolution CRT Monitors. Full page non-interlaced displays for office automation. 1024 x 1024 non-interlaced display for CAD/CAM and Computer Aided Graphics.

Booth 2337 **MOSTEK CORP.**

1215 W. Crosby Road  
Carrollton, TX 75006  
(214) 466-6000  
**FRANK HOPE**  
Graphics Marketing

United Technologies' Mostek Corp. is adding raster graphics to its systems product offerings. The MK8401 (640 x 512) and MK8402 (1280 x 1024) systems offer 256 colors from a palette of 16.8 million colors and high-functionality software based on the SIGGRAPH Core Standard. The two systems also feature a high-performance pipeline multiprocessor display based on the 68000 processor, VMEbus architecture, two additional bit slice processors and double-buffered pixel memory. The VMEbus and board architecture permits customers to easily configure systems to their specific requirements. The MK8401 can be upgraded to an MK8402 simply by adding two more pixel memory boards.

Booth 1236 **NICOLET ZETA CORP.**  
Booth 2232

2300 Stanwell Drive  
Concord, CA 94520  
(415) 671-0600  
**BEVERLY AQUINO**  
Marketing Administrator

Nicolet Zeta manufactures a full line of high performance intelligent drum plotters. Featured



among the equipment to be shown will be the new ZETA 8, an 8-pen desk top plotter. Also the latest addition to our larger plotters, the ZETA 3610, 36" drum plotter. All Zeta plotters feature the most advanced microprocessor based controller in the plotter industry. We also utilize continuous feed paper, keeping operator intervention to a minimum.

Booth 1808 **NISSEI SANGYO AMERICA, LTD.**

**40 Washington Street  
Wellesley Hills, MA 02181  
(617) 237-9643  
KEVIN BOWLER  
Marketing Manager**

**User Group Contact:  
DOMINIC CUCE**

Hitachi medium-high resolution color display monitors. Low cost TTL and analog color monitors for use in color graphic systems and terminals. Nine different models will be shown, ranging from 560 x 240 resolution to 720 x 416 resolution, using 13" as well as 19" picture tubes.

Booth 2838 **NORPAK LIMITED**

**10 Hearst Way  
Kanata, Ontario, Canada K2L 2P4  
(613) 592-4164  
PETER ENGLER  
Marketing Manager**

Norpak develops, engineers, manufactures and markets a range of color graphics display terminals and associated digital electronic hardware. Its products include interactive computer graphics and image processing systems, ranging from very high resolution visual data processors to products designed for the general consumer. Norpak is a principal developer and major manufacturer of videotex system hardware. Norpak products implement the North American videotex standard (AT&T/PLP). Norpak designs and manufactures systems for



## Exhibitor Listing

educational applications, process control and computer-aided design systems for industrial and commercial use, including the Super-VISION workstation for CAD/CAM applications. Norpak also owns Hemton Corp., which offers page creation services and electronic projection systems.

### Booth 2705 **NUMONICS CORP.**

**418 Pierce Street  
Lansdale, PA 19446  
(215) 362-2766  
\*ERIC A. DOERRER  
Sales Manager**

Numonics manufactures a complete line of free-cursor and restrained cursor digitizers for the OEM and the end user. MODEL 2300: competitively priced digitizer/tablet for large-volume users and single-unit users with their own graphics software. MODEL 2400: application-oriented digitizer/tablet with area, length and an extensive application program library. MODEL 1224: multi-function graphics analyzer with area, length and digitizing capability for any material on any surface. Also with an extensive program library. MODEL 5400: competitively priced microprocessor-based plotter with ASCII control commands. Embossed roller design for low-inertia paper transport, producing exceptionally high line quality.

### Booth 1815 **OCLI/OPTICAL COATING LABORATORY, INC.**

**2789 Northpoint Pkwy.  
Santa Rosa, CA 95401  
(707) 525-7441  
BOB CARLSON  
Sales Manager, Display Products Div.**

OCLI's Display Products Div. will exhibit their visual display products and coatings which improve the viewability of CRT terminals by enhancing contrast and minimizing glare without degrading resolution.

Booth 1821 **OCTEK INC.**

**7 Corporate Place, S. Bedford Street  
Burlington, MA 01803  
(617) 273-0851  
SUSAN S. SOLOMON  
Manager, Market Development**

Octek will exhibit its real time Image Analysis Processor which includes an extensive library of Fortran subroutines to provide complete control over processing functions. The micro-coded instruction set provides versatile programs for numerical and connectivity analysis, vector summation, graphics partitioning and windowing, DMA transfers or whatever your requirements demand. The Machine Vision Module (MVM) can dramatically expand applications for your robot manipulators to analyze object orientation; count holes; measure size, area, perimeter and distance along major and minor axes, in addition to comparing an object feature with a standard object.

Booth 2638 **OPTRONICS INTERNATIONAL, INC.**

**7 Stuart Road  
Chelmsford, MA 01824  
(617) 256-4511  
TIM DODKIN  
Eastern Regional Manager**

**User Group Contact:  
JIM DEIGAN  
Technical Manager**

Optronics International, a leading manufacturer of image processing systems, offers a complete line of scanning microdensitometers and film plotters. Not only can Optronics systems digitize, enhance, manipulate and reconstruct imagery at high speeds with high resolution, but they can also accept formats from 10" x 10" to 40" x 40" in black and white or color. They offer sequential pass color separation capability, data compression, halftone screening and tone panel generation. Applications include remote sensing, cartography, medical and industrial radiography, non-destructive testing, CAD/CAM and P.C. board artwork generation.

## Exhibitor Listing

### Booth 2817 **ORCATECH INC.**

2680 Queensview Drive  
Ottawa, Ontario, Canada K2B 8H6  
(613) 820-9602  
**JOHN E. LUGSDIN**  
Director of Marketing

Orcatech will be exhibiting for the first time its range of Computer Graphics Systems. The Orcatech series of graphic computer products represents a new solution to many problems faced by users. The products combine the fastest of high resolution raster graphics with the application processing power to handle even the most demanding user program. All this hardware power is made usable through a complete software development and run-time environment specifically designed to reduce the cost of major program development.

### Booth 1618 **PANASONIC INDUSTRIAL COMPANY**

One Panasonic Way  
Secaucus, NJ 07094  
(201) 348-5278  
**NICK DeGAETANO**  
Product Specialist

User Group Contact:  
**MARGE LOPEZ**  
Sales Correspondent

Panasonic will feature: high performance cathode ray tubes; high resolution color CRTs with in-line and delta guns; high density dot masks and optional ergonomic features; high resolution monochrome CRTs capable of displaying 2000 x 2000 dots.

### Booth 2122 **PERITEK CORP.**

5550 Redwood Road  
Oakland, CA 94619  
(415) 531-6500  
**PAT MARKOVICH-TREECE**  
Marketing

**User Group Contact:**  
**TOM BIRCHELL**  
**President**

Peritek manufactures performance-oriented hardware and software products for adding-in or adding-on to systems which use the popular Q-Bus. Available for viewing is the company's line of color and monochrome raster graphics interfaces and high-speed multi-processor links, Winchester disk storage, color and monochrome monitors, display terminals, accessory keyboards, and other items related to raster graphics applications. Peritek addresses the OEM and quantity end-user with its line of modular, add-in assemblies and also offers custom intelligent display systems for turnkey users configured from standard components.

**Booth 1724 PHOENIX COMPUTER GRAPHICS, INC.**

**119 Board Road**  
**Lafayette, LA 70508**  
**(318) 234-0063**  
**STEVE BLANKENSHIP**

**User Group Contact:**  
**ELLIOTT M. BOUILLION**  
**Vice President**

Phoenix Computer Graphics designs and manufactures color graphic display systems for business, industry and engineering applications. In addition to the Raster 640 color graphic computer terminal with peripherals that include floppy disks, digitizers and hard copy devices, Phoenix will announce that "The Legend Lives" at SIGGRAPH '82, with the introduction of the newest color graphic system, the Phoenix 1024.

**Booth 2524 PHOTONICS SPECTRA**  
**(Formerly OPTICAL SPECTRA)**

**Berkshire Common**  
**Pittsfield, MA 01201**  
**(413) 499-0514**

## Exhibitor Listing

**JOSEPH BURKE**  
**JACK FERGUSON**  
**BILL McCUE**  
**Sales Representatives**

The international magazine for the photonics technology, covering optics, electro-optics, lasers, fiber optics and vacuum technology. Circulation of over 37,000 is distributed monthly to scientists, engineers, designers and managers involved in this technology. Includes 21 monthly departments, plus special feature articles.

### Booth 2837 **PHOTONICS TECHNOLOGY**

**Box 432**  
**Luckey, OH 43443**  
**(419) 666-0033**  
**\*DONALD K. WEDDING, SR.**  
**Vice President-Marketing**

Photonics Technology manufactures standard and custom size display terminals, including the world's largest non-projected display — a flat, 1/2-inch thick, transparent, meter-diagonal, AC gas discharge (plasma) display panel with a viewing area of over 5.3 square feet and a resolution of over 2500 pixels per square inch. Smaller area displays range in size from a few centimeters up to one meter. Larger displays up to three meters are being developed. Display resolutions range up to 10,000 pixels per square inch or more.

### Booth 2402 **POLAROID CORP.**

**549 Technology Square**  
**Cambridge, MA 02139**  
**(617) 577-2000**  
**JIM HARTNETT**

Polaroid is introducing a new line of film recording systems utilizing tri-color video photography to produce high quality instant hard copy from color computer graphics systems. Output media include: Color overhead projection transparencies in 8" x 10" format;



reflective color prints in 8x10, 4x5 and SX-70 formats.

**Booth 2222 POLHEMUS NAVIGATION SCIENCES, INC.**

**Box A, River Road  
Essex Junction, VT 05452  
(802) 879-6547  
E.B. BLOOD  
Director of Special Projects**

Polhemus Navigation Sciences introduces a unique three-dimensional digitizer. The digitizer is a true six degree of freedom measurement device which allows the user, with a held stylus, to determine the X, Y, Z coordinates of a point located on a non-conductive, three-dimensional model. This data, along with the orientation of the stylus, is immediately available for computer usage. Initially developed to provide a fast, error-free means of digitizing models for a computer generated imagery data base, the digitizer can be used to digitize engineering models, collect dimensions from piping and plant layout models and provide position and orientation input for animation.

**Booth 2423 PRECISION/ECHO**

**485 E. Middlefield Road  
Mountain View, CA 94043  
(415) 961-7145  
PAUL R. INSCO  
National Sales Manager**

Precision/Echo offers a full line of magnetic video disc recorders. The Image Maker records up to 512 full frames of color video signal with random access, variable speeds, variable endless loops and sequences, bi-directional playback. It is capable of a variety of playback manipulations for image analysis and animated sequence building. Playback speeds vary from real time to freeze frame. Custom computer interfaces available. The Frame Bank records 400 full video frames on an interchangeable flexible disc cassette allowing archiveable frame



## Exhibitor Listing

storage. Random access available from remote control. Custom computer interfaces available.

### Booth 1135 **PRECISION VISUALS, INC.**

250 Arapahoe Avenue  
Boulder, CO 80302  
(303) 449-0806  
**STEVEN J. FREDRICKSON**  
Director of Sales

**User Group Contact:**  
**SCOTT ALLMAN**  
Director of Customer Services

Precision Visuals develops, markets and supports general purpose, device and machine independent graphics software tools. Products include: DI-3000, a "toolbox" of Fortran-callable graphics subroutines based on the CORE System Graphics Standard; GRAFMAKER, a package of user-callable subroutines for high-level data presentation; Contouring, a 3D-display package for gridding randomly positioned data and generating contour maps; Metafile Translator, a "time independent" picture editor; and a new user friendly, menu driven interface to GRAFMAKER (to be introduced at SIGGRAPH '82).

### Booth 2917 **PRINTACOLOR CORP.**

5965 Peachtree Corners E.  
Norcross, GA 30091  
(404) 448-2675  
**DAN BYFORD**  
Public Relations Director

**User Group Contact:**  
**RAYMOND A. KEITHLEY**  
Marketing Manager

PrintaColor manufactures a complete line of ink-jet color hardcopy devices for use with a variety of color graphics computers and terminals. These models — including the GC8000, IS8001, HR8002, GP1024 and a modular system for OEMs — operate either on a

character addressable or dot addressable basis. All models incorporate three basic inks and overlay to get seven colors, plus white (paper). Interfaces are available for graphics computers manufactured by Intelligent Systems, Chromatics, IBM, Apple and others. All models interface via RS-232C or Centronics-compatible I/O ports.

Booth 2526 **QUADRAM CORP.**

**4357 Park Drive  
Norcross, GA 30093  
(404) 923-6664  
LELAND STRANGE  
Vice President**

Manufacturer of: MICRO-COLOR low cost graphics processor with the capability of generating 512 x 512 points and a 64 color palette on medium resolution monitors. OMEGA DATA MX-700 series video terminal display of 66 lines with 160 characters per line. PLOT-10 graphics compatibility. OMNIColor ink-jet color printer system for popular microcomputers (IBM, Apple II, Apple III). INTERFAZER intelligent controller/buffer for sharing (up to 8 CPUs) and spooling (up to 128K) printers or plotters. MICROFAZER printer buffers and converters. Parallel-to-parallel, parallel-to-serial, serial-to-parallel and serial-to-serial buffers of 8K to 256K. QUADBOARD and other peripheral boards for the IBM and Apple personal computers.

Booth 2624 **QUALITY MICRO SYSTEMS, INC.**

**57 S. Schillinger Road  
Mobile, AL 36608  
(205) 343-2767  
JACK MEYERS  
Distribution Sales Manager**

Quality Micro Systems (QMS) will exhibit several line printer controllers and will demonstrate the ease of creating business graphics such as bar codes, variable size characters, reverse imaging, shading, lines, boxes, forms, logos,

## Exhibitor Listing

industrial labels, etc., with QMS products. QMS will also demonstrate the ability to interface with a wide variety of different computer systems, including IBM, Honeywell, Hewlett-Packard, Wang, Prime, NCR, Burroughs, DEC, and many others. Printers to be displayed include the following: an intelligent high speed laser printer, a Printronix printer, and an NEC letter quality printer.

### Booth 1612 **RAMTEK CORP.**

**2211 Lawson Lane**  
**Santa Clara, CA 95050**  
**(408) 988-2211**  
**CHERYL LANDMAN**  
**Manager, Corporate Communications**

Ramtek will display a complete line of raster scan color graphics and imaging displays and color hard copy devices, including: (1) 9400 Series Graphics and Imaging Display Systems, with resolution to 1280 x 1024. (2) 6000 Series Colorgraphic Terminals, featuring the 6211 Colorgraphic Terminal. A low cost desk top terminal with resolution up to 640 x 480. (3) 4100 Colorgraphic Printer. Full color dot matrix printer with separate printheads and re-inking cartridge ribbons for high-quality, inexpensive plain paper hardcopy.

### Booth 2508 **RASTER TECHNOLOGIES**

**9 Executive Park Drive**  
**North Billerica, MA 01862**  
**(617) 667-8900**  
**STEPHEN E. COIT**  
**Director of Marketing**

Raster Technologies will be exhibiting new members of the MODEL ONE family of compatible graphics display systems. All members of the MODEL ONE family feature a powerful multiple-processor architecture and advanced graphics capabilities for excellent picture quality and superior interactive graphics performance. The MODEL ONE line supports a wide variety of applications, including CAD, solid modeling,

presentation graphics, seismic and earth resources imaging and medicine.

Booth 2622 **RECOGNITION CONCEPTS, INC.**

924 Incline Way/Box 8510  
Incline Village, NV 89450  
(702) 831-0473  
**RICHARD PIZZA**  
Vice President

**User Group Contact:**  
**HARRY AINE**  
Senior Systems Analyst

Manufacturer of Real-Time Image Processing Systems featuring single or multi-channel image display resolutions from 256 x 256 to 1024 x 1024 x 16 bits.

Booth 2632 **RUBEL SOFTWARE/A DIVISION OF  
ANDREW RUBEL & ASSOCIATES, INC.**

One Soldiers Field Park 605  
Boston, MA 02163  
(617) 876-7993  
**NANCY ZAWADZKI**  
Marketing Manager

**User Group Contact:**  
**EVE GOLDFARB**  
Product Manager

Rubel Software provides BLOX (™ applied for) software tools. Demonstrated at SIGGRAPH '82 will be BLOX Graphics Builder (™ applied for) and BLOX documentation tools. BLOX Graphics Builder creates interactive graphics applications. It includes table driven screen, menu, and finite state interaction control; on-line help facility; and commonly needed graphics and data base functions. Tables are created with an interactive table generator or any text editor. Simple specification format combines custom code with presupplied BLOX functions. Application developers need only write application's "action routines". BLOX Documentation Generator automatically creates help files

## Exhibitor Listing

and formatted documentation. Other BLOX documentation tools are general purpose and available separately.

### Booth 2003 **SAS INSTITUTE INC.**

**Box 8000  
Cary, NC 27511  
(919) 467-8000  
SAS MARKETING DIVISION  
Marketing Representative**

**User Group Contact:  
LAURA M. WHALEN  
Advertising**

SAS Institute will exhibit SAS/GRAPH, a SAS program product that provides device-intelligent color graphics. SAS/GRAPH is used in business and research for presentation and information graphics applications. Several colors, patterns, and font styles can be used for titles, footnotes, and notes. More than 12 procedures are available for plotting; displaying bar, pie, star, and block maps; making slides; and replaying stored results for management presentations. Major graphics devices are supported. SAS/GRAPH users must have SAS; SAS runs on IBM 360/370/30xx/43xx and compatible machines in batch and interactively under OS, OS/VS, VM/CMS, DOS/VSE, and TSO.

### Booth 2922 **SCHERAGO ASSOCIATES, INC.**

**1515 Broadway  
New York, NY 10036  
(212) 730-1050  
RICHARD L. CHARLES  
Executive Vice President-Sales**

**User Group Contact:  
HERBERT L. BURKLUND  
Executive Vice President-Marketing**

Scherago Associates publishes *Computer Graphics News*, and is exclusive advertising sales representative for *Science* and *Engineering Times*.



Booth 2504 **SCIENCE ACCESSORIES CORP.**

970 Kings Highway W.  
Southport, CT 06490  
(203) 255-1526  
**H.A. CLEVELAND**  
Vice President-Marketing

**User Group Contact:**  
**DAVID BLUMSTEIN**  
Regional Sales Manager

Science Accessories manufactures a complete line of 2-Dimensional and 3-Dimensional Graf/Pen Sonic Digitizers. 2-Dimensional Sonic Digitizers include the microprocessor based GP-6 with active area up to 60" x 72" and offer length, area, scale and axis programs, to name a few. The GP-7 GRAFBAR, with an active area of 18" x 24", has the largest digitizing area of any of the low cost digitizers available. The 3-Dimensional digitizer permits digitizing volumes of up to 10' x 10' x 10' and outputs real time XYZ cartesian coordinates. Multiplexer option permits up to 16 different points to be digitized at any one time.

Booth 2117 **SCITEX AMERICA CORP.**

75-D Wiggins Avenue  
Bedford, MA 01730  
(617) 275-5150  
**STEVEN KING**  
Vice President-CAD Systems

**User Group Contact:**  
**DANIEL HERZKA**  
Manager, Applications Engineering

Scitex will be exhibiting a complete Response 250 system consisting of a 36" x 36" scanner, a color editing console, a 40" x 72" laser photoplotter, and supporting computer facilities. Demonstrations will include scanning of monochrome and color engineering graphics, interactive and batch raster/vector editing, raster-to-vector conversion, vector-to-raster conversion, and high-speed laser photoplotting. Applications of the system in cartography,

## Exhibitor Listing

statistical graphics, and engineering graphics will be shown.

### Booth 2608 **SEIKO INSTRUMENTS U.S.A., INC.**

**2620 Augustine Drive/Suite 140  
Santa Clara, CA 95051  
(408) 727-0768  
GRAPHIC DEVICES & SYSTEMS DIV.**

Seiko Instruments will introduce the GR-2212 (monochrome) and the GR-2214 (color) graphic terminals. The terminals combine a 1024 x 780 high resolution raster display with an exclusive twin beam hardware anti-aliasing system. A dual processor architecture supports full 2D interactive capabilities and high speed communications with increased performance. Segment buffer memory of up to 768K bytes allows the users to create and access local picture elements without host intervention. Also available will be the GR-10, GR-12 digitizing tablets and a GR-60 142 dots per inch hard copy output device.

### Booth 1542 **SELANAR CORP.**

**437A Aldo Avenue  
Santa Clara, CA 95050  
(408) 727-2811  
LEE A. AMBROSINI  
Vice President-Marketing/Sales**

**User Group Contact:  
BRIAN P. MURPHY  
National Sales Manager**

Selamar manufactures low cost retrofit graphics enhancements for a variety of alphanumeric terminals, including the VT100 series terminals manufactured by Digital Equipment, C. Itoh's CIT-101, the TeleVideo 925 and 950, and Cobar 3100 and 3132. Selamar's graphics enhancements are field installed and allow the terminal to retain all of its original capabilities while new commands are added to provide graphics capabilities. Selamar's powerful "native" mode which includes a microprocessor-based

vector generator to simplify programming is standard on every board. Tektronix 4010 and 4014 emulation also are available on the graphics boards, as well as friendly, inexpensive software packages to support the native mode. Cross hair cursor and light pen options also are available from Selanar.

**Booth 1722 SKY COMPUTERS, INC.**

**Foot of John Street  
Lowell, MA 01852  
(617) 454-6200  
JOHN A. CARBONE  
Director of Sales**

Sky Computers manufactures a line of floating point array processors for microcomputer systems. These 32-bit high speed processors perform up to 1 million floating point operations per second. Sky offers these systems for the Q-Bus (LSI-11), Multi-Bus (8086) and VersaBus (MC68000). The units plug directly into the host bus and directly access up to 16 megabytes of host memory. Sky supports these "micro number crunchers" with a library of subroutines, callable from a user's application program. SKY MNK ARRAY PROCESSORS are able to perform many graphics functions such as coordinate transformations and 3-D rotations, as well as image processing functions such as differencing, edge detection, and pattern recognition at speeds up to 300 times faster than the microcomputer alone.

**Booth 1712 SUMMAGRAPHICS CORP.**

**35 Brentwood Avenue  
Fairfield, CT 06430  
(203) 384-1344  
KATHY DUNN  
Marketing Communications Manager**

**User Group Contact:  
RON McCLURE  
National OEM Sales Manager**

## Exhibitor Listing

Summagraphics, the world's leading manufacturer of digitizers and data tablets, will be exhibiting its full digitizer product line. On display will be the Bit Pad family of digitizers featuring low-cost, high reliability digitizers for CRT cursor control, data entry and menu and graphics insert applications. The ID series digitizers designed for OEM applications feature a full range of tablet sizes, from 11" x 11" to 42" x 60", standard resolutions and a variety of interface options affording compatibility to nearly every computer on today's market. High resolution and high accuracy models are available with the Supergrid and Summagrid digitizers which also feature a variety of sizes, optics, interfaces and options.

Booth 2725 **SUN-FLEX COMPANY INC.**

20 Pimentel Court  
Novato, CA 94947  
(415) 883-1221  
**DOUGLAS ROSESTONE**  
Vice President-Marketing

User Group Contact:  
**WALTER L. GOOD III**  
Accounts Representative

Sun-Flex, the leading manufacturer of glare reduction filters for video displays, announces the TOUCHPEN SYSTEM. The new product is an on-screen location digitizer, serving as an attractive alternative to light pens and other digitizing devices. Compared to other methods, the TOUCHPEN has greater flexibility and ease of use, while retaining all the benefits of Sun-Flex's optical filter. The TOUCHPEN is a microprocessor based, stylus operated, graphics capable interface which enables a CRT operator to bypass the keyboard and communicate directly with the CPU.

Booth 1243 **SUN MICROSYSTEMS, INC.**

2310 Walsh Avenue  
Santa Clara, CA 95051  
(408) 748-9900  
**VINOD KHOSLA**  
**President**

The SUN Workstation<sup>™</sup> is a high performance graphics workstation. It includes a Motorola 68000/68010 processor providing virtual memory, hardware assist for graphics and an ETHERNET local network. The use of Intel's Multibus<sup>™</sup> allows system expansion by adding memory, color frame buffers, and standard peripherals such as SMD disks and tapes. A distributed version of Western Electric's UNIX<sup>™</sup> allows workstations to run without disks. A CORE compatible graphics package optimized to the system architecture provides a powerful and flexible development system.

Booth 1628 **SUPERSET, INC.**

11035 Roselle Street  
San Diego, CA 92121  
(714) 452-8665  
**JERRY DONALDSON**  
**Director of Marketing**

**User Group Contact:**  
**GIUSTO FONDA-BONARDI**  
**President, Users Group**

Superset manufactures the Portable Graphics Mainframe (PGM), a graphics based distributed processor, controller or stand-alone computer. The PGM's 48-bit precision and Virtual Memory architecture make it a cost effective innovative device which permits the compilation, linking and execution of massive FORTRAN programs beyond the reach of minicomputers (examples: DISSPLA<sup>™</sup>, INTERACT and MOVIE.BYU). A prototype of Superset's model CD-2 high resolution color monitor, driven by a high speed channel at transmission rates of over one Megahertz, will also be demonstrated. Superset provides drivers for over 40 different peripheral devices.



## Exhibitor Listing

### Booth 2928 **SYMBOLICS, INC.**

9600 DeSoto Avenue  
Chatsworth, CA 91311  
(213) 998-3600  
**ROBERT D. STONE**  
**Manager, Advertising & Marketing Support**

Symbolics manufactures powerful Lisp-based computers for Artificial Intelligence, CAD, VLSI design, simulation training, and command and control applications. These computers are 36-bit minicomputer based workstations complete with high resolution B & W and color graphics, local area networks and large hard disk file systems. Symbolics' strengths are very sophisticated interactive display software, full complement of local networking facilities, high performance Lisp-based (Fortran available soon) computing and AI expertise. Symbolics' Laser Graphics Printer features high resolution (480 x 240 DPI) for text, graphics, and typography; embedded MC68000 controller, software, and 1M Byte memory. It interfaces to most minicomputers and can use existing operating systems.

### Booth 3016 **TECHNOLOGY & BUSINESS COMMUNICATIONS, INC.**

730 Boston Post Road/Suite 27  
Sudbury, MA 01776  
(617) 443-4671  
**STANLEY KLEIN**  
**President/Publisher**

**User Group Contact:**  
**LISA SENIO**  
**Assistant to President/Publisher**

Publications: (1) The S. Klein Newsletter On Computer Graphics. Twice monthly. Includes reports, analyses and interpretation of significant developments in computer graphics for users and vendors. Covers engineering design, cartography, business and statistical graphics, image processing, animation, and related disciplines. (2) The S. Klein Directory of Computer Graphics Suppliers: Hardware,

Software, Systems and Services. 1982-83 edition, 128 pp. Contains information on 300 suppliers: year founded, sales, personnel, products/services, complete address, phone, person to contact, and cross reference index by application and/or technology specialization. Lists market research reports and organizations routinely sponsoring courses on computer graphics.

Booth 1216 **TEKTRONIX, INC.**

**Box 500  
Beaverton, OR 97077  
(203) 877-1494  
JIM HATTON  
District Sales Manager**

Tektronix, a leading manufacturer of computer graphics products for engineering and scientific markets, will exhibit computer graphic terminals, including three members of the recently introduced 4110 Series Computer Display Terminals: the 4112, featuring a monochrome raster display; the 4114, including a high resolution DVST display; and the 4113 computer display terminal with color raster display. The 4114 and 4113 will both be shown in the desk configuration. The 4050A Series Desktop Computers with recently introduced enhancements will be exhibited. A 2-D Drafting workstation will be shown including: 4054A Desktop Computer, 4663 C-size Interactive Digital Plotter, Graphic Tablet and 4909 Multi-User File Management System. Peripheral products at the Tektronix booth will include Electrostatic and Electrophotographic hard copy units and interactive digital plotters.

Booth 1516 **TERAK CORP.**

**14151 N. 76th Street  
Scottsdale, AR 85260  
(602) 998-4800  
G. PETER GAGNET III  
National Sales Manager**

## Exhibitor Listing

**User Group Contact:**  
**WALTER WHITE, JR.**  
**Manager, Marketing Communications**

Terak manufactures and distributes desk top graphics computer systems. Used in both stand-alone and distributed processing networks, multiple options and peripherals are available. Products include both black and white and color graphics systems with resolutions of 320 x 240 and 640 x 480. Character fonts are user programmable in both the black and white and color systems. Terak supplies multiple operating systems and languages, graphics support in conformance with the SIGGRAPH Core standards and complete documentation for its systems.

Booth 2617 **THREE RIVERS COMPUTER CORP.**

**720 Gross Street**  
**Pittsburgh, PA 15224**  
**(412) 621-6250**  
**DOUG CALAWAY**  
**Director of Marketing**

Three Rivers Computer will display the PERQ, a fully micro-programmed minicomputer designed for a single user. The PERQ system includes a 16-bit CPU with a high level, language directed architecture and integrated I/O controllers. It offers 512 KB of memory expandable to 1 million bytes. Its graphic display's 800,000 addressable points are refreshed 60 times per second, providing exceptionally high resolution graphics. PERQ is also compatible with the Ethernet standard, an option that allows the system to be interconnected as a Distributed Interactive Network. Three Rivers will be displaying this Ethernet capacity at SIGGRAPH '82 as well as the LBP-10 Laser Printer, which comes complete with PERQ Interface.

Booth 1636 **TRILOG, INC.**

**17391 Murphy Avenue**  
**Irvine, CA 92714**  
**(714) 549-4079**

**JIM MARSHALL**  
**Eastern Regional Sales Manager**

**User Group Contact:**  
**TOM SMITH**  
**International Sales Mgr./Applications Engr.**

Trilog is a leading manufacturer of line printers. The COLORPLOT™ printer will be shown at SIGGRAPH '82, demonstrating full color graphics output on plain computer paper. A near letter quality line printer as well as a color graphics capable plotter, the COLORPLOT™ family offers the user versatility with reliability that can't be beat. Equally suitable for CAD/CAM, scientific, mapping, process control or business graphics applications. Will also make full color hard copy of color terminal screen on plain paper.

Booth 2302 **VECTOR AUTOMATION, INC.**

**Village of Cross Keys**  
**Baltimore, MD 21210**  
**(301) 433-4202**  
**PHILLIP A. ADAMS**  
**Vice President-Marketing**

Vector Automation manufactures the following products: (1) CADMAX-I computer aided design drafting system for 2D mechanical, electrical schematic and nesting applications using stroke refresh terminal technology. (2) GRAPHICUS-80 stroke writer refresh display designed for 2D and 3D graphics applications requiring high resolution via a host and capable of displaying 66,000 short vectors flicker free.

Booth 1428 **VERSATEC/A XEROX COMPANY**

**2710 Walsh Avenue**  
**Santa Clara, CA 95051**  
**(408) 988-2800**  
**DAVE HATFIELD**  
**Director of Market Development & Support**

## Exhibitor Listing

**User Group Contact:**  
**PATRICIA KELLEHER**  
**Manager of Exhibits**

A SIGGRAPH '82 "must": watch our V-80 plotters and wide plotters producing continuous high resolution computer graphics on film and paper in widths from 11" to 36". Ask our team of trained specialists any question about the Versatec family of printers/plotters. Be sure to ask about our expert field service and the full line of film, paper and toner supplies that have made Versatec the world's leading manufacturer of electrostatic printers/plotters.

Booth 2318 **VIA SYSTEMS, INC.**

**11 Concord Street**  
**Nashua, NH 03060**  
**(603) 889-4197**  
**RICHARD JENNINGS**  
**Vice President-Marketing**

VIA Systems will demonstrate its new VIA 100, first in a series of high performance, single user, interactive graphics systems offering distributed processing, fast response, high resolution color graphics and superior VLSI design software. The system includes DEC LSI 11/23 minicomputer with 256K bytes of main memory, high speed 8" 35 megabyte Winchester disk drive and a 17 megabyte tape cartridge; the integrated design station includes a graphics subsystem containing additional computing power and a 19" high resolution 60Hz flicker free color monitor as well as a user programmable alphanumeric terminal with function keys, and an 11" x 11" data tablet for on-line design.

Booth 1634 **VICOM SYSTEMS, INC.**

**2307 Bering Drive**  
**San Jose, CA 95131**  
**(408) 946-5660**  
**RICHARD P. LaJEUNESSE**  
**Vice President-Marketing**



**User Group Contact:**  
**MARK SANTORA**  
**National Sales Manager**

Digital Image Processing Systems.

**Booth 2631 VISUAL TECHNOLOGY, INC.**

**540 Main Street**  
**Tewksbury, MA 01876**  
**(617) 851 5000**  
**PHIL CHARLAND**  
**Technical Support Manager**

**User Group Contact:**  
**HOWARD GERSTEIN**  
**Product Marketing Manager**

Visual Technology designs, manufactures and markets a broad range of alphanumeric and graphic video display terminals. The company will be featuring the Visual 550 and Visual 500 graphics terminals at SIGGRAPH '82. They have 768 x 585 resolution on a large 14" screen. The auxiliary port supports printer/plotters for alphanumeric and graphics hardcopy and a data tablet. Advanced graphic features include vector draw, point plot, rectangular draw, line styles and patterns with rectangular pattern fill. They are designed with separate display memories for alpha and graphics with 80 x 33 text format.

**Booth 1819 WATANABE INSTRUMENTS CORP.**

**3186-D Airway Avenue**  
**Costa Mesa, CA 92626**  
**(714) 546-5344**  
**JACK CAMPBELL**  
**Digital Products Manager**

Watanabe manufactures and distributes several intelligent, digital, flat-bed, cost effective plotters. They come in sheet or roll feed and 1, 2, 6 or 10 pen configurations. A full complement of RS-232C, IEEE-488 or parallel interfaces, software and service support is available.

## Exhibitor Listing

Booth 1227 **XEROX CORP.  
PRINTING SYSTEMS DIV.**

880 Apollo Street  
El Segundo, CA 90245  
(213) 615-6363  
**DON BERARD**  
Product Manager

Xerox will be exhibiting their 6500 Color Graphics Printer which creates full color permanent hardcopy from digital input. The Color Graphics Printer is a laser scanning, raster imaging system which accepts serial computer data (TTL or DTL compatible) and delivers full color images with a uniform resolution of 100 points per inch.

Booth 1734 **3M COMPANY/INDUSTRIAL OPTICS**

3M Center  
St. Paul, MN 55101  
(612) 736-2240  
**CHUCK HYP**  
Product Supervisor

Industrial Optics will be exhibiting a line of visual comfort systems which make viewing a full color CRT more comfortable. The Visual Comfort Systems combine a very high resolution anti-glare treatment on a "micro-louvered" film which reduces glare and improves contrast while maintaining high on-axis transmission.

# Product Index

## ■ BUSINESS GRAPHICS SOFTWARE

Aztek, Incorporated	1720
CADLINC Inc.	1814
Computer Pictures Corporation	2326
Datamax/TDS	2832
Data-Type, Inc.	2738
DICOMED Corporation	2010
European Software Contractors ApS	2628
Geographic Systems, Inc.	1536
Graphic Communications, Inc.	2422
Hewlett-Packard	1408
IBM Corporation	1116
Intelligent Systems Corp.	2103
ISSCO Graphics	1022
Japan Radio Co., LTD.	2521
LogEtronics, Inc.	1416
Nicolet Zeta Corporation	1236, 2232
Precision Visuals, Inc.	1135
Quality Micro Systems, Inc.	2624
SAS Institute Inc.	2003
Sun-Flex Company, Inc.	2725
Superset, Inc.	1628
Tektronix, Inc.	1216
Terak Corporation	1516
Versatec	1428
Watanabe Instruments Corp.	1819
Xerox Corporation Printing Systems Division	1227

## ■ CAD/CAM SYSTEMS

Adage, Inc.	1108
Advanced Electronics Design, Inc. (AED)	1316
AMDEK Corporation	2718
AMF Logic Sciences, Inc.	1736
Apollo Computer Inc.	2621
Applicon (A Schlumberger Company)	1104
CADLINC Inc.	1814
CalComp	1208
Charles River Data Systems, Inc.	2225
Comarc Systems	2332
Cubic Systems	2824
Design Aids, Inc.	1741
Digital Equipment Corporation	1228
Evans & Sutherland Computer Corporation	1136

## Product Index

Genisco Computers Corporation	2308
Graphic Controls Corporation	2724
GTI Corporation	2836
Hewlett-Packard	1408
Hitachi America, LTD.	2118
Image Dynamics Inc.	2739
Interactive Machines, Inc.	1142
Lexidata Corporation	1122
Lundy Electronics & Systems, Inc.	2708
MATRA Datavision, Inc.	1528
Megatek Corporation	1008
Optronics International, Inc.	2638
Orcatech Inc.	2817
Phoenix Computer Graphics, Inc.	1724
Polhemus Navigation Sciences, Inc.	2222
Precision Visuals, Inc.	1135
PrintaColor Corporation	2917
Quadram Corporation	2526
Scitex America Corp.	2117
Sun-Flex Company, Inc.	2725
Sun Microsystems, Inc.	1243
Symbolics, Inc.	2928
Terak Corporation	1516
Vector Automation, Inc.	2302
Versatec	1428
VIA Systems, Inc.	2318

### ■ CARTOGRAPHY

ALTEK Corporation	2416
AMF Logic Sciences, Inc.	1736
Benson Inc.	2110
Digital Equipment Corporation	1228
European Software Contractors ApS	2628
Geographic Systems, Inc.	1536
Hitachi America LTD.	2118
International Imaging Systems	2728
Japan Radio Co., LTD.	2521
Lexidata Corporation	1122
Optronics International, Inc.	2638
Precision Visuals, Inc.	1135
Scitex America Corp.	2117
Sun-Flex Company, Inc.	2725
Sun Microsystems, Inc.	1243
Symbolics, Inc.	2928
Vicom Systems, Inc.	1634

## ■ COM DEVICES/FILM RECORDERS

Aztek, Incorporated	1720
Celco	1128
Datacopy Corporation	2511
DICOMED Corporation	2010
Eikonix Corporation	2924
MacDonald Dettwiler & Associates, LTD.	2818
Polaroid Corporation	2402
Scitex America Corp.	2117

## ■ COMPUTER ANIMATION SYSTEMS

AMDEK Corporation	2718
Aztek, Incorporated	1720
Datacube, Inc.	1734
Datamax/TDS	2832
Digital Equipment Corporation	1228
Eikonix Corporation	2924
Evans & Sutherland Computer Corporation	1136
Genisco Computers Corporation	2308
Grinnell Systems Corporation	2226
GTI Corporation	2836
Hitachi America, LTD.	2118
Ikonas Graphics Systems	2217
Image Dynamics Inc.	2739
Imaging Technology, Inc.	2926
Interactive Machines, Inc.	1142
Lexidata Corporation	1122
MCI/Quantel	1303
Precision/ECHO	2423
Sun-Flex Company, Inc.	2725
Sun Microsystems, Inc.	1243
Symbolics, Inc.	2928

## ■ CONSULTANTS

Combined Logic Research Corporation	2324
European Software Contractors ApS	2628
Geographic Systems, Inc.	1536
Rubel Software/Andrew Rubel & Associates, Inc.	2632



## Product Index

### ■ CORE STANDARD SOFTWARE

Apollo Computer Inc.	2621
Aztek, Incorporated	1720
Computer Design & Applications, Inc.	2325
Digital Equipment Corporation	1228
Genisco Computers Corporation	2308
Intelligent Systems Corp.	2103
ISSCO Graphics	1022
Lexidata Corporation	1122
Megatek Corporation	1008
METHEUS Corporation	2024
Precision Visuals, Inc.	1135
Sun Microsystems, Inc.	1243
Tektronix, Inc.	1216
Vector Automation, Inc.	2302

### ■ DESKTOP COMPUTERS

AMDEK Corporation	2718
Apple Computer	2732
CADLINC Inc.	1814
Charles River Data Systems, Inc.	2225
Chromatics, Inc.	2810
Cromemco, Inc.	2218
Cubic Systems	2824
Datamax/TDS	2832
Digital Equipment Corporation	1228
Hewlett-Packard	1408
Intelligent Systems Corp.	2103
NORPAK Limited	2838
Phoenix Computer Graphics, Inc.	1724
Quality Micro Systems, Inc.	2624
Sun Microsystems, Inc.	1243
Superset, Inc.	1628
Symbolics, Inc.	2928
Tektronix, Inc.	1216
Terak Corporation	1516

## ■ DRAFTING SYSTEMS

AMDEK Corporation	2718
AMF Logic Sciences, Inc.	1736
CalComp	1208
Design Aids, Inc.	1741
Hitachi America, LTD.	2118
Lexidata Corporation	1122
Orcatech Inc.	2817
Sun-Flex Company, Inc.	2725
Sun Microsystems, Inc.	1243
Tektronix, Inc.	1216
Vector Automation, Inc.	2302
Versatec	1428

## ■ ELECTRICAL/ELECTRONIC SYSTEMS

AMF Logic Sciences, Inc.	1736
Celco	1128
Charles River Data Systems, Inc.	2225
Design Aids, Inc.	1741
Evans & Sutherland Computer Corporation	1136
Japan Radio Co., LTD.	2521
Lexidata Corporation	1122
NORPAK Limited	2838
Sun Microsystems, Inc.	1243
Symbolics, Inc.	2928
Versatec	1428

## ■ ERGONOMICS

Advanced Electronics Design, Inc. (AED)	1316
Aztek, Incorporated	1720
Digital Equipment Corporation	1228
Envision	2822
Florida Computer Graphics	2823
Genisco Computers Corporation	2308
OCLI-Optical Coating Laboratory, Inc.	1815
Sun-Flex Company, Inc.	2725

## ■ ERGONOMICS - HARDWARE

Florida Computer Graphics	2823
OCLI-Optical Coating Laboratory, Inc.	1815

## Product Index

### ■ **ERGONOMICS - WORKSTATIONS**

Advanced Electronics Design, Inc. (AED)	1316
Aztek, Incorporated	1720
Digital Equipment Corporation	1228
Envision	2822
Florida Computer Graphics	2823
Genisco Computers Corporation	2308
Sun-Flex Company, Inc.	2725
Tektronix, Inc.	1216

### ■ **GRAPHIC DIGITIZERS**

ALTEK Corporation	2416
AMDEK Corporation	2718
Aztek, Incorporated	1720
CADLINC Inc.	1814
CalComp	1208
Datacopy Corporation	2511
Datacube, Inc.	1734
Design Aids, Inc.	1741
Eikonix Corporation	2924
Genisco Computers Corporation	2308
GTCO Corporation	1341
Hewlett-Packard	1408
Hitachi America, LTD.	2118
Houston Instrument/Bausch & Lomb Instruments & Systems Division	1129
Imaging Technology, Inc.	2926
Intelligent Systems Corp.	2103
International Imaging Systems	2728
Matrox Electronic Systems	2124
MCI/Quantel	1303
Megatek Corporation	1008
NORPAK Limited	2838
Numonics Corporation	2705
OCTEK Inc.	1821
Optronics International, Inc.	2638
Phoenix Computer Graphics, Inc.	1724
Polhemus Navigation Sciences, Inc.	2222
Science Accessories Corp.	2504
Scitex America Corp.	2117
Summagraphics Corporation	1712
Sun-Flex Company, Inc.	2725
Tektronix, Inc.	1216

## ■ GRAPHIC DISPLAYS

Adage, Inc.	1108
AMDEK Corporation	2718
AMF Logic Sciences, Inc.	1736
Apollo Computer Inc.	2621
ASEA Industrial Systems	2828
Aydin Controls	1522
Aztek, Incorporated	1720
CADLINC Inc.	1814
CalComp	1208
Charles River Data Systems, Inc.	2225
Chromatics, Inc.	2810
Colographic Communications Corp.	2518
Computer Design & Applications, Inc.	2325
Conrac Division, Conrac Corporation	1620
Cromemco, Inc.	2218
Cubic Systems	2824
Datacube, Inc.	1734
Datamax/TDS	2832
Data-Type, Inc.	2738
Digital Engineering, Inc.	2408
Digital Equipment Corporation	1228
Elector	1641
Envision	2822
Florida Computer Graphics	2823
Genisco Computers Corporation	2308
Graphic Strategies, Inc.	2227
Grinnell Systems Corporation	2226
GTI Corporation	2836
IBM Corporation	1116
Ikegami Electronics (U.S.A.), Inc.	2417
Ikonas Graphics Systems	2217
Imaging Technology, Inc.	2926
IMLAC Corporation	2210
Industrial Data Terminals	2338
Integrated Terminals, Div. of Telpar, Inc.	1740
Intelligent Systems Corp.	2103
Interactive Machines, Inc.	1142
International Imaging Systems	2728
Japan Radio Co., LTD.	2521
Jupiter Systems, Inc.	2625
Lexidata Corporation	1122
Lundy Electronics & Systems, Inc.	2708
Matrox Electronic Systems	2124
MCI/Quantel	1303
Megatek Corporation	1008
METHEUS Corporation	2024

## Product Index

Mostek	2337
Nissei Sangyo America, LTD.	1808
NORPAK Limited	2838
Orcatech Inc.	2817
Peritek Corporation	2122
Phoenix Computer Graphics, Inc.	1724
Photonics Technology	2837
Quadram Corporation	2526
RAMTEK Corporation	1612
Raster Technologies	2508
SEIKO Instruments U.S.A., Inc.	2608
Selanar Corporation	1542
Sun-Flex Corporation	2725
Sun Microsystems, Inc.	1243
Symbolics, Inc.	2928
Tektronix, Inc.	1216
Terak Corporation	1516
Vector Automation, Inc.	2302
Vicom Systems, Inc.	1634
Visual Technology Inc.	2631
Xerox Corporation Printing System Division	1227

### ■ GRAPHICS AIDED DRAFTING

AMDEK Corporation	2718
Aztek, Incorporated	1720
Benson Inc.	2110
CalComp	1208
Charles River Data Systems, Inc.	2225
Design Aids, Inc.	1741
Hewlett-Packard	1408
Hitachi America, LTD.	2118
Interactive Machines, Inc.	1142
Lexidata Corporation	1122
Lundy Electronics & Systems, Inc.	2708
MATRA Datavision, Inc.	1528
Nicolet Zeta Corporation	1236, 2232
PrintaColor Corporation	2917
Sun-Flex Company, Inc.	2725
Symbolics, Inc.	2928
Tektronix, Inc.	1216
Terak Corporation	1516
Vector Automation, Inc.	2302
Versatec	1428
Watanabe Instruments Corp.	1819



## ■ **HARD COPY - PHOTOGRAPHS**

Aztek, Incorporated	1720
Intelligent Systems Corp.	2103
Lexidata Corporation	1122
LogEtronics, Inc.	1416
MacDonald Dettwiler & Associates, LTD.	2818
Matrix Instruments	2426
MODGRAPH, Inc.	2017
Phoenix Computer Graphics, Inc.	1724
Polaroid Corporation	2402
RAMTEK Corporation	1612

## ■ **HARD COPY - SLIDES**

Aztek, Incorporated	1720
Celco	1128
Intelligent Systems Corp.	2103
LANG Systems, Inc.	2421
Lexidata Corporation	1122
LogEtronics, Inc.	1416
Matrix Instruments	2426
MODGRAPH, Inc.	2017
NORPAK Limited	2838
Phoenix Computer Graphics, Inc.	1724
Polaroid Corporation	2402
RAMTEK Corporation	1612

## ■ **HARD COPY - VIDEO PAPER**

Advanced Color Technology, Inc.	2437
Analog Technology Corporation	2412
Aztek, Incorporated	1720
Benson Inc.	2110
Datacopy Corporation	2511
Data-Type, Inc.	2738
Envision	2822
Intelligent Systems Corp.	2103
Lexidata Corporation	1122
Selinar Corporation	1542
Symbolics, Inc.	2928
Tektronix, Inc.	1216
Trilog, Inc.	1636
Versatec	1428
Xerox Corporation Printing System Division	1227

## Product Index

### ■ HIGH PERFORMANCE GRAPHICS PROCESSORS

AMF Logic Sciences, Inc.	1736
Apollo Computer Inc.	2621
Aztek, Incorporated	1720
Benson Inc.	2110
Charles River Data Systems, Inc.	2225
Computer Designs & Applications, Inc.	2325
Cubic Systems	2824
Datacube, Inc.	1734
Digital Equipment Corporation	1228
Evans & Sutherland Computer Corporation	1136
Florida Computer Graphics	2823
Genisco Computers Corporation	2308
Gould Inc., DeAnza Imaging & Graphics Division	1021
Graphic Strategies, Inc.	2227
Grinnell Systems Corporation	2226
GTI Corporation	2836
Ikonas Graphics Systems	2217
Image Dynamics Inc.	2739
Imaging Technology, Inc.	2926
Industrial Data Terminals	2338
Interactive Machines, Inc.	1142
International Imaging Systems	2728
Jupiter Systems, Inc.	2625
Lexidata Corporation	1122
LogEtronics, Inc.	1416
Lundy Electronics & Systems, Inc.	2708
Matrox Electronic Systems	2124
MCI/Quantel	1303
Megatek Corporation	1008
METHEUS Corporation	2024
Mostek	2337
NORPAK Limited	2838
Optronics International, Inc.	2638
Orcatech Inc.	2817
Phoenix Computer Graphics, Inc.	1724
Quadram Corporation	2526
RAMTEK Corporation	1612
Raster Technologies	2508
Sky Computers, Inc.	1722
Sun Microsystems, Inc.	1243
Superset, Inc.	1628
Symbolics, Inc.	2928
Vector Automation, Inc.	2302
Vicom Systems, Inc.	1634

## ■ HIGH RESOLUTION GRAPHIC DISPLAY SYSTEMS

Adage, Inc.	1108
Advanced Electronics Design, Inc. (AED)	1316
AMDEK Corporation	2718
AMF Logic Sciences, Inc.	1736
Apollo Computer Inc.	2621
Aydin Controls	1522
Aztek, Incorporated	1720
CADLINC Inc.	1814
CalComp	1208
Celco	1128
Charles River Data Systems, Inc.	2225
Chromatics, Inc.	2810
Computer Design & Applications, Inc.	2325
Cromemco, Inc.	2218
Cubic Systems	2824
Data-Type, Inc.	2738
Digital Equipment Corporation	1228
Evans & Sutherland Computer Corporation	1136
Genisco Computers Corporation	2308
Gould Inc., DeAnza Imaging & Graphics Division	1021
Graphic Strategies, Inc.	2227
Grinnell Systems Corporation	2226
GTI Corporation	2836
ID Systems Corporation	2431
Ikegami Electronics (U.S.A.), Inc.	2417
Ikonas Graphics Systems	2217
Image Dynamics Inc.	2739
Imaging Technology, Inc.	2926
IMLAC Corporation	2210
Industrial Data Terminals	2338
Interactive Machines, Inc.	1142
International Imaging Systems	2728
Jupiter Systems, Inc.	2625
Lexidata Corporation	1122
LogEtronics, Inc.	1416
Lundy Electronics & Systems, Inc.	2708
MCI/Quantel	1303
Matrox Electronic Systems	2124
Megatek Corporation	1008
METHEUS Corporation	2024
Mostek	2337
Nissei Sangyo America, LTD.	1808
NORPAK Limited	2838

## Product Index

OCLI-Optical Coating Laboratory, Inc.	1815
Orcatech Inc.	2817
Phoenix Computer Graphics, Inc.	1724
Photonics Technology	2837
Quadram Corporation	2526
RAMTEK Corporation	1612
Raster Technologies	2508
SEIKO Instruments U.S.A., Inc.	2608
Sun-Flex Company, Inc.	2725
Sun Microsystems, Inc.	1243
Superset, Inc.	1628
Symbolics, Inc.	2928
Tektronix, Inc.	1216
Three Rivers Computer Corporation	2617
Vector Automation, Inc.	2302
VIA Systems, Inc.	2318

### ■ INTERACTIVE GRAPHICS TERMINALS

Adage, Inc.	1108
Advanced Electronics Design, Inc. (AED)	1316
AMDEK Corporation	2718
AMF Logic Sciences, Inc.	1736
Applicon (A Schlumberger Company)	1104
Aydin Controls	1522
Aztek, Incorporated	1720
CADLINC Inc.	1814
CalComp	1208
Charles River Data Systems, Inc.	2225
Cubic Systems	2824
Data-Type, Inc.	2738
Digital Engineering, Inc.	2408
Digital Equipment Corporation	1228
Envision	2822
Evans & Sutherland Computer Corporation	1136
Florida Computer Graphics	2823
Genisco Computers Corporation	2308
Graphic Strategies, Inc.	2227
Grinnell Systems Corporation	2226
GTI Corporation	2836
Hewlett-Packard	1408
Hitachi America, LTD.	2118
IBM Corporation	1116
ID Systems Corporation	2431
Ikonas Graphics Systems	2217
Image Dynamics Inc.	2739
IMLAC Corporation	2210

Industrial Data Terminals	2338
Integrated Terminals, Div. of Telpar, Inc.	1740
Intelligent Systems Corp.	2103
Interactive Machines, Inc.	1142
International Imaging Systems	2728
Japan Radio Co., LTD.	2521
Lexidata Corporation	1122
LogEtronics, Inc.	1416
Lundy Electronics & Systems, Inc.	2708
Matrox Electronic Systems	2124
MCI/Quantel	1303
Megatek Corporation	1008
MODGRAPH, Inc.	2017
Mostek	2337
NORPAK Limited	2838
Orcatech Inc.	2817
Peritek Corporation	2122
Phoenix Computer Graphics, Inc.	1724
Photonics Technology	2837
Quadram Corporation	2526
RAMTEK Corporation	1612
Raster Technologies	2508
SEIKO Instruments U.S.A., Inc.	2608
Selancar Corporation	1542
Sun-Flex Company, Inc.	2725
Sun Microsystems, Inc.	1243
Symbolics, Inc.	2928
Tektronix, Inc.	1216
Terak Corporation	1516
Vector Automation, Inc.	2302
Vicom Systems, Inc.	1634
Visual Technology Inc.	2631



# Product Index

## ■ LOW-COST GRAPHICS SYSTEMS

AMDEK Corporation	2718
Analog Technology Corporation	2412
Apollo Computer Inc.	2621
Applicon (A Schlumberger Company)	1104
Aztek, Incorporated	1720
CADLINC Inc.	1814
Charles River Data Systems, Inc.	2225
Chromatics, Inc.	2810
Computer Design & Applications, Inc.	2325
Cromemco, Inc.	2218
Cubic Systems	2824
Datacube, Inc.	1734
Datamax/TDS	2832
Data-Type, Inc.	2738
DICOMED Corporation	2010
Digital Equipment Corporation	1228
Envision	2822
Genisco Computers Corporation	2308
Graphic Communications, Inc.	2422
Graphic Strategies, Inc.	2227
Hitachi America, LTD.	2118
ID Systems Corporation	2431
Intelligent Systems Corp.	2103
Jupiter Systems, Inc.	2625
Lexidata Corporation	1122
Lundy Electronics & Systems, Inc.	2708
Matrox Electronic Systems	2124
Megatek Corporation	1008
MODGRAPH, Inc.	2017
Nicolet Zeta Corporation	1236, 2232
Nissei Sangyo America, LTD.	1808
NORPAK Limited	2838
Peritek Corporation	2122
PrintaColor Corporation	2917
Quadram Corporation	2526
Quality Micro Systems, Inc.	2624
RAMTEK Corporation	1612
SAS Institute Inc.	2003
Sun-Flex Company, Inc.	2725
Sun Microsystems, Inc.	1243
Superset, Inc.	1628
Tektronix, Inc.	1216
Terak Corporation	1516
Vector Automation, Inc.	2302
VIA Systems, Inc.	2318

## ■ MANUFACTURING SYSTEMS

CADLINC Inc.	1814
Japan Radio Co., LTD.	2521
Lexidata Corporation	1122
Sun Microsystems, Inc.	1243

## ■ MECHANICAL DESIGN SYSTEMS

Applicon (A Schlumberger Company)	1104
CADLINC Inc.	1814
Charles River Data Systems, Inc.	2225
Digital Equipment Corporation	1228
Evans & Sutherland Computer Corporation	1136
Genisco Computers Corporation	2308
Japan Radio Co., LTD.	2521
Lexidata Corporation	1122
MATRA Datavision, Inc.	1528
Sun Microsystems, Inc.	1243
Vector Automation, Inc.	2302

## ■ MONITORS

AMDEK Corporation	2718
Computer Design & Applications, Inc.	2325
Conrac Division, Conrac Corporation	1620
Datamax/TDS	2832
Digital Equipment Corporation	1228
Elector	1641
Genisco Computers Corporation	2308
Gould, Inc., DeAnza Imaging & Graphics Division	1021
Ikegami Electronics (U.S.A.), Inc.	2417
Intelligent Systems Corp.	2103
Interactive Machines, Inc.	1142
Matrox Electronic Systems	2124
Matsushita Communications Industrial Co., LTD./Panasonic	2322
Peritek Corporation	2122
Phoenix Computer Graphics, Inc.	1724
Quadram Corporation	2526
RAMTEK Corporation	1612
Tektronix, Inc.	1216

# Product Index

## ■ NON GLARE COATINGS/MATERIALS

OCLI-Optical Coating Laboratory, Inc.	1815
Sun-Flex Company, Inc.	2725
Vector Automation, Inc.	2302
3M Company - Industrial Optics	1734

## ■ NUMERICAL CONTROL (NC, CNC, DNC)

Applicon (A Schlumberger Company)	1104
CADLINC Inc.	1814
MATRA Datavision, Inc.	1528
Watanabe Instruments Corp.	1819

## ■ PIPING SYSTEMS

Hitachi America, LTD.	2118
Interactive Machines, Inc.	1142
Polhemus Navigation Sciences, Inc.	2222
Terak Corporation	1516

## ■ PLOTTERS

Advanced Color Technology, Inc.	2437
AMDEK Corporation	2718
AMF Logic Sciences, Inc.	1736
Analog Technology Corporation	2412
Benson Inc.	2110
CalComp	1208
Data Design Logic Systems, Inc.	1535
DICOMED Corporation	2010
Digital Equipment Corporation	1228
Graphic Controls Corporation	2724
Hewlett-Packard	1408
Houston Instrument/Bausch & Lomb Instruments & Systems Division	1129
Intelligent Systems Corp.	2103
Japan Radio Co., LTD.	2521
Matsushita Communications Industrial Co., LTD./Panasonic	2322
Nicolet Zeta Corporation	1236, 2232
Numonics Corporation	2705
Optronics International, Inc.	2638
PrintaColor Corporation	2917
Quality Micro Systems, Inc.	2624
Scitex America Corp.	2117
Tektronix, Inc.	1216

Trilog, Inc.	1636
Versatec	1428
Watanabe Instruments Corp.	1819

## ■ PRINTERS

Advanced Color Technology, Inc.	2437
Analog Technology Corporation	2412
ASEA Industrial Systems	2828
Benson Inc.	2110
Data-Type, Inc.	2738
Digital Equipment Corporation	1228
Envision	2822
Graphic Controls Corporation	2724
Hewlett-Packard	1408
Houston Instrument/ Bausch & Lomb Instruments & Systems Division	1129
Intelligent Systems Corp.	2103
Polaroid Corporation	2402
PrintaColor Corporation	2917
Quadram Corporation	2526
Quality Micro Systems, Inc.	2624
RAMTEK Corporation	1612
Symbolics, Inc.	2928
Three Rivers Computer Corporation	2617
Trilog, Inc.	1636
Versatec	1428
Xerox Corporation Printing System Division	1227

## ■ PROJECTORS

Elector	1641
General Electric Company/Video Display Equipment Operation	2000
Interactive Machines, Inc.	1142
NORPAK Limited	2838

# Product Index

## ■ PUBLICATIONS

The Anderson Report	3005
Business Computer Systems	2703
Business Screen Magazine	2723
Byte Publications Inc.	2921
Computer-Aided Engineering & Machine Design	2722
Computer Decisions/Hayden Publishing Company, Inc.	1716
Computer Design Publishing Co.	2126
Computer Graphics World	1518
Computerworld	2604
Datamation	1616
Digital Design/Morgan-Grampian Publishing Company	1638
Government Data Systems Magazine	3015
IEEE Computer Society	2401
Mini-Micro Systems	2703
Photonics Spectra	2524
Scherago Associates, Inc.	2922
Technology & Business Communications, Inc.	3016

## ■ QUANTIZER/LINE SCAN CAMERAS

Datacopy Corporation	2511
Datacube, Inc.	1734
Eikonix Corporation	2924
Imaging Technology, Inc.	2926
Optronics International, Inc.	2638
Sun Microsystems, Inc.	1243

## ■ ROBOTICS

Datacube, Inc.	1734
Imaging Technology, Inc.	2926
OCTEK Inc.	1821
Sun Microsystems, Inc.	1243

## ■ SOFTWARE

AMF Logic Sciences, Inc.	1736
Apollo Computer Inc.	2621
Apple Computer	2732
Aztek, Incorporated	1720
Benson Inc.	2110
Combined Logic Research Corporation	2324
Datamax/TDS	2832
Design Aids, Inc.	1741
Digital Equipment Corporation	1228
Eikonix Corporation	2924
European Software Contractors ApS	2628
Geographic Systems, Inc.	1536
Graphic Communications, Inc.	2422
Hewlett-Packard	1408
IBM Corporation	1116
Intelligent Systems Corp.	2103
Interactive Machines, Inc.	1142
ISSCO Graphics	1022
MATRA Datavision, Inc.	1528
Megatek Corporation	1008
METHEUS Corporation	2024
Peritek Corporation	2122
Precision Visuals, Inc.	1135
Quality Micro Systems, Inc.	2624
Rubel Software/Andrew Rubel & Associates, Inc.	2632
SAS Institute Inc.	2003
Selanar Corporation	1542
Sun-Flex Company, Inc.	2725
Sun Microsystems, Inc.	1243
Tektronix, Inc.	1216
Versatec	1428



## Product Index

### ■ STAND-ALONE IMAGE PROCESSORS

Aztek, Incorporated	1720
Combined Logic Research Corporation	2324
Computer Design & Applications, Inc.	2325
Eikonix Corporation	2924
Gould Inc., DeAnza Imaging & Graphics Division	1021
Grinnell Systems Corporation	2226
Image Dynamics Inc.	2739
Imaging Technology, Inc.	2926
International Imaging Systems	2728
Joyce LoebI Div. of Vickers Instruments, Inc.	2321
LogEtronics, Inc.	1416
MCI/Quantel	1303
NORPAK Limited	2838
OCTEK Inc.	1821
Optronics International, Inc.	2638
Sun Microsystems, Inc.	1243
Vicom Systems, Inc.	1634

### ■ TABLETS

ALTEK Corporation	2416
CalComp	1208
Digital Equipment Corporation	1228
Genisco Computers Corporation	2308
GTCO Corporation	1341
Hewlett-Packard	1408
Hitachi America, LTD.	2118
Houston Instrument/Bausch & Lomb Instruments & Systems Division	1129
Intelligent Systems Corp.	2103
NORPAK Limited	2838
Numonics Corporation	2705
Phoenix Computer Graphics, Inc.	1724
Polhemus Navigation Sciences, Inc.	2222

### ■ TURNKEY SYSTEMS

AMF Logic Sciences, Inc.	1736
Aztek, Incorporated	1720
CADLINC Inc.	1814
CalComp	1208
Comarc Systems	2332
Computer Design & Applications, Inc.	2325

Computer Pictures Corporation	2326
DICOMED Corporation	2010
Eikonix Corporation	2924
Gould Inc., DeAnza Imaging & Graphics Division	1021
Graphic Communications, Inc.	2422
Image Dynamics Inc.	2739
Intelligent Systems Corp.	2103
International Imaging Systems	2728
ISSCO Graphics	1022
LogEtronics, Inc.	1416
NORPAK Limited	2838
Orcatech Inc.	2817
Peritek Corporation	2122
Scitex America Corp.	2117
Sun Microsystems, Inc.	1243
Superset, Inc.	1628
Vector Automation, Inc.	2302
VIA Systems, Inc.	2318
Xerox Corporation Printing System Division	1227

## ■ TURNKEY SYSTEMS - HARDWARE

AMF Logic Sciences, Inc.	1736
Aztek, Incorporated	1720
CADLINC Inc.	1814
Comarc Systems	2332
Computer Design & Applications, Inc.	2325
Computer Pictures Corporation	2326
DICOMED Corporation	2010
Eikonix Corporation	2924
Gould Inc., DeAnza Imaging & Graphics Division	1021
Image Dynamics Inc.	2739
Intelligent Systems Corp.	2103
International Imaging Systems	2728
LogEtronics, Inc.	1416
NORPAK Limited	2838
Orcatech Inc.	2817
Peritek Corporation	2122
Scitex America Corp.	2117
Sun Microsystems, Inc.	1243
VIA Systems, Inc.	2318
Xerox Corporation Printing System Division	1227

# Product Index

## ■ TURNKEY SYSTEMS - SOFTWARE

AMF Logic Sciences, Inc.	1736
Aztek, Incorporated	1720
CADLINC Inc.	1814
Comarc Systems	2332
Computer Design & Applications, Inc.	2325
Computer Pictures Corporation	2326
Eikonix Corporation	2924
Image Dynamics Inc.	2739
Intelligent Systems Corp.	2103
International Imaging Systems	2728
ISSCO Graphics	1022
LogEtronics, Inc.	1416
Orcatech Inc.	2817
Peritek Corporation	2122
Scitex America Corp.	2117
Sun Microsystems, Inc.	1243

## ■ VIDEO DIGITIZERS & DISPLAYS

Datacube, Inc.	1734
Datamax/TDS	2832
Eigen Video	2237
Eikonix Corporation	2924
Gould Inc., DeAnza Imaging & Graphics Division	1021
Grinnell Systems Corporation	2226
Ikonas Graphics Systems	2217
Imaging Technology, Inc.	2926
International Imaging Systems	2728
Joyce LoebI Div. of Vickers Instruments, Inc.	2321
Matrox Electronic Systems	2124
MCI/Quantel	1303
NORPAK Limited	2838
OCTEK Inc.	1821
Peritek Corporation	2122
Photonics Technology	2837
Quadram Corporation	2526
Sun-Flex Company, Inc.	2725
Vicom Systems, Inc.	1634

## ■ VIDEO DISCS

Eigen Video	2237
Precision/Echo	2423
Terak Corporation	1516

## ■ VIDEOTAPE RECORDERS

NORPAK Limited	2838
----------------	------

## ■ WORKSTATION FURNITURE

Orcatech Inc.	2817
---------------	------

## ■ MISCELLANEOUS

Analog Technology Corporation Vector to Raster Converter	2412
Association for Computing Machinery Technical Publications	3010
Charles River Data Systems, Inc. Integrated Graphic Work Stations	2225
Comarc Systems - Geographic Information Systems	2332
Combined Logic Research Corpora- tion - System Integration Relating To Visual Information Systems	2324
Conference Book Service - Book Display	3019
Datacopy Corporation - Digitizing Cameras	2511
Datamation - Seminars & Research	1616
Datamax/TDS - Animation	2832
Digital Equipment Corporation - Process Control Systems	1228
Eikonix Corporation - Real-Time Graphic Display	2924
Evans & Sutherland Computer Corporation - Biomedical; Molecular Modeling; Seismic; Research Applications	1136
Geographic Systems, Inc. Computer Mapping, Business Mapping	1536
Graphic Controls Corporation - Paper & Related Chemicals & Toner	2724
GTI Corporation - Real-Time Graphic Display	2836
IEEE Computer Society - Conferences, Seminars, & Society Membership Information	2401
Image Dynamcis Inc. - Real-Time Surface Graphics	2739

## Product Index

KMW Systems - Front Ends for Graphic Devices	2418
LogEtronics, Inc. - Cathode-Ray Cameras	1416
Matsushita Communications Industrial Co., LTD./Panasonic - Oscilloscopes, Logic Analyzers, Sweep Generators, Signal Generators, X/Y and Strip Chart Recorders	2322
MCI/Quantel - Digital Still-Stores, Digital Art Systems	1303
Measurement Systems Inc. - Interactive Input Devices & Joysticks - Trackballs	1643
OCTEK Inc. - Machine Vision Module	1821
Optronics International, Inc. Microdensitometers	2638
Panasonic Industrial Company - Cathode Ray Tubes	1618
Rubel Software/ Andrew Rubel & Associates, Inc. - Application Development Software	2632
Selinar Corporation - Low-Cost Graphics Boards for Alphanumeric Terminals	1542
Sky Computers, Inc. - Array Processors, High Speed Mathematics Processors	1722



## Floor Plans



# Hynes Auditorium

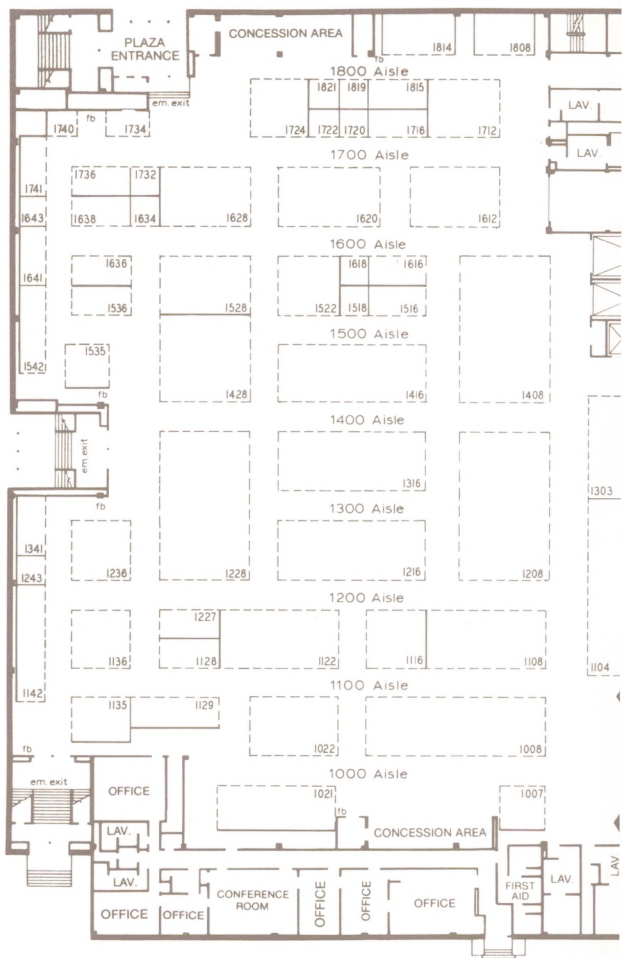

# First Floor

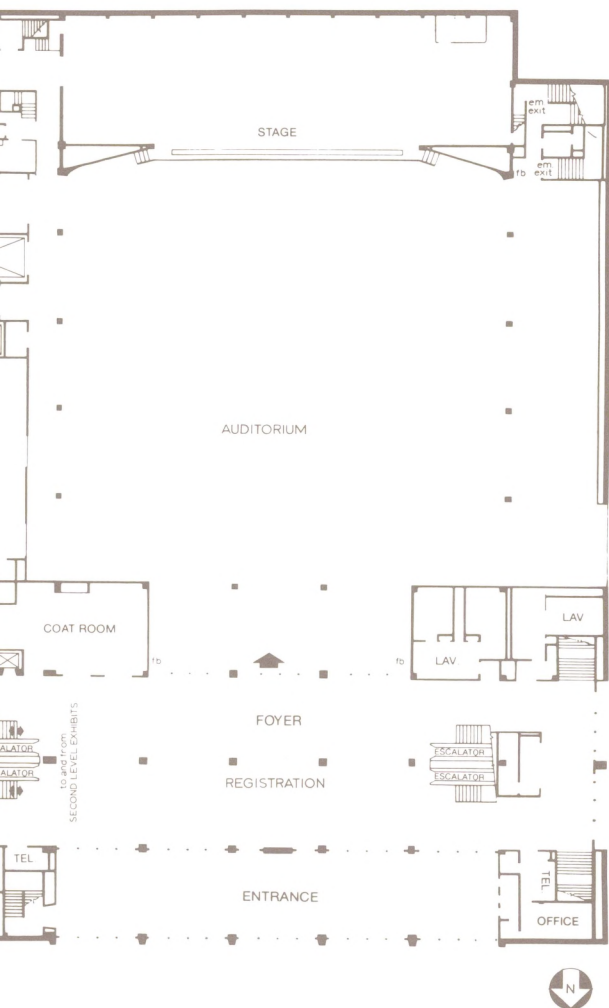

# Hynes Auditorium

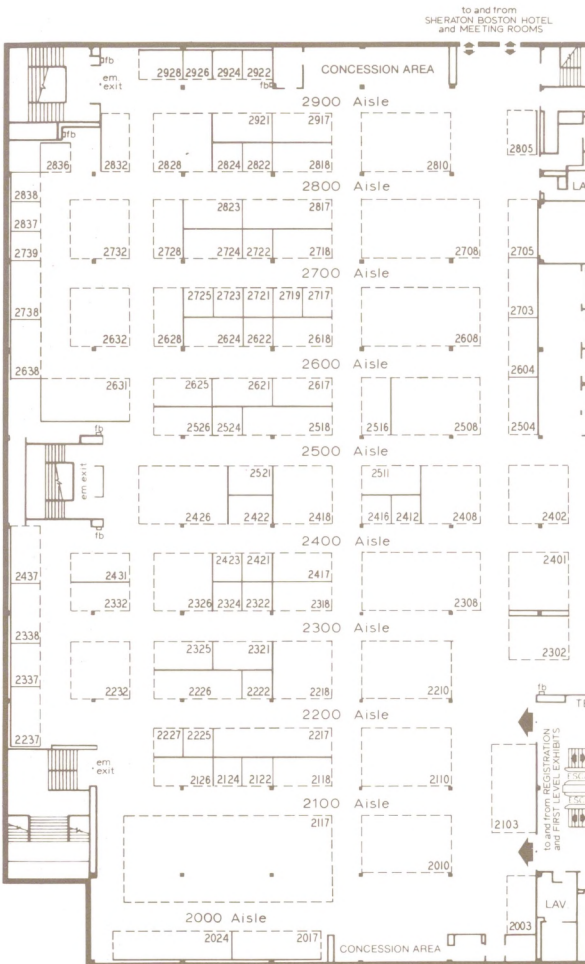

# Second Floor

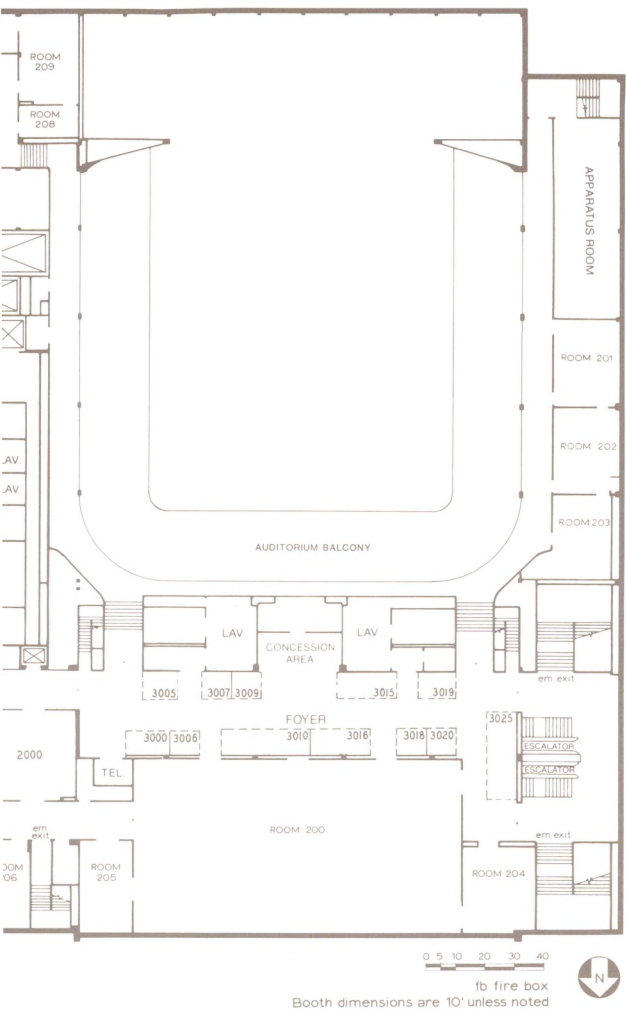

CHECK ROOM  
 ESCALATOR TO LOBBY  
 DN  
 DN  
 STAIR TO CONFERENCE LEVEL  
 WOMEN  
 WOMEN  
 CHECK ROOM  
 MEN  
 BAR  
 STORAGE  
 POWDER ROOM  
 STORAGE  
 Passage Way  
 MEN  
 ESCALATOR  
 LOBBY  
 FOLDING DOORS  
 C  
 GUEST ELEV.  
 LOBBY  
 FREIGHT ELEV.  
 ICE CREAM PARLOR  
 EX  
 SERVICE  
 KITCHEN  
 DN TO LOBBY  
 FREIGHT ELEVATOR  
 WOMEN

## Second Floor

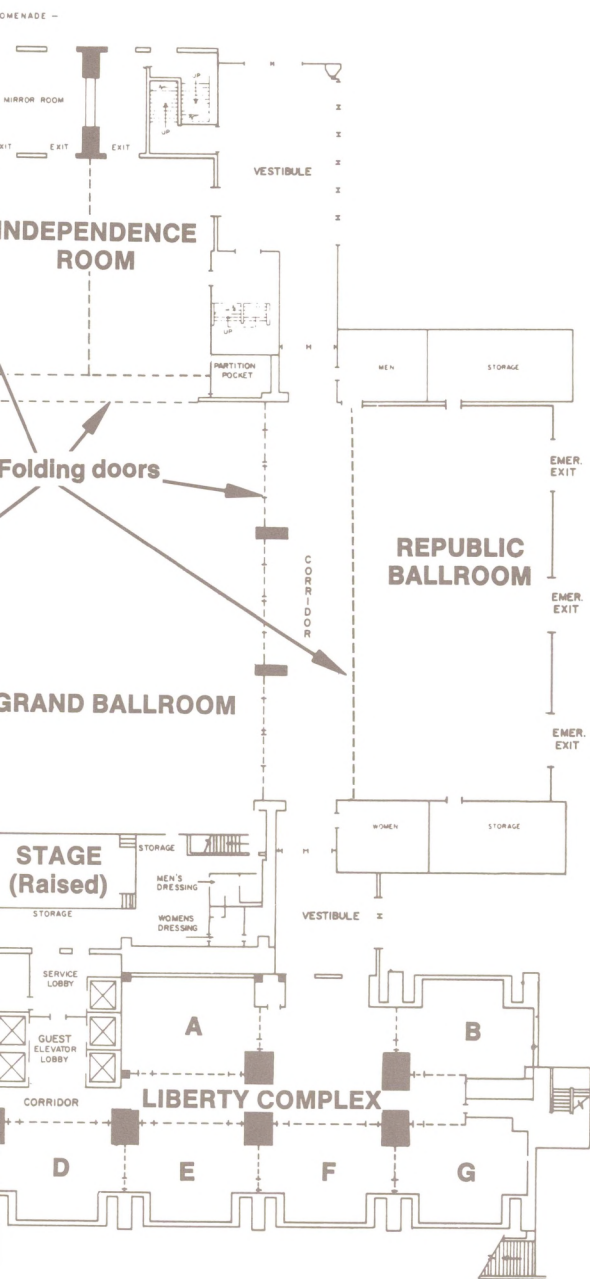



# Sheraton - Boston

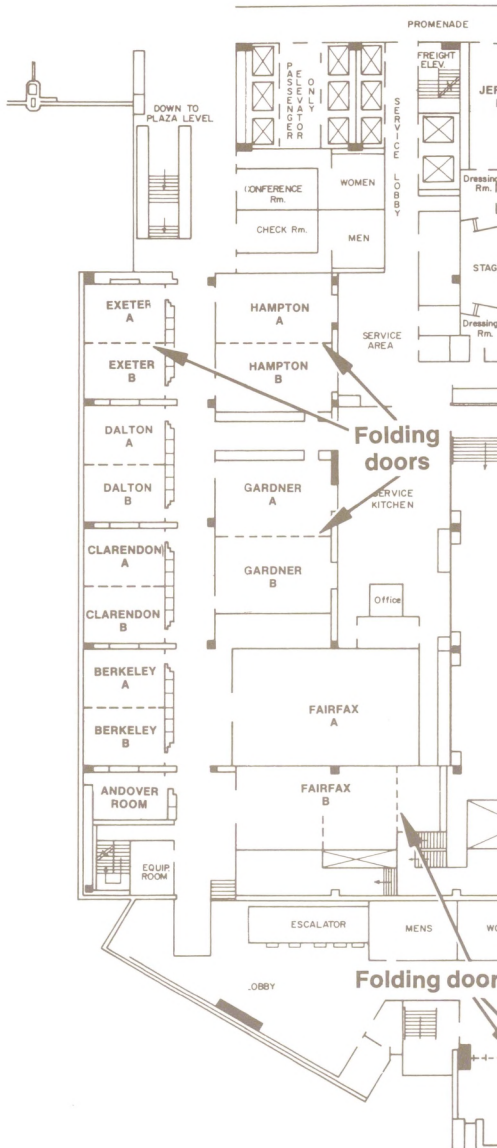

SCALE:

Third Floor

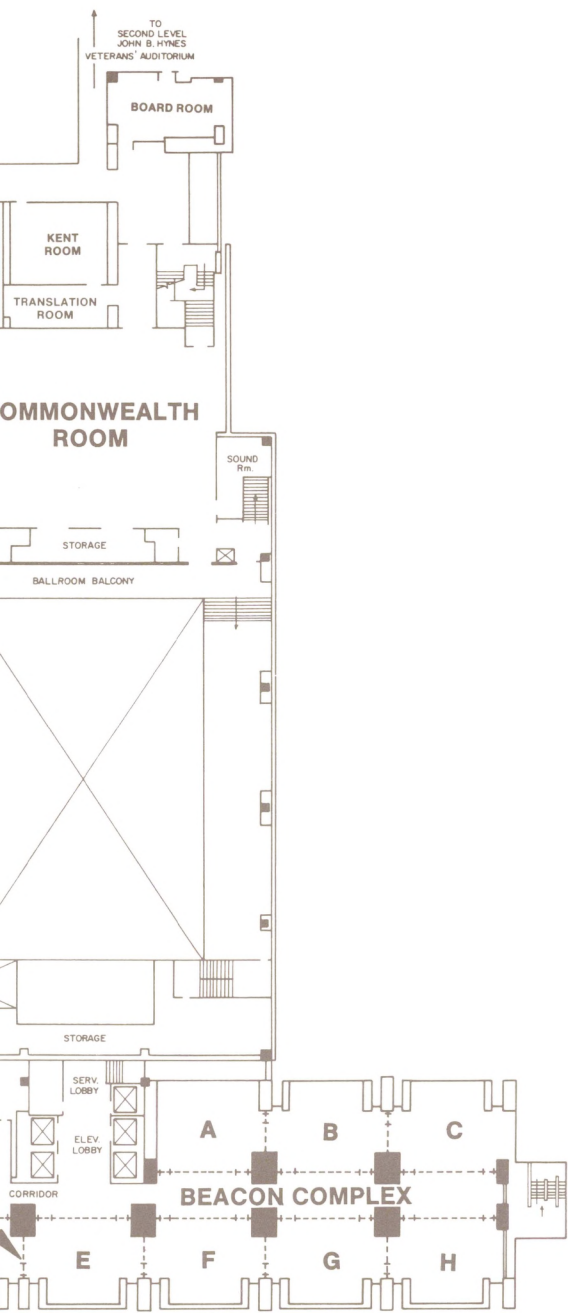

## Park Plaza

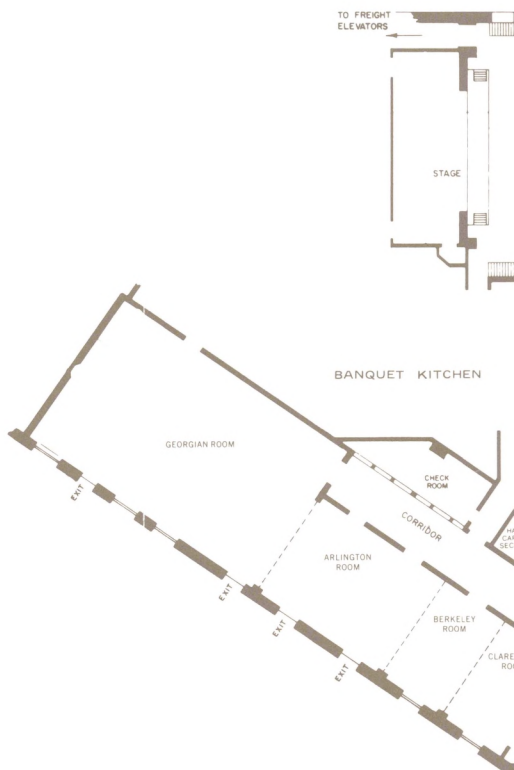

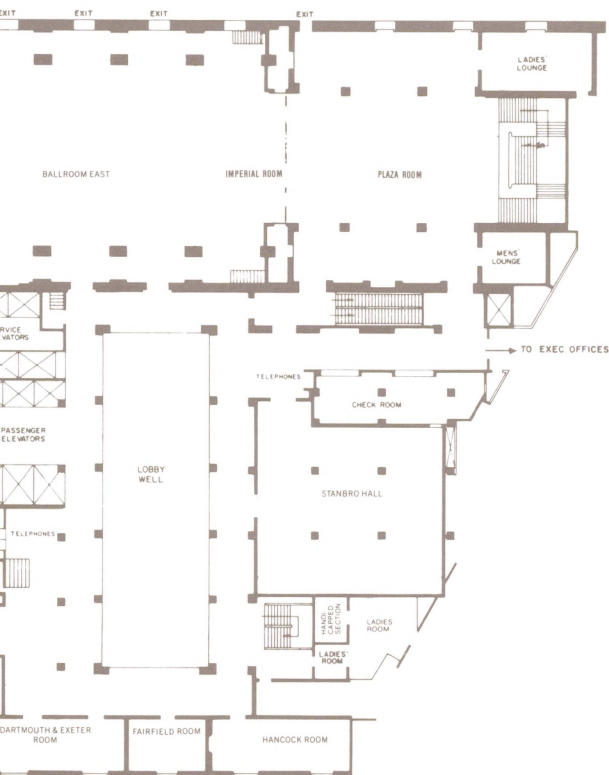

## Marriott Long Wharf



MAIN BALLROOM (Lower Level)

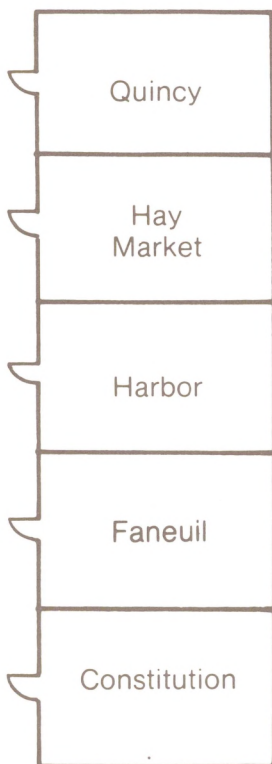
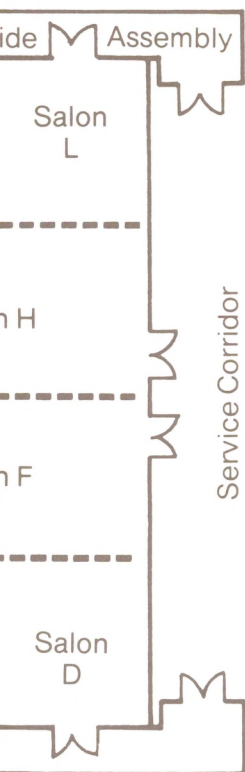

CONFERENCE  
ROOMS  
(1st Floor)



## Copley Plaza

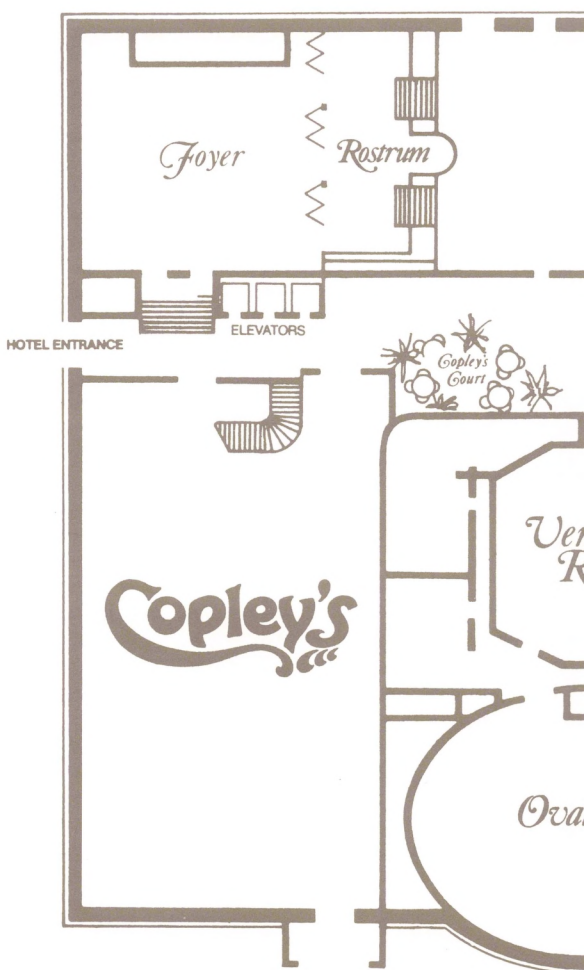

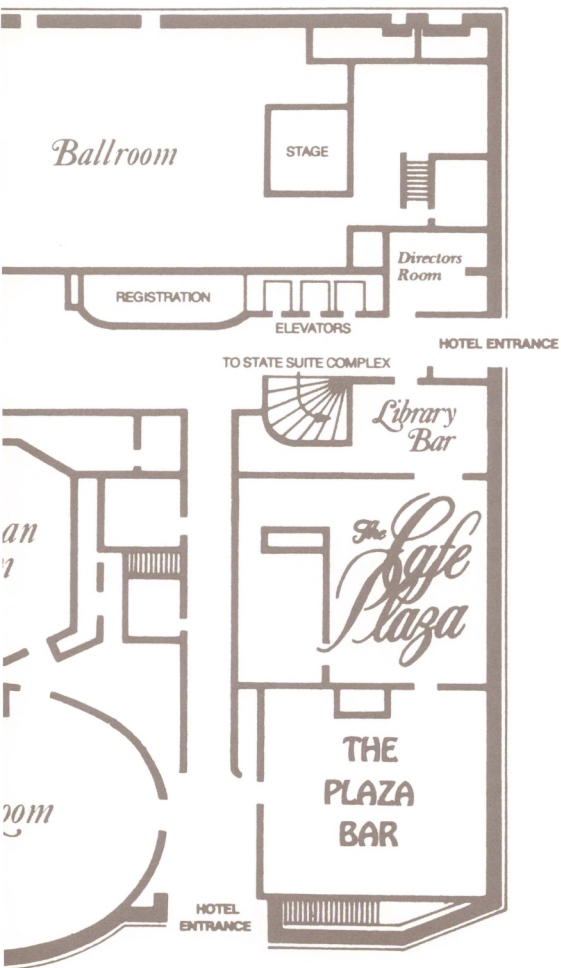

## General Information

## ■ AUDIO/VISUAL FACILITIES

### AUDIO/VISUAL HEADQUARTERS

The Audio/Visual Headquarters, located in the Dalton Room of the Sheraton-Boston, provides general audio/visual assistance, including slide carousels, blank slides, and reservations for the Attendee Preview Room. The Headquarters is open 9 a.m. to 10 p.m. on Sunday, 8 a.m. to 7 p.m. on Monday through Thursday, and 8 a.m. to 5 p.m. on Friday.

### ATTENDEE PREVIEW ROOM

The Attendee Preview Room is located in the Clarendon Room of Sheraton-Boston and is available to attendees for sharing their work informally with small groups. The Preview Room is equipped for 3/4" U-MATIC video playback and 16 mm sound film projection. The Preview Room may be reserved by contacting the A/V Headquarters.

### SPEAKERS' PREP ROOMS

A number of Speakers' Prep Rooms are available. Facilities are provided in each Prep Room for 3/4" U-MATIC video tape cue-up, 35 mm slide organization, and rehearsal. In addition, 3/4" U-MATIC video tape dubbing is available in the Speakers' Prep Room in the Sheraton-Boston.

Please note that a limited number of slide carousels are available at each location. Therefore, if sufficient time is available or if several slide carousels are required, please check them out from the Audio/Visual Headquarters.

SHERATON-BOSTON - Gardner Room  
(3rd Floor)

OPEN:

Sunday, 10 a.m. - 10 p.m.

Monday through Thursday, 8 a.m. - 7 p.m.

Friday, 8 a.m. - 2 p.m.

## General Information

COPLEY PLAZA - Directors Room (Lobby)  
OPEN:

Monday and Tuesday, 8 a.m. - 5:30 p.m.

PARK PLAZA - Dartmouth-Exeter Room  
(Mezzanine)

OPEN:

Monday and Tuesday, 8 a.m. - 5:30 p.m.

MERIDIEN - Palmer Room (Lobby Level)

OPEN:

Monday and Tuesday, 8 a.m. - 5:30 p.m.

MARRIOTT - Faneuil Room (1st Floor)

OPEN:

Monday and Tuesday, 8 a.m. - 5:30 p.m.

### ■ CHILD CARE

Child care information is available at the Information Center in the Hynes Auditorium conference registration area.

### ■ DRESS

Casual dress is acceptable at all SIGGRAPH '82 meetings and events. For dining out in Boston, casual dress is accepted in many dining establishments; however, jackets and ties are required in some locations. The conference committee recommends guests check dress code requirements when restaurant reservations are entered.

### ■ FIRST AID

A registered nurse is on duty Saturday, Sunday, and Monday from 8 a.m. to 5 p.m., Tuesday and Wednesday from 9 a.m. to 6 p.m., and Thursday and Friday from 9 a.m. to 5 p.m. The first aid room is located on the first floor of Hynes Auditorium, on the left as you enter the exhibition area, immediately after the rest rooms and adjacent to the Auditorium Commission Office.

## ■ HOTELS

### **BOSTON MARRIOTT HOTEL LONG WHARF**

296 State Street  
617 227-0800

### **THE BOSTON PARK PLAZA HOTEL & TOWERS**

Arlington Street at Park Plaza  
617 426-2000

### **THE COLONNADE HOTEL**

120 Huntington Avenue  
617 424-7000

### **THE COPLEY PLAZA**

Copley Square  
617 267-5300

### **COPLEY SQUARE HOTEL**

47 Huntington Avenue at Exeter  
617 536-9000

### **57 PARK PLAZA HOTEL**

Howard Johnson Motor Lodge  
200 Stuart Street, "57" Building  
617 482-1800

### **HOTEL MERIDIEN**

250 Franklin Street  
617 451-1900

### **JOHN B. HYNES VETERANS AUDITORIUM**

900 Boylston Street  
617 262-8000

### **THE LENOX HOTEL**

710 Boylston Street  
617 536-5300

### **THE MIDTOWN HOTEL**

220 Huntington Avenue  
617 262-1000

### **PARKER HOUSE**

Tremont and School Streets  
617 227-8600



## General Information

### **SHERATON-BOSTON HOTEL**

Prudential Center

617 236-2000

The Sheraton-Boston Hotel connects with the Hynes Auditorium. During hours when exhibits are open, conference attendees may enter the second level of Hynes Auditorium through an entrance on the third level of the Sheraton-Boston Hotel.

### ■ **HOUSING ASSISTANCE**

A representative from the Greater Boston Convention and Tourist Bureau will be available at the housing desk in the Hynes Auditorium during registration hours on Monday and Tuesday to advise registrants regarding available accommodations in Boston.

### ■ **INFORMATION CENTER**

A conference Information Center located in the conference registration area at Hynes Auditorium is open to assist SIGGRAPH '82 guests beginning 1:00 p.m. on Sunday, July 25, and thereafter during official registration hours.

### ■ **LUGGAGE CHECK AREA**

A Check Room area is provided in Hynes Auditorium for the convenience of SIGGRAPH '82 guests departing directly for the airport from the conference.

### ■ **MERCHANDISE SALES**

A special desk is provided in the Hynes Auditorium registration area for the sale of SIGGRAPH '82 T-shirts, extra reception tickets, extra copies of the conference proceedings, course notes, and art show catalogs. This desk will be open beginning at 1:00 p.m. on Sunday, July 25, and thereafter during regular registration hours.

## ■ MESSAGE CENTER

A Message Center for SIGGRAPH '82 attendees is located in the conference registration area at Hynes Auditorium. The Message Center telephone number is: 617 262-8100

Message Center personnel also will accept personal messages from one conference participant to another. The Message Center is open 8 a.m. to 6 p.m. Monday through Thursday, and 8 a.m. until 3 p.m. on Friday.

## ■ PRESS BRIEFING

A press briefing is scheduled on Tuesday beginning with a continental breakfast at 8:30 a.m. in the Fairfax Room. SIGGRAPH '82 officials will provide a conference overview and escort press representatives on an early walk-through of the exhibition.

## ■ PRESS ROOM

The Sheraton-Boston's Exeter Room is the base for all SIGGRAPH '82 press operations including press registrations. The Press Room is staffed to serve press representatives 3 p.m. to 8 p.m. on Sunday, 8 a.m. to 6 p.m. on Monday through Thursday and 8 a.m. to noon on Friday.

## ■ REGISTRATION

Course participants who registered in advance may pick up registration materials at the conference registration area in the Hynes Auditorium prior to the day of their first scheduled course. Course registration materials not claimed at Hynes Auditorium are available for pickup at the course location beginning 7 a.m. on the course date. Registration materials for courses scheduled at the Sheraton-Boston Hotel will remain available for pickup at the conference registration area in the Hynes Auditorium. This applies to advance registrants only.

## General Information

All new registrations for courses, the technical program, and/or the exhibition must be handled at the conference registration area in Hynes Auditorium.

Registration hours are:

SUNDAY,	July 25	1 p.m. - 9 p.m.
MONDAY,	July 26	7 a.m. - 5 p.m.
TUESDAY,	July 27	7 a.m. - 8 p.m.
WEDNESDAY,	July 28	8 a.m. - 5 p.m.
THURSDAY,	July 29	8 a.m. - 5 p.m.
FRIDAY,	July 30	8 a.m. - 11 a.m.

All press registrations are handled in the Press Room in the Exeter Room of the Sheraton-Boston Hotel.

### ■ SIGHT SEEING

Guidance on things to do and see in historic Boston is available at the Information Center in the Hynes Auditorium conference registration area.

### ■ TELEPHONES

#### **A/V HEADQUARTERS**

Sheraton-Boston Hotel  
Dalton A/B  
617 236-2000, ext. 4185 and 4186

#### **CONFERENCE OFFICE**

Sheraton-Boston Hotel  
Hampton A/B  
617 236-2000, ext. 4196 and 4197

#### **EMERGENCIES (AMBULANCE, FIRE, POLICE)**

911 or dial 0 for switchboard operator in your hotel.

#### **EXHIBIT OFFICE**

Hynes Auditorium  
1st Level, Management Offices  
617 262-8104

**FIRST AID**

Hynes Auditorium  
617 262-8107

**INFORMATION CENTER**

Hynes Auditorium  
Conference registration area  
617 262-8102

**JOHN B. HYNES VETERANS AUDITORIUM**

Main switchboard  
617 262-8000

**MASSACHUSETTS BAY  
TRANSPORTATION AUTHORITY**

617 722-5000

**MESSAGE CENTER**

Hynes Auditorium  
Conference registration area  
617 262-8100

**PRESS ROOM**

Sheraton-Boston Hotel  
Exeter A/B  
617 236-2000, ext. 4183 and 4184

**REGISTRATION AREA**

Hynes Auditorium  
Conference registration area  
617 262-8106

## General Information

### ■ TRANSPORTATION

Complimentary shuttle bus service is provided throughout the conference for SIGGRAPH '82 attendees. On Monday and Tuesday evenings and during peak transportation hours on Wednesday, Thursday, and Friday, the buses will run directly between the following hotels and the Hynes Auditorium:

**ROUTE 1** - Boston Marriott Hotel Long Wharf  
Hotel Meridien

**ROUTE 2** - Boston Park Plaza Hotel

**ROUTE 3** - Copley Plaza Hotel

At all other times the buses operate on a shuttle route stopping at each of the following locations:

Boston Marriott Hotel Long Wharf  
Hotel Meridien  
Boston Park Plaza Hotel  
Copley Plaza Hotel  
Colonnade Hotel  
Sheraton-Boston Hotel  
Hynes Auditorium

Most of the other hotels are within walking distance of a hotel where the shuttle will stop. For Parker House guests, a special mini bus provides transportation to the Boston Park Plaza, and the shuttle buses can be taken from there.

Bus service is provided during the following hours:

SUNDAY,	July 25	1:00 p.m. - 9:30 p.m.
MONDAY,	July 26	7:00 a.m. - 11:00 p.m.
TUESDAY,	July 27	7:00 a.m. - 11:00 p.m.
WEDNESDAY,	July 28	7:00 a.m. - 11:00 p.m.
THURSDAY,	July 29	7:00 a.m. - 11:00 p.m.
FRIDAY,	July 30	7:00 a.m. - 4:00 p.m.

Full details on pickup locations and schedules are given on signs in each hotel lobby.



**SIGGRAPH '83**



## **'83 Call for Participation**

**Tenth Annual Conference on Computer  
Graphics and Interactive Techniques  
July 25-29, 1983  
Detroit, Michigan**

Sponsored by the Association for Computing Machinery Special Interest Group on Computer Graphics, in cooperation with the IEEE Technical Committee on Computer Graphics, Eurographics, and the Engineering Society of Detroit.

### **CONFERENCE INFORMATION**

SIGGRAPH '83 Conference Office  
111 East Wacker Drive  
Chicago Illinois 60601  
(312) 644-6610  
Telex: 25-4073 SBA

### **THE CONFERENCE**

SIGGRAPH '83 will be the tenth annual conference of ACM's Special Interest Group on Computer Graphics. In these ten years, the conference has grown from a small group of graphics experts meeting in a university residence to one of the largest technical conferences in the country. The conference now boasts an extensive exhibit of computer equipment (200,000 sq. feet have been booked in Cobo Hall for this year's show) and two evenings of outstanding films and videotapes produced with the aid of computer graphics. A comprehensive set of courses precedes the conference.

A consistent feature of the conference has been the technical program. SIGGRAPH conferences have been fortunate to be able to present papers detailing the most recent developments in graphics software, hardware, and interaction techniques. Each year the proceedings become a standard reference.

## **PAPERS**

SIGGRAPH '83 invites the submission of previously unpublished papers in all areas of computer graphics and interactive techniques. Appropriate topics include display techniques, graphics software systems and languages, graphics hardware, interactive techniques, and any applications of graphics. Feel free to call or write the Technical Program Office to discuss the appropriateness of any intended submission. A more detailed "Guide to Authors" is available from the Program Office.

Video or film material that is an integral component of the work must accompany the paper.

Papers accepted will be published in the Conference Proceedings, a special issue of Computer Graphics. The video portion of accepted papers will be published in the SIGGRAPH Video Review.

All submissions should conform to CACM publications standards (published in the Summer of 1982). It is strongly recommended that papers not exceed 5000 words. Five copies of each submitted paper should be sent to the Technical Program Chairman by December 1, 1982. Papers must include a 100 to 300 word abstract. Acceptance notification will be made by March 14, 1983 and final papers are due on May 2, 1983.

## **PANELS**

Panel proposals should include a description of the topic issues (for publication in the proceedings) and the names of at least three suggested panelists.

Send two copies of panel proposals to the Panels Chairman by February 14, 1983. Acceptance notification will be made by March 14, 1983.

## '83 Call for Participation

### FILM, VIDEO, ART, COVER DESIGN AND INSTALLATIONS

Late in 1982, a separate Call for Participation inviting submissions of films, videotapes, art work, and installations will be available from the Technical Program Office. The submission deadline for film and video is June 24, 1983. There will be an April 1, 1983 deadline for submissions of installation demonstration proposals and for photographs or slides of drawings, graphics art, sculpture or murals for the proceedings cover and the art show.

### TECHNICAL SESSION CHAIRMAN

Peter Tanner  
SIGGRAPH '83 Technical Program Office  
Division of Electrical Engineering  
National Research Council  
Ottawa, Ontario, Canada  
K1A 0R8  
(613) 741-1007  
Telex: 053-4134 (NRC DEE)

### PANELS CHAIRMAN

Ron Baecker  
Human Computing Resources Corporation  
10 St. Mary Street  
Toronto, Ontario  
M4Y 1P9  
(416) 922-1937

### TECHNICAL PROGRAM COMMITTEE

Peter Tanner - Technical Sessions Chairman  
Ron Baecker - Panels Chairman

Daniel Bergeron	Herbert Freeman
Ingrid Carlbom	Robert Hopgood
Edwin Catmull	James Michener
Hank Christiansen	Bary Pollack
James Clark	Richard Riesenfeld
Sheila Crossey	Maureen Stone
John Dill	Turner Whitted
Alain Fournier	



# **SIGGRAPH '82**

**The Ninth Annual Conference  
on Computer Graphics and  
Interactive Techniques**

**Sponsored by The Association for  
Computing Machinery Special Interest  
Group on Computer Graphics**